

# ILLINOIS HIGH SCHOOL THEATRE FESTIVAL

JANUARY 12-14, 2023 \* HOSTED AT THE UNIVERSITY OF ILLINOIS URBANA-CHAMPAIGN

ARE YOU  
*Living* OR JUST  
EXISTING?



2023

FESTIVAL PROGRAM

Illinois  
**Theatre**  
Association

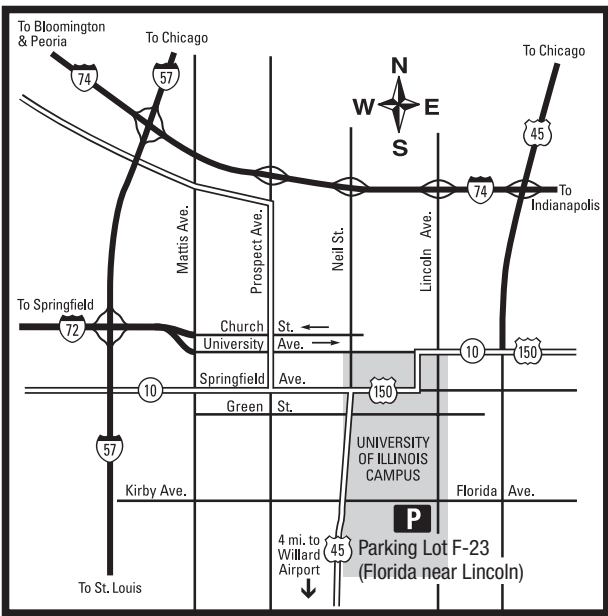

APPROXIMATE SCALE IN FEET FOR MAP BELOW



Urbana is east, Champaign is west of Wright Street

= eatery

Theatres located in KCPA:  
**Foellinger Great Hall**  
**Colwell Playhouse**  
**Tryon Festival Theatre**  
**Studio Theatre**

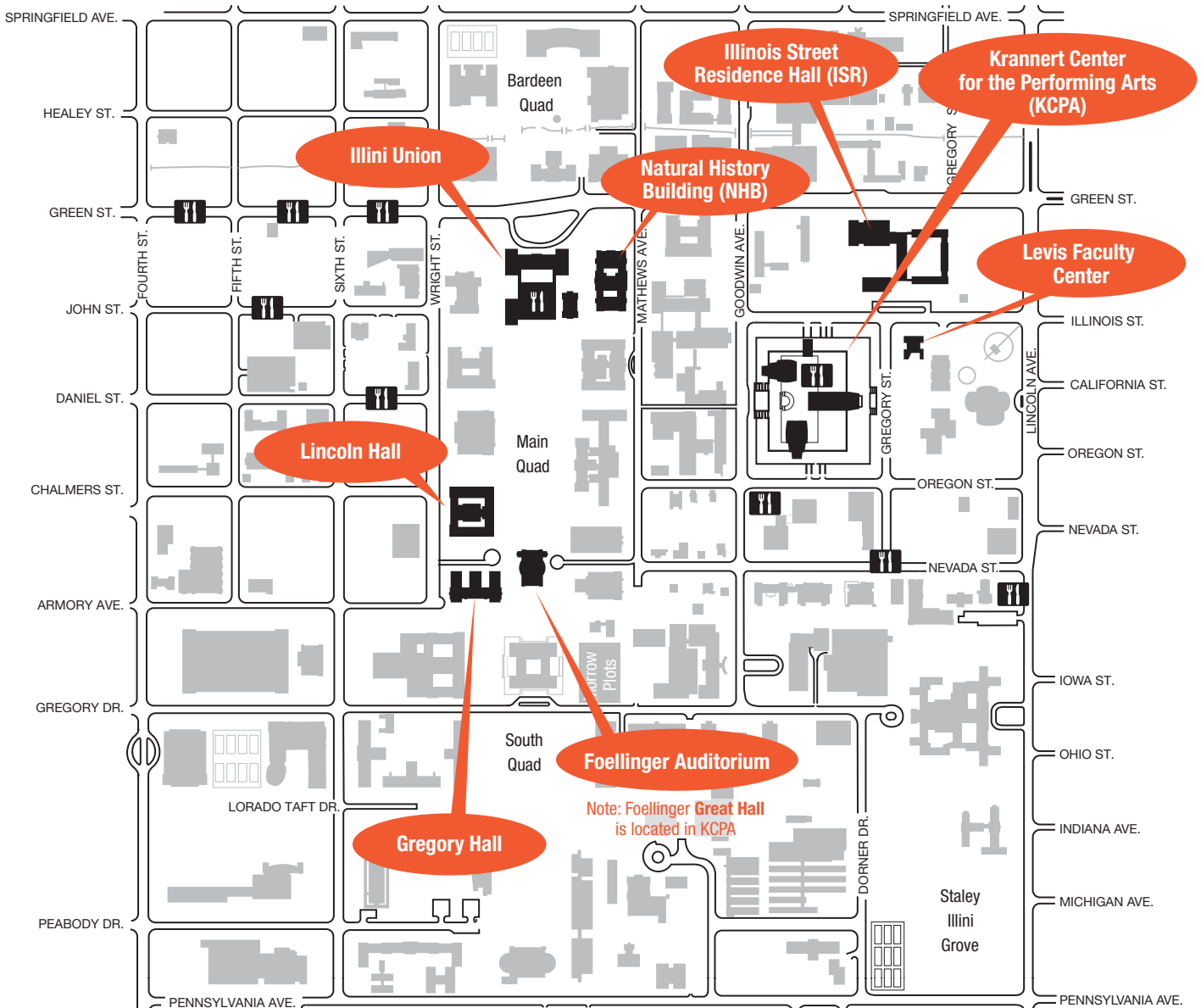

# Contents

|  |    |
|--|----|
| Campus Map . . . . .   | 2  |
| General Information . . . . .  | 3  |
| Parking on Campus . . . . .  | 5  |
| Festival Objectives . . . . .  | 5  |
| Welcome from the IHSTF Executive Director . . . . .                              | 6  |
| Participation Guidelines . . . . .   | 8  |
| COVID-19 Information . . . . .   | 9  |
| 2023 Festival Planning Committee . . . . .                                       | 9  |
| Participating Schools . . . . .  | 10 |
| Production Respondents . . . . .   | 12 |
| IHSTF 2023 Exhibitors . . . . .  | 12 |
| Workshop Presenters . . . . .  | 13 |
| The 2023 Illinois High School Theatre Festival All-State<br>Production . . . . . | 15 |
| Festival at a Glance . . . . .   | 18 |
| Thursday Opening Ceremony & Performance . . . . .                                | 26 |
| College Auditions and Interviews . . . . .                                       | 27 |
| Friday Evening Activities . . . . .  | 28 |
| Production Descriptions . . . . .  | 29 |
| Workshop Descriptions . . . . .  | 33 |
| Friday . . . . .   | 33 |
| Saturday . . . . .   | 43 |
| Profiles of Schools Presenting Productions . . . . .                             | 50 |
| Workshops Recommended for Teachers and Sponsors . . . . .                        | 51 |
| Hospitality Room . . . . .   | 52 |
| CPDU Information . . . . .   | 52 |
| Acknowledgments . . . . .  | 53 |
| Illinois Theatre Association’s Corporate Sponsors . . . . .                      | 54 |
| Plan Your Festival Schedule . . . . .  | 71 |
| Illini Union Maps . . . . .  | 72 |
| Krannert Center for the Performing Arts Maps . . . . .                           | 74 |
| Commonly Used Acronyms and Category Codes . . . . .                              | 77 |

# General Information

## We Have Our Own App!



In an effort to be as green as possible, the IHSTF has an app for all Apple and Android devices! Descriptions of all workshops and productions can be found on the app or can be printed from the **Festival website** (<https://illinoistheatrefest.org>). Additionally, the app has a schedule creator, instant updates as the Festival progresses, easy ways to connect with other attendees at the Festival, and much more! **EVERYTHING YOU NEED IN ONE APP!**

Go to the Apple App Store or Google Play Store and search for “Illinois High School Theatre Festival” to download the app today.

## Krannert Center Lobby (Level 5)

### Festival Headquarters

Contact Headquarters at **217-244-8174**.

Throughout the Festival, information, maps, answers to questions, etc., may be obtained at Festival Headquarters, located in the KCPA Level 5 at these locations during these hours: Thursday, 4:00 pm–8:30 pm (Studio Theatre); Friday, 8:00 am–10:00 pm (Foellinger Great Hall Entrance); and Saturday, 9:00 am–3:00 pm (Foellinger Great Hall Entrance).

The following are located on **Level 5/Lobby Level/Main Level**: Foellinger Great Hall, Colwell Playhouse, Tryon Festival Theatre, Studio Theatre, Krannert Room (Hospitality Room for Teacher/Sponsors).

### Also In Krannert Center Lobby

- **Exhibitors:** 55 colleges, universities, conservatories, and vendors
- **FESTGEAR** (T-shirts, hoodies, vinyl stickers, etc.)
- **Swap Desk** for performance tickets (Friday and Saturday only)
- **Social Media Wall** featuring a slide show of high school theatre productions from across the state (Sponsored by Hoffman Estates High School)
- **Hospitality Room** for Sponsors/Faculty, located in Krannert Room at far south end of KCPA lobby (Sponsored by On the Stage)
- **First Aid** (KCPA Patron Services Office)

### Find the Festival on:



[instagram.com/ihstf](https://www.instagram.com/ihstf)



[facebook.com/  
IllinoisHighSchoolTheatreFestival](https://www.facebook.com/IllinoisHighSchoolTheatreFestival)

## Krannert Center Levels 2, 3, 4

(See maps on pages 71-72)

### Level 2

The following rooms are located on Level 2:

Choral Rehearsal Room, Drama Rehearsal Room, Orchestra Rehearsal Room, Foellinger Great Hall **stage**, Scene Shop, Prop Shop, Studio Dressing Rooms

### Level 3

The following rooms are located on Level 3:

AV Room, Studio 1, Studio 2

To get to Level 3, go down the south stairs from the lobby, on the house right side of the Great Hall; or, from Level 2, go up the south stairs near the Audio Office.

### Level 4

The following rooms are located on Level 4:

Ensemble A & B

To get to Level 4, go down the north stairs from the lobby, on the house left side of the Great Hall, go down to level 2. From level 2, go down second street and take a left passing Drama Rehearsal and Dance Rehearsal Rooms. You will then go up a flight of stairs to level 4.

## Admission to Activities

All Festival registrants must have a ticket and name badge to attend Full-Length, Showcase, Opening and All-State performances. Workshops are not ticketed, but name badges must be worn at all times or you will be asked to leave. Some workshops may fill to capacity and participants may be turned away. It is wise to have a backup workshop in mind just in case. Students **MUST** wear their name badge to be allowed entrance to Friday evening activities.

## Lost Badges

Name badges must be worn at all times. Replacement badges may be purchased at Festival Headquarters for \$3 each.

## Swap Desk for Performance Tickets

Located in the KCPA Lobby (in the corridor next to Foellinger Great Hall), the Swap Desk will be open at 8:00 am-8:00 pm on Friday and 9:00-11:30 am on Saturday. Participants may trade any valid ticket for any available ticket. Students may not swap All-State tickets. In the event that Full-Length or Showcase tickets are still available 15 minutes before the beginning of a performance, remaining tickets (if any) will be distributed without the necessity of a trade.

## Locations Across Campus

The Festival uses many buildings across campus. See the inside front cover for a campus map. All buildings are within relatively short walking distance from one another.

## Directions from the Krannert Center to...

- **Lincoln Hall, Gregory Hall, Foellinger Auditorium, Illini Union, and Natural History Building:** Exit the west lobby doors (on either side of the KCPA Ticket Office) and cross Goodwin Ave. to the walkway between the two science buildings. Continue straight ahead until you reach the Main Quad. At the far south end of the Main Quad (to your left) is Foellinger Auditorium (the building with the dome). The building on the left (east) of Foellinger is Smith Memorial Hall. The building on the right (west) of Foellinger is Gregory Hall. At the far north end of the Main Quad (to your right) is the Illini Union. Natural History Building is located to the right (east) of the Illini Union.
- **Levis Faculty Center:** Exit the east lobby doors (on either side of Foellinger Great Hall). Levis Center is the dark brown building right across the street.
- **Illinois Street Residence Hall (includes ISR Dining Center):** Exit the east lobby doors (on either side of Foellinger Great Hall) and turn left. ISR is the 12-story building right across Illinois St.

## Meal Cards

For those who have purchased a meal card, you can use it at **ISR Dining Center** on Friday, January 13 and Saturday, January 14 from 11:00 am-2:00 pm. The \$23.00 meal card is good for all-you-care-to-eat, cafeteria style dining. A wide variety of selections are available including vegetarian, vegan, and gluten-free options. **THE MEAL CARD IS ONLY GOOD AT ISR DINING CENTER!**

## On-Campus Dining

Intermezzo Cafe, located in the KCPA Lobby (Level 5), is operating on a more limited scale than usual and will be offering sandwiches, wraps, and other grab-and-go items (no hot food).

There are several eateries located on the block just south of KCPA, including Dubai Grill, KoFusion, Subway, Rosati's Pizza, Basil Thai, Caffé Bene, Bab Plus, Tenko Tea, and BBQ Chicken. Other nearby eateries include Jimmy Johns and Caffé Paradiso (southeast of KCPA on Lincoln Ave.), plus Manolo's Pizza and Empanadas, Espresso Royale, The Bread Company, and Timpone's (just across Oregon St. at Goodwin Ave.).

Eateries in the Illini Union are also options for on-campus dining. On the main level (1st Floor), you can find Starbucks, Just Bee Açai, Tropical Smoothie Cafe, and Quad Shop. Quad Shop sells grab-and-go snacks, Illini merchandise, toiletries, and bottled and fountain soft drinks. On the Lower Level, you can find Einstein Bros. Bagels and several vending machines.

Additionally, you may find some food trucks stationed in various places around campus. Their hours vary.



# Parking on Campus

As a general rule, please follow all University parking signs and permits very carefully, and make sure this information is passed on to all drivers. **Neither the Festival nor the University will pay for parking tickets/fines.**

**Buses/Trucks:** If the vehicle cannot fit in a single, regular parking space, it will need to be parked in Lot F23 (on Florida Ave. near Lincoln Ave.). *There is no room near the Krannert Center for parking large vehicles. Drivers should pick up and drop off students at streets adjacent to KCPA, but vehicles must be parked off-campus or in Lot F23.*

Buses/trucks may park in Lot F23 after 4:00 pm on Thursday and anytime on Friday and Saturday.

**Cars/Vans:** On Thursday before 4:00 pm, limited parking is available for \$1.25/hour on the streets surrounding KCPA, in Lot D5 (KCPA garage), in Lot D9 (east of Illinois Street Residence Hall) and in Lot D22 (south of Levis Faculty Center). The University is in the process of removing its standard parking meters, so you may need to pay by app\* as opposed to using quarters. Many parking spots are free in the evening, but check the spot's sign to be sure.

Parking restrictions on Friday are essentially the same as Thursday. On Saturday, University-owned parking lots around KCPA are available at no cost all day. Some parking spots do charge on Saturdays, so be sure to check the signage.

This event is produced by the



This program is partially funded by a grant from the Illinois Arts Council, a state agency.



Copyrights: The Board of the Illinois Theatre Association does not support nor condone the violation of U.S. copyright laws in regard to photocopying, electronic reproduction, or recording of copyright-covered materials.

## \*Parking Apps:

- **MobileMeter:** <https://mobilemeter.us>
- **ParkMobile:** <https://parkmobile.io>
- **PayByPhone:** <https://www.paybyphone.com>  
Or dial 217-207-3033 to pay over the phone

# Festival Objectives

## I. To enrich the education of high school students by:

- Helping students realize through this experience that theatre is one means of fulfilling each individual's innate need and desire to create.
- Bringing diverse young people together in an environment of creative and imaginative stimuli where theatre can be witnessed, experienced, talked about, and lived.
- Providing experiences in which each student can recognize and share common ambitions, goals and interests with other students from diverse communities and programs.
- Allowing students to witness different types and styles of theatre processes and performance.

- Providing opportunities for students to showcase their creative efforts.

## II. To serve teachers, directors, and theatre sponsors by:

- Demonstrating specific educational theatre materials and techniques.
- Providing exposure to various program sizes and alternative approaches for theatre programs.
- Providing a showcase for accomplishments of student groups.
- Developing a forum and network for the exchange and sharing of ideas to build and expand theatre programs.

Students, please go to <https://illinoistheatrefest.org> to provide feedback on this year's Festival.

# Welcome from the IHSTF Executive Director



January 12, 2023

What a joy it is to welcome you all to the 47th Annual Illinois High School Theatre Festival, hosted at the University of Illinois Urbana-Champaign. Ever since my first time attending Festival as a student way back before most of you were born, I have wanted to be a part of this legacy...and here we are.

I would be remiss if I didn't acknowledge and applaud the past two years of Festival organizers, planners, hoppers, and dreamers. These folks worked tirelessly to shape a space for theatre-goers to build a culture of wonder and ambition. The Executive Director for 2021 and 2022, Judy Klingner, was able to keep the dream alive through a number of virtual events. I applaud her for taking the helm and leading us through the darkness.

Her theme, ***In the Theatre ALL are Welcome***, resonates with me still to this day as EVERYONE deserves a seat at the table...and a spot on the stage. The Festival was, is, and will continue to be a culture of acceptance, support, and hope as we continue to assemble a safe space for everyone to feel at home and welcome at this Festival.

Our theme, ***Are You Living or Just Existing?***, was one of those random statements that I have carried through my life for the past 20 years. It challenges me to step outside my comfort zone and become someone I have always wanted to be; to not only think outside the box but think as if the box never existed--without limitations. I ask and challenge you to do the same as you embark on this Festival journey with me.

So...here we go! Take a chance--go to a workshop that is different for you; meet folks from other schools; make connections and build your theatre family into an even stronger group. Share your experiences when you go back to your schools so others after you will join us and continue their own journey at the Illinois High School Theatre Festival.

Sincerely,

Ryan Lambert  
2023 IHSTF Executive Director



**Office of the Chancellor**  
517 Swanlund Administration Building, MC 304  
601 E. John St.  
Champaign, IL 61820

January 12, 2023

Dear Students and Educators,

It is a special pleasure to welcome the Illinois High School Theatre Festival back to the University of Illinois Urbana-Champaign. It has always been exciting to see our university transformed by this showcase of the finest theatrical talent our state students have to offer. But this return to our university is particularly special coming out of the disruptions of the COVID-19 pandemic.



One of the things we learned almost immediately in the early days of the pandemic shutdowns and cancellations was just how very much we all missed the simple celebrations of being together for those shared moments in time. These are experiences that are just not the same if "you weren't there." And while we learned that we could still study and work virtually, separated by plastic partitions or standing six feet apart – we also gained a new understanding of how much our human spirit is fed by music, dance and live performances.

We've always known that every moment of every performance is a once-in-a-lifetime event that comes alive through a singular intersection of cast, crew and audience.

But this year, we truly understand how much we need live theatre. And how much we have missed you.

Welcome back and break a leg!

Sincerely,

Robert J. Jones  
Chancellor  
University of Illinois Urbana-Champaign

As a land-grant institution, the University of Illinois Urbana-Champaign has a responsibility to acknowledge the historical context in which it exists. We are currently on the lands of the Peoria, Kaskaskia, Peankashaw, Wea, Miami, Mascoutin, Odawa, Sauk, Mesquaki, Kickapoo, Potawatomi, Ojibwe, and Chickasaw Nations. It is necessary for us to acknowledge these Native Nations and for us to work with them as we move forward as an institution with Native peoples at the core of our efforts.

# Participation Guidelines

- Festival participants are expected to attend and be a part of Festival-sponsored activities and performances.
- Take full advantage of the Festival by arriving on time for workshops and performances. Tickets for performances are valid only until published performance times. At published curtain times, empty seats will be filled by participants who do not have tickets (except for All-State).
- If you, or your school, have performance tickets that you are not going to use or swap, please turn them in to the swap desk at least 30 minutes before curtain time.
- Information about the Ticket Swap Desk for ticket exchange can be found on page 2 of the Festival program. **Under no circumstances shall tickets for any performance be exchanged for money.**
- As an audience member, you are part of the performance, but you are not a performer. Therefore, good manners toward those on stage are extremely important.
- No one may save seats for any performance.
- **No food or drink is allowed in the theatres and workshop spaces, with the exception of bottled water.**
- The use of any audio or video recording device or camera in any theatre is prohibited. This includes cell phones and tablets.
- Please plan to maintain a full schedule for both Friday and Saturday. Get plenty of rest so that you do not find yourself losing interest or energy in the middle of the day. Many professionals and schools have donated time to provide quality workshops and shows. Please show your appreciation by attending every event that you can.
- You must wear your Festival badge to all events, including Friday night activities. On the front, your badge must include your full name and school name, and on the back should appear your sponsor's name and Festival phone contact. Note: A sponsor, monitor, or University staff member has the right to ask to see your badge. Replacement badges must be purchased at Festival headquarters (for \$3) if originals are lost.
- The use of drugs/alcohol during attendance at the Festival is absolutely prohibited. Parents of a student who is found in violation will be contacted and requested to remove the student immediately—no matter what time of the day or night.
- **The University of Illinois Urbana-Champaign is a smoke-free campus. Smoking is prohibited in all University buildings, the Quad, and all other outdoor areas on campus. In addition, students are not allowed to smoke at any of the hotels.**
- **Vaping is also prohibited on campus.**
- Students should travel in groups of at least two and inform their chaperone of their schedule. Emergency phones are located throughout the campus and will connect you to the campus police if needed. (Refer to back of name badge for numbers.)
- Curfew: City ordinance requires that no minor be on the streets without an adult after 11:00 pm on Thursday and 11:59 pm on Friday. In an effort to keep hotel behavior consistent among all schools and to keep the Festival a positive experience for everyone, the Festival has established a housing curfew. All students are expected to be in their rooms and quiet by 12:00 am Thursday and 1:00 am Friday.
- Please remember that you are representatives of your school's theatre program and conduct yourselves accordingly. The Festival is a time to share new ideas and concepts. **It is expected that you will be polite, respectful, and receptive at all performances and workshops.**
- Courteous behavior is also expected at Champaign-Urbana area hotels, restaurants, and stores.
- Participants acknowledge that photos/videos may be taken by authorized individuals and used for educational, instructional, or promotional purposes in any print, broadcast, and/or electronic media formats.
- Sponsors are asked to remind students that any content on social media sites and/or personal blogs/websites shall be appropriate to the IHSTF's mission and purpose, as well as students' roles as representatives of their schools.



## LET'S SET THE PROPER TONE— TURN OFF THE CELL PHONE!

No calls, texting, or posting during performances or workshops! Students found using phones during performances will have their phones confiscated. (Confiscated phones can be picked up at the Festival Headquarters at Krannert.)

**First Aid Services** will be located in the KCPA Patron Services Office on Lobby-Level 5 of the Krannert Center during the hours of the Festival. In other emergencies, please call 911 (or 9-911 from a campus phone).

# COVID-19 Information

The Festival will be following the University of Illinois Urbana-Champaign's Event Guidelines, which are based on current local COVID-19 levels and CDC guidance.

- There are no COVID-19 vaccination/testing requirements for UIUC campus visitors. However, visitors from outside the campus community are encouraged to be fully vaccinated for COVID-19 if they are able to do so.
- Face coverings are not required at UIUC events. Individuals are always welcome to wear a face covering to protect themselves. The Festival is not providing face masks, so participants should bring their own if they wish to wear one.

- There are no social distancing or capacity restrictions at this time.

SHIELD Illinois operates a community testing site at:

Campus Recreation Center East (CRCE)  
1102 W. Gregory Dr.  
Urbana, IL 61801

Campus visitors attending the Festival are welcome to test at this site. Hours and additional info can be found at:

<https://covid19.illinois.edu/community-testing>

## 2023 Festival Planning Committee

### Executive Director (2023)

Ryan Lambert, Farmington Central H.S.

### Executive Director Emeritus (2021-22)

Judy Klingner, William Fremd H.S. (retired)

### Secretary/Executive Director (2024)

Hector Hernandez, Larsen Middle School

### Historian/Documentarian

Vacant

### All-State Director

Michelle DePasquale Bayer, Oak Park and River Forest H.S.

### All-State Producers

Katherine Apperson-Skobel, James B. Conant H.S.

Tom Skobel, Lake Zurich H.S.

### Assoc. Directors: Auditions

Sara Keith, Lake Park H.S.

Ryan Lambert, Farmington Central H.S.

### Assoc. Directors: Box Office & Ticketing

David Zimmerman, Belvidere North H.S.

Wendy Taylor, Belvidere North H.S.

### Assoc. Directors: Statewide Inclusion

Emma Harmon, Lindblom Math and Science Academy

Brian Herman, St. Laurence H.S.

### Assoc. Directors: Exhibits

Jessica Lim, Wheaton North H.S.

Kristin Koski, Moline Sr. H.S.

### Assoc. Directors: Hospitality/Mentors

Mary Bohlander, Resurrection College Prep H.S.

Ashley Melton, Edwardsville H.S.

### Assoc. Directors: Play Selection

Madison Gillis, Glenbard North H.S.

Andrew Rosenblat, Curie Metropolitan H.S.

### Assoc. Directors: Promotions

Stacy Cunningham, Leyden H.S.

LaDonna Wilson, Champaign Central H.S.

### Assoc. Directors: Technology

Christina Ordonez, Hoffman Estates H.S.

Jason Stevens, Hoffman Estates H.S.

### Assoc. Directors: Workshops

Kim Freeman, Streator Township H.S.

Anthony Greer, United Township H.S.

### Illinois Theatre Association

Carmel DeStefano, President

Dennis Anastasopoulos, Reavis H.S. (Treasurer & All-State Liaison)

Michelle DePasquale Bayer, Oak Park and River Forest H.S. (Liaison)



## University of Illinois Urbana-Champaign

### Local Arrangements

Michelle Marquart, Program Coordinator

### Department of Theatre Rep

J.W. Morrissette, Associate Head, Department of Theatre

### Krannert Center for Performing Arts

Andrew Almeter, Senior Production Coordinator

David Krupla, Events Technical Director

Lisa Lillig, Co-Director of Patron Services

Seth Wheeler, Events Technical Coordinator

Lou Williams, Production Coordinator

### Student Coordinators

Jacqueline Moreno, David Stasevsky, Sophia Urban

## Illinois State University

### School of Theatre and Dance Rep

Jimmy Chrismon, Asst. Prof. of Theatre Teacher Education

### Student Coordinators

Cassie Adelman, Markos Carmona, Bebe Marzano, Grey Nielsen

## Participating Schools

**3,745 registered students and sponsors attending from 166 high schools across the state:**

Addison Trail H.S.

Adlai E. Stevenson H.S.

Althoff Catholic H.S.

Alton H.S.

AlWood H.S.

Amos Alonzo Stagg H.S.

Antioch Community H.S.

Auburn Creative Performing Arts  
H.S.

Barrington H.S.

Bartlett H.S.

Batavia H.S.

Belvidere H.S.

Belvidere North H.S.

Bolingbrook H.S.

Buffalo Grove H.S.

Carbondale H.S.

Centennial H.S.

Central H.S. (Burlington)

Central H.S. (Champaign)

Chicago Christian H.S.

Civic Memorial H.S.

Clinton H.S.

Coal City H.S.

Collinsville H.S.

Crystal Lake Central H.S.

Crystal Lake South H.S.

Curie Metro H.S.

CUSD #140-NTA

Deerfield H.S.

De La Salle Institute

DePaul College Prep

Downers Grove North H.S.

Downers Grove South H.S.

Edwardsville H.S.

Effingham H.S.

Elgin H.S.

Elmwood Park H.S.

Farmington Central H.S.

Fenton Community H.S.

Fenwick H.S.

Fieldcrest H.S.

Galena H.S.

Galesburg H.S.

Geneva H.S.

Genoa-Kingston H.S.

Glenbard East H.S.

Glenbard North H.S.

Glenbard South H.S.

Glenbard West H.S.

Grant Community H.S.

Grayslake North H.S.

Guilford H.S.

Hampshire H.S.

Harlem H.S.

Harrisburg H.S.

Harry D. Jacobs H.S.

Heritage H.S.

Herscher H.S.

Heyworth H.S.

Highland Park H.S.

Hinsdale Central H.S.

Hinsdale South H.S.

Hoffman Estates H.S.

Homewood-Flossmoor H.S.

Huntley H.S.

Illinois Valley Central H.S.

James B. Conant H.S.

Jefferson H.S.

Jones College Preparatory H.S.

Kaneland H.S.

Kankakee H.S.

Keith Country Day School

Kelly College Prep

Lake Forest Academy

Lake Forest H.S.



## Participating Schools, continued

Lake Park H.S.  
Lake Zurich H.S.  
Lakes Community H.S.  
Larkin H.S.  
Lemont H.S.  
Leyden H.S.  
Libertyville H.S.  
Lincoln-Way East H.S.  
Lincoln-Way West H.S.  
Lindblom Math & Science Academy  
Lockport Township H.S.  
Loyola Academy  
Lyons Township H.S.  
Mahomet-Seymour H.S.  
Maine East H.S.  
Maine South H.S.  
Maine West H.S.  
Marmion Academy  
Mather H.S.  
Mattoon H.S.  
Minooka Community H.S.  
Moline Sr. H.S.  
Monticello H.S.  
Morton West H.S.  
Mother McAuley H.S.  
Mt. Vernon Township H.S.  
Mt. Zion H.S.  
Naperville Central H.S.  
Naperville North H.S.  
Nazareth Academy  
Neuqua Valley H.S.

Niles North H.S.  
Niles West H.S.  
Normal Community H.S.  
Normal Community West H.S.  
North Boone High School  
North-Grand H.S.  
Northtown Academy H.S.  
Oak Park and River Forest H.S.  
O'Fallon Township H.S.  
Oswego East H.S.  
Palatine H.S.  
Pinckneyville H.S.  
Plano H.S.  
Prairie Ridge H.S.  
Princeton H.S.  
Reavis H.S.  
Resurrection College Prep  
Richwoods H.S.  
Ridgewood Community H.S.  
Rochester H.S.  
Rock Island H.S.  
Rockford East H.S.  
Rolling Meadows H.S.  
Romeoville H.S.  
Rosary H.S.  
Roxana H.S.  
Saint Bede Academy  
Saint Ignatius College Prep  
Salem Community H.S.  
South Elgin H.S.  
St. Charles East H.S.

St. Charles North H.S.  
St. Francis H.S.  
St. Joseph-Ogden H.S.  
Streamwood H.S.  
Streator Township H.S.  
Thornton Fractional North H.S.  
Tinley Park H.S.  
Trinity H.S.  
United Township H.S.  
Univ. of Illinois Laboratory H.S.  
Urbana H.S.  
Valmeyer H.S.  
Victor J. Andrew H.S.  
Warren Township H.S.  
Warsaw H.S.  
Washington Community H.S.  
Wauconda H.S.  
Waukegan H.S.  
West Carroll H.S.  
West Chicago Community H.S.  
Westville H.S.  
Wheaton North H.S.  
William Fremd H.S.  
William Howard Taft H.S.  
Willowbrook H.S.  
Wilmington H.S.  
Woodstock H.S.  
Woodstock North H.S.  
Zion-Benton Township H.S.

**Students, we want your feedback!**  
**Share your thoughts about this year's Festival by visiting**  
**<https://illinoistheatrefest.org> to complete the Festival survey.**



# Production Respondents

Many thanks to all those who volunteered their time responding to productions submitted by schools throughout the state.

Suzanne Aldridge  
Katherine Apperson-Skobel  
Michelle DePasquale Bayer  
Mary Bohlander  
Bill Chamberlain  
Carmel DeStefano

Kim Freeman  
Madison Gillis  
Emma Harmon  
Sara Keith  
Ryan Lambert  
Jessi Lim

Joe Pulio  
Andrew Rosenblat  
Abigail Simaytis  
Andy Simon  
Patrick Spreadbury  
Wendy Taylor

## HSTF 2023 Exhibitors

Visit them in the KCPA lobby (Level 5), 4:00 p.m. Thursday to 3:00 p.m. Saturday.

### Colleges

**AMDA College of the Performing Arts** (New York, NY)

**Ball State University, Department of Theatre and Dance**  
(Muncie, IN)

**Carthage College** (Kenosha, WI)

**Dobbins Conservatory at Southeast Missouri State University** (Cape Girardeau, MO)

**Eastern Illinois University** (Charleston, IL)

**Elmhurst University** (Elmhurst, IL)

**Hussian College** (Los Angeles, CA)

**Illinois State University** (Normal, IL)

**Illinois Wesleyan University** (Bloomington, IL)

**Iowa State University Department of Music and Theatre**  
(Ames, IA)

**Lewis University** (Romeoville, IL)

**Marquette University, Theatre Arts** (Milwaukee, WI)

**Miami University of Ohio** (Oxford, OH)

**Missouri State University** (Springfield, MO)

**Monmouth College** (Monmouth, IL)

**Millikin University** (Decatur, IL)

**New York Film Academy College of Visual and Performing Arts** (New York, NY)

**North Central College** (Naperville, IL)

**North Park University** (Chicago, IL)

**Northern Illinois University—School of Theatre and Dance** (DeKalb, IL)

**Northern Michigan University** (Marquette, MI)

**Paramount School of the Arts** (Aurora, IL)

**Rockford University** (Rockford, IL)

**Southeastern Illinois College** (Harrisburg, IL)

**Southern Illinois University Edwardsville** (Edwardsville, IL)

**Southern Illinois University School of Theater and Dance** (Carbondale IL)

**The New York Conservatory for Dramatic Arts** (New York, NY)

**The Theatre School at DePaul University** (Chicago, IL)

**Truman State University** (Kirksville, MO)

**University of Illinois Chicago** (Chicago, IL)

**University of Illinois Springfield** (Springfield, IL)

**University of Illinois Urbana-Champaign—College of Fine & Applied Arts** (Urbana, IL)  
**Department of Theatre** (Urbana, IL)

**University of Iowa** (Iowa City, IA)

**University of Wisconsin-La Crosse** Department of Theatre and Dance (La Crosse, WI)

**University of Wisconsin-Parkside** (Kenosha, WI)

**University of Wisconsin-Stevens Point** (Stevens Point, WI)

**Vassar College/Powerhouse Theater Program**  
(Poughkeepsie, NY)

**Waldorf University** (Forest City, IA)

**Western Illinois University** (Macomb, IL)

**Western Michigan University** (Kalamazoo, MI)

**Wittenberg University**

### Vendors/Other

**American Performing Arts International** (Pleasant Grove, UT)

**Coal City High School costumes** (Coal City, IL)

**Dramatic Publishing Company** (Woodstock, IL)

**Forte Stage Combat, Inc** (Glen Ellyn, IL)

## IHSTF 2023 Exhibitors, continued

**Grand Stage** (Chicago, IL)

**Intimacy Directors and Coordinators** (Savoy, IL)

**J & S Photo & Printing** (Chicago, IL)

**Jennifer Heim Photography** (Wayne, IL)

**Midwest Event Solutions LLC** (West Chicago, IL)

**Protolight** (Des Plaines, IL)

**Timothy Mooney Repertory Theatre** (Buffalo Grove, IL)

**Vertigo** (Cortland, IL)

## Exhibitors' Passport Raffle

Visit the booths and have your passport stamped, then drop your completed passport at Festival Headquarters (KCPA Lobby) by 5:15 pm on Friday. Visit at least 8 booths for a small prize or 20 for a larger prize. See the back of your passport for a full list of rules.

## Workshop Presenters

Thank you to all our wonderful volunteer workshop leaders. This Festival could not take place without you. Students, be sure to thank them!

Jaclyn Aldridge, Grit Automation, Inc.

Adam Armstrong, Northern Illinois  
First Folio Theatre Ensemble

Isaac Armstrong, Northern Illinois  
First Folio Theatre Ensemble

Josh Armstrong, Northern Illinois First  
Folio Theatre Ensemble

Katie Armstrong, Northern Illinois  
First Folio Theatre Ensemble

Richard Arnold, Jr, College of DuPage  
Frank Bavone, Leyden H.S.

Mark Begovich, West Chicago  
Community H.S.

Lily Blouin, Fighting Measure  
John Boesche, Univ. of Illinois  
Urbana-Champaign

Andrea Bouck, Univ. of Illinois  
Urbana-Champaign

Elizabeth Bowman, Connected Arts  
Network (CAN) Grant & EdTA

Chris Budnick, Victor J. Andrew H.S.

Mark Cabus, Ball State Univ.

Annie Calhoun, Lewis Univ.

Brad Carlson, Truman State Univ.

Vincent Carlson, Univ. of Illinois  
Urbana-Champaign

Markos Carmona, Illinois State Univ.

George Cederquist, North Park Univ.

Jimmy Chrismon, Illinois State Univ.

Gibson Cima, Northern Illinois Univ.

Terri Ciofalo, Univ. of Illinois  
Urbana-Champaign

Karoline Corning, Victor J. Andrew  
H.S.

Larry Cox, Jr., Eastern Illinois Univ.

Jessie Craig, The New York  
Conservatory for Dramatic Arts

Stacy Cunningham, Leyden H.S.

Eric Curtis, Acting Matters

Joel Danowitz, Grit Automation, Inc.

Parker Daugherty, Illinois State Univ.

Patrick Deane, Lockport Township  
H.S.

Carmel DeStefano, Reavis H.S.  
(retired)

Amber Dewey Schultz, Univ. of Illinois  
Urbana-Champaign

Julia Escobedo-Prieto, Northern  
Illinois Univ.

Spencer Ferguson, Illinois State Univ.

Carrie Florczyk, Northern Illinois First  
Folio Theatre Ensemble

Edward Dennis Fogell, Chicago  
Actor's Studio

Jonathan Frank, Chicago Actor's  
Studio

Tim Frawley, Forte Stage Combat, Inc

Ken Frykholm, Lockport Township  
H.S.

Sheila Furey Sullivan, Victor J. Andrew  
H.S.

Christy Furlan, Northern Illinois First  
Folio Theatre Ensemble

Christopher Gadomski, Eastern  
Illinois Univ.

Fr. Dominic Garramone, Saint Bede  
Academy

Marcel Graham, Lake Zurich H.S.

Diana Grisanti, Ball State Univ.

Dilan Gursoy, Illinois State Univ.

Daniel Hall, Southern Illinois Univ.,  
Carbondale

Karen Hall, Maine East H.S.

Sam Harvey, AMDA College of the  
Performing Arts

Sarah Havens, Univ. of Illinois  
Urbana-Champaign

Hannah Haverkamp, Univ. of Illinois  
Urbana-Champaign

Nathaniel Haywood, Downers Grove  
South H.S.

Christine Heckman, Burlington  
Central H.S.

Hector Hernandez, Larsen Middle  
School

Deborah Hill, Ball State Univ.

Matthew Hougland, Carthage  
College

Antonio Houston, Northern Illinois  
Univ.

## Workshop Presenters, continued

Reiko Huffman, Univ. of Illinois  
Urbana-Champaign  
Tatsuya Ito, Univ. of Illinois  
Urbana-Champaign  
Rose Kaczmarowski, Univ. of Illinois  
Urbana-Champaign  
Britnee Kenyon, Deerfield H.S.  
Judy Klingner, IHSTF 2021-22  
Executive Director  
Cynthia Kocher, Univ. of Illinois  
Urbana-Champaign  
Loridon Krug, Chicago Actor's Studio  
Adam Lewis, Western Illinois Univ.  
Jessi Lim, Downers Grove South H.S.  
Vincent Lobello, Purdue Univ.  
JP Lockwood, Illinois State Univ.  
Jaclyn Loewenstein, Class  
Act-Champaign  
Joselyn Ludtke, Connected Arts  
Network (CAN) Grant & EdTA  
Kristen Mackie, Chicago College of  
Performing Arts at Roosevelt Univ.  
Bethany Mangum-Oles, Northern  
Illinois Univ.  
Viana Manova, Univ. of Illinois  
Urbana-Champaign  
Maggie Marlin-Hess, Illinois State  
Univ.  
Mikel Matthews, Rantoul Township  
H.S.  
Martin McClendon, Carthage College  
Amy Lyn McDonald, Elmhurst Univ.  
Rebel Mickelson, Western Illinois  
Univ.  
Maria Miguens, Univ. of Illinois  
Urbana-Champaign  
Adam Miller, Warren Township H.S.  
Mikayla Miracle, College of DuPage  
Jessica Mitilineos, Maine East H.S.

Tim Mooney, Timothy Mooney  
Repertory Theatre  
David Morrison, Bolingbrook H.S.  
Briana Niven, Maine East H.S.  
Tyler Page, Northern Illinois Univ.  
Elizabeth Parks, Univ. of Wisconsin-  
Stevens Point  
Susan Patrick Steinfeldt, Southern  
Illinois Univ., Carbondale  
Ellie Paulsen, Illinois State Univ.  
Bella Pelini, Victor J. Andrew H.S.  
Robert Perry, Univ. of Illinois  
Urbana-Champaign  
Joe Pietrie, St. Charles North H.S.  
Jane Pivovarnik, Southern Illinois  
Univ., Carbondale  
Sissy Anne Quaranta, Univ. of Illinois  
Urbana-Champaign  
Todd Quick, Monmouth College  
Sophie Reidt, Illinois State Univ.  
Leoni Reilly, Univ. of Illinois  
Urbana-Champaign  
Bobby Reynolds, Univ. of Illinois  
Urbana-Champaign  
Matthew Rickey, Victor J. Andrew H.S.  
Brennan Roach, Jones College Prep,  
NHSI (cherubs)  
Laney Rodriguez, Univ. of Illinois  
Urbana-Champaign  
Cody Rogers, Rowe Middle School  
Liam Romano, Univ. of Illinois  
Urbana-Champaign  
Andrew Rosenblat, Curie  
Metropolitan H.S.  
Dan Schmidt, Western Illinois Univ.  
Richard Scholwin, Univ. of Illinois  
Urbana-Champaign  
Ryan Schultz, Univ. of Illinois  
Urbana-Champaign

Danielle Silles, Southern Illinois Univ.,  
Carbondale  
Abigail Simaytis, Farmington Central  
H.S.  
Anthony Sirk, Purdue Univ.  
Wesley Skym, South Middle School  
Mitzi Smith, North Central College  
Sarita Smith-Childs, Northern Illinois  
Univ.  
Jessica Steinrock, Intimacy Directors  
and Coordinators  
Donna Stone, Retired  
Denise Stout, Chicago Actor's Studio  
Jon Stricker, Rolling Meadows H.S.  
Stephanie Svarz, Rolling Meadows  
H.S.  
Dana Taylor, Dana W. Taylor  
Consulting, LLC  
Wendy Taylor, Belvidere North H.S.  
Linda Thamm, Victor J. Andrew H.S.  
Kyle A. Thomas, Missouri State Univ.  
Matthew Vala, Illinois State Univ.  
Andy Waldron, Ball State Univ.  
Lorelei Wernecke, Illinois State Univ.  
Sarah Wigley, Univ. of Illinois  
Urbana-Champaign  
Bart Williams, Southeast Missouri  
State Univ.  
Matthew Williams, Southern Illinois  
Univ., Carbondale  
LaDonna Wilson, Champaign Central  
H.S.  
Lisa Wipperling, Western Illinois Univ.  
Natalie Wooden, Belvidere Theatre  
Company  
Dylan Young, Victor J. Andrew H.S.  
Joey Zangardi-Dixon, New York Film  
Academy College of Visual and  
Performing Arts

**Students, we want your feedback!**  
**Share your thoughts about this year's Festival by visiting**  
**<https://illinoistheatrefest.org> to complete the Festival survey.**



Presenting:

*The 2023 Illinois High School Theatre Festival All-State Production*

Music by Jeanine Tesori  
Book by David Lindsay-Abaire

Based on the DreamWorks Animation Motion Picture  
and the book by William Steig



*Shrek The Musical* is presented  
by arrangement with MTI  
(mtishows.com)

## Cast

### Luke Ahlquist

Oswego East High School  
Pied Piper/Guard

### Elena Akerberg

Prairie Ridge High School  
Fiona

### Ella Anello

Addison Trail High School  
Dragon/Fairy Tale Character

### Grace Arnett

Cartersville High School  
Dulocian

### Kaitlyn Bavirsha

Lincoln-Way West High School  
Villager

### Fiona Bilkey

Glenbard East High School  
Villager

### Joshua Bonds

Oak Park and River Forest H.S.  
Donkey

### Nevaeh Bos

Lake Zurich High School  
Dulocian

### Natalie Brodsky

Harold L. Richards High School  
Dulocian/Tap Dancer

### Mitchell Brown

Carbondale Community High School  
Farquaad

### Stephen Byers Jr.

Coal City High School  
Dulocian/Tap Dancer/Guard

### Camani Campbell

Romeoville High School  
Villager/Guard

### Juliana Canastra

Deerfield High School  
Dulocian/Tap Dancer

### Derek Carlson

Coal City High School  
Captain of the Guard/Dulocian/  
Guard

### Graham Carlson

Lockport Township High School  
Baby Shrek/Baby Bear

### Sallee Collins

Pinckneyville High School  
Villager

### Molly Czechanski

Lincoln-Way East High School  
Villager; Teen Fiona Understudy

### Alex Day

Adlai E. Stevenson High School  
Pinocchio

### Blake Donalson

Oak Park and River Forest H.S.  
Dulocian/Tap Dancer

### Violet Easley

Farmington Central High School  
Villager

### Bryson Edwards

Cartersville High School  
Thelonius/Dulocian/Tap Dancer/  
Guard

### Brayden Follett

Jacobs High School  
Knight 1/Villager

### Lilly Fujioka

Adlai E Stevenson High School  
Villager

### Armani Gennell

West Leyden High School  
Pig 1

### Charles Howerton

Cartersville High School  
Papa Bear/Papa Ogre; Shrek  
Understudy



**Stella Hoyt**

Homewood Flossmoor High School  
Dulocian/Tap Dancer

**Victoria Hutson**

Oak Park and River Forest H.S.  
Blind Mouse- Fairy Tale Character

**Josh Jaffe**

Mundelein High School  
Shrek

**Claire Jansen**

Prairie Ridge High School  
Sugar Plum/Gingy

**Jersie Joniak**

Lockport Township High School  
Humpty Dumpty

**Justin Katin**

Adlai E Stevenson High School  
Wolf; Farquaad Understudy

**Olivia Konstantelos**

Naperville North High School  
Elf

**Felisa Lascano**

Hampshire High School  
Villager

**James Leonardi**

Fenwick High School  
Pig 3

**Ameriah Lockett**

Urbana High School  
Villager

**Lily Mace**

Adlai E Stevenson High School  
Dulocian/Tap Dancer

**Melodi Magluyan**

Lake Zurich High School  
Villager

**Katie McCormick**

Lake Zurich High School  
Greeter/Villager/Guard

**Gabriel McKinney**

Homewood Flossmoor High School  
Ugly Duckling; Donkey Understudy

**Athiana Moran**

East Leyden High School  
Tweedle Dum

**Jayla Morgan**

Glenbard South High School  
Tweedle Dee

**Mason Natyshok**

Coal City High School  
Speaking Guard/ Dulocian/Tap  
Dancer/Guard

**Maren Nazar**

Maine South High School  
Peter Pan

**Jonathan Protus**

Vernon Hills High School  
Knight 3/Dwarf/ Villager

**Finley Pullano**

Maine South High School  
Dulocian/Tap Dancer

**Dylan Rhodes**

Amos Alonzo Stagg High School  
Queen Lillian/Villager

**Kaitlyn Rose**

Kankakee High School  
Blind Mouse–Fairy Tale Character

**Abigail Sanford**

Lockport Township High School  
Blind Mouse/Bluebird; Fiona  
Understudy

**Mary Kate Schoessling**

St. Charles East High School  
Mama Ogre/Mama Bear

**Tyler Schorsch**

Palatine High School  
Knight 4/Villager

**Andrew Schulien**

Warren Township High School  
Dulocian/Tap Dancer/Guard

**Arjun Shah**

Hinsdale Central High School  
Bishop/Guard

**McKenna Sharkey**

Cary Grove High School  
Dulocian/Tap Dancer

**Teagan Sharkey**

Cary Grove High School  
Dulocian/Tap Dancer

**Zoe Shores-Navata**

Wheaton North High School  
Dulocian

**Cydney Thomas**

Bolingbrook High School  
Fairy Godmother

**Samuel Tichenor**

Edwardsville High School  
Knight 2/King Harold/Villager

**Joseph Timberlake**

Crystal Lake South High School  
Dulocian/Tap Dancer/Guard

**Cameren Truelove**

Oak Park River and Forest H.S.  
Dulocian/Tap Dancer

**Zach Ulmer**

Huntley High School  
Mad Hatter; Pinocchio Understudy

**Audrey Wagner**

Hampshire High School  
Teen Fiona/Fairy Tale Character

**Amy Wang**

Neuqua Valley High School  
Dulocian/Tap Dancer

**Jack Winkelhake**

Burlington Central High School  
White Rabbit

**Jessica Wolthusen**

Oak Park and River Forest H.S.  
Wicked Witch

**Roya Zaucha**

Bolingbrook High School  
Dulocian/Tap Dancer/Guard

**Crew****Drew Bagby**

Edwardsville High School

**Joseph Begley**

Deerfield High School

**Chelsea Broeker**

Edwardsville High School

**McKenzie Bruce**

Streator Township High School

**Rachel Burton**

Burlington Central High School

**Caidyn Crouch**

Edwardsville High School

**Eric Curran**

Mother McAuley Liberal Arts H.S.

**Jenna DuMelle**

Burlington Central High School



**Rory Dwyer***Grayslake North High School***Oliver Fisher-Rohde***Deerfield High School***Natasha Fugate***Downers Grove North High School***Nikolai Gadomski***Downers Grove South High School***Hannah Garmon***University High School***Graham Gatewood***Grayslake North High School***Eduardo Hernandez***Reavis High School***Maggie Hershey***Maine South High School***Julia Howard***Deerfield High School***Addison Kamilis***Grayslake North High School***Ian Kedrowski***Oak Park and River Forest H.S.***Chloe Kovacevich***East Leyden High School***Ellen Krivak***Riverside Brookfield High School***Talia Lasky***Maine East High School***Victoria Liokumovich***Adlai E. Stevenson High School***AJ McAndrews***Downers Grove South High School***Sean McNicholas***Grayslake North High School***Charlie O'Connor***Deerfield High School***Ava Petrowski***Mother McAuley Liberal Arts H.S.***Ilex Rosen***Adlai E. Stevenson High School***Keegan Sampey***Addison Trail High School***Vera Soberg***Walter Payton College Prep***Megan Sowa***Addison Trail High School***Elizabeth Steele***Glenbard South High School***Janelle Steger***Nazareth Academy***Zach Stutland***Deerfield High School***Aidan Sullivan***Downers Grove South High School***Emma Swiersz***Huntley High School***Michelle Torishnyak***Lake Zurich High School***Rodolfo Torres***West Leyden High School***Kaitlyn Urbanowicz***Glenbard South High School***Aurora Wilke***Edwardsville High School***Isabella Wilson***Bolingbrook High School***Orchestra****Sarah Ballenger***Streamwood High School*  
*Violin***Stanica Butnariu***Reavis High School*  
*Clarinet/Bass Clarinet***Ciara Carroll***Lake Forest High School*  
*Drum Set***Kayla Connelly***Coal City High School*  
*Alto Saxophone***Analisa Cress***Warren Township High School*  
*Horn***Allison Dennison***Harrisburg High School*  
*Tenor/Bari Sax***Aldre Delos Santos***Prairie Ridge High School*  
*Trumpet***Matthew Derong***Bolingbrook High School*  
*Guitar 1***Trini Feng***Crystal Lake South High School*  
*Keyboard***Caleb Gumming***Vernon Hills High School*  
*Cello***Tawney Kellogg***Oswego High School*  
*Flute/Picc.***Matthew Kohl***Glenbard South High School*  
*Keyboard***Gabriel Koppel***Bolingbrook High School*  
*Percussion***Ananya Maddulapalli***James B. Conant High School*  
*Clarinet***Liam Mulroe***Lake Zurich High School*  
*Guitar 2***Addison Paunan***Buffalo Grove High School*  
*Violin***Sam Rutledge***West Chicago High School*  
*Flute***Sarah Walser***Bartlett High School*  
*Bass***Blake Whatcott***Bolingbrook High School*  
*Trombone*

## Production Team

**Michelle DePasquale Bayer, Director**

Oak Park and River Forest High School

**Tom Skobel, Co-Producer**

Lake Zurich High School

**Katherine Apperson-Skobel, Co-Producer**

James B. Conant High School

**Connor Cornelius, Choreographer**

Oak Park and River Forest High School/Intuit Dance and Momenta Dance

**Hannah Drake, Vocal Music Director**

Harrisburg High School

**Lisa Garza, Pit Director**

Bolingbrook High School

**Jack Micetich, Costumes**

Coal City High School

**Hunter Evans, Scenic Designer**

Downers Grove South High School

**Ron Bowden Jr., Technical Director**

Grayslake North High School

**Michael Clack, Asst. Technical Director**

Deerfield High School

**Hector Hernandez, Properties**

Larsen Middle School

**Anthony Bartucci, Sound Design**

AB Production Associates

**Maggie Rausch, Asst. Sound Design**

AB Production Associates

**Noah Record, Light Design**

Protolight

**Teslen Sadowski, Asst. Light Design**

Leyden High School District 212

**Alex Holod, Special Effects Designer**

Addison Trail High School

**Suzanne Aldridge, Local Arrangements**

Champaign Centennial High School (retired)

**Lorelei Wernecke, Intern**

Illinois State University

**Hailey Bonk, Intern**

Illinois State University

**Dilan Gursoy, Intern**

Illinois State University

**Julian Fonseca, Intern**

Illinois State University

**Hannah Brigham, Intern**

Illinois State University

**Ian McGonigal, Make-up/Hair**

Illinois State University

**Tracy Nunnally, Rigging Supervisor**

Northern Illinois University/Vertigo

## Festival at a Glance

Check the Festival App for updates on workshop changes and cancellations.

### Thursday, January 12

|                         |  |                                    |
|-------------------------|--|------------------------------------|
| 4:00 pm-10:00 pm        | Exhibit Hall Open                                    | KCPA Lobby                         |
| 6:00 pm-7:30 pm         | Opening Ceremony & Leah Marlene Performance          | KCPA Foellinger Great Hall         |
| <b>7:30 pm-10:00 pm</b> | <b>SHREK THE MUSICAL (2023 ALL-STATE PRODUCTION)</b> | <b>KCPA Tryon Festival Theatre</b> |
| 8:30 pm-10:00 pm        | Opening Ceremony & Leah Marlene Performance          | KCPA Foellinger Great Hall         |

### Friday, January 13

|                  |                               |                     |
|------------------|-------------------------------|---------------------|
| 8:00 am-1:30 pm  | College Portfolio Interviews  | ISR Seminar Room 89 |
| 8:00 am-5:00 pm  | College Performance Auditions | ISR Seminar Room 94 |
| 8:00 am-10:00 pm | Exhibit Hall Open             | KCPA Lobby          |

Friday, continued

|                          |      |  |                               |
|--------------------------|------|--|-------------------------------|
| <b>9:00 am-11:30 am</b>  |      | <b>THE ADDAMS FAMILY (Saint Ignatius College Prep)</b>                               | <b>Foellinger Auditorium</b>  |
| <b>9:00 am-10:30 am</b>  |      | <b>THE THEORY OF RELATIVITY (Lincoln-Way East H.S.)</b>                              | <b>KCPA Colwell Playhouse</b> |
| 9:00 am-10:10 am         | [D1] | Stage Managers are Designers Too!  | Gregory Hall 111              |
| 9:00 am-10:10 am         | [P1] | Devising Theatre for Social Change   | Gregory Hall 113              |
| 9:00 am-10:10 am         | [I9] | Engaging LGBTQ+ Youth Experiences Onstage  | Natural History Bldg 2079     |
| 9:00 am-10:10 am         | [C1] | Creating the Spark: Inspiration Boards   | Illini Union 209              |
| 9:00 am-10:10 am         | [A1] | Upping Your Audition Game  | Illini Union 404              |
| 9:00 am-11:30 am         | [T1] | Colors and Your Emotional Link   | Illini Union 215              |
| 9:00 am-10:10 am         | [A2] | Ensemble Acting on Stage (There's More to See than Just the Lead!) - <b>CANCELED</b> | Illini Union 217              |
| 9:00 am-10:10 am         | [V1] | Improv 101: Introduction to Improv Basics  | Illini Union 314A             |
| 9:00 am-10:10 am         | [T2] | Scenic Design: Creating the World of the Play  | Illini Union 314B             |
| 9:00 am-11:30 am         | [M1] | Slaps, Punches, and Falls, (Oh My!): Stage Combat Toolkit for Drama Teachers         | Illini Union 403              |
| 9:00 am-10:10 am         | [I1] | Consent Based Classrooms   | Illini Union 405              |
| 9:00 am-11:30 am         | [T0] | TECH OLYMPICS ( <i>Pre-registration recommended</i> )                                | Illini Union Room ABC         |
| 9:00 am-11:30 am         | [T3] | Principles of Sound Design in Theatre and Performing Arts                            | KCPA AV Room                  |
| 9:00 am-10:10 am         | [S1] | Healthy Belting for Musical Theatre  | KCPA Choral Rehearsal Room    |
| 9:00 am-11:30 am         | [C2] | Costume Gallery  | KCPA Costume Shop             |
| 9:00 am-10:10 am         | [A7] | All-State 2024 - Join the Adventure!   | KCPA Drama Rehearsal Room     |
| 9:00 am-10:10 am         | [V2] | Improv: Character and Scene  | KCPA Ensemble B               |
| 9:00 am-10:10 am         | [M2] | Ballroom Dance Masterclass   | KCPA Orchestra Rehearsal Rm   |
| 9:00 am-5:40 pm          | [T4] | Scene Shop Open House  | KCPA Scene Shop               |
| 9:00 am-11:30 am         | [I2] | Evoke, Provoke, Disrupt: Verbatim Performance in Your Classroom                      | KCPA Studio 1                 |
| 9:00 am-10:10 am         | [M3] | Morning Musical Flow - <b>CANCELED</b>   | KCPA Studio 2                 |
| 9:00 am-10:10 am         | [A3] | Creating Character Through Movement  | Levis Center 208              |
| 9:00 am-10:10 am         | [A4] | Drugs, Drinking and Rocking That Role  | Levis Center 210              |
| 9:00 am-10:10 am         | [T5] | Creating Fluid Worlds: An Introduction to Projection Design with Isadora             | Natural History Bldg 2020A    |
| 9:00 am-10:10 am         | [A5] | Improv Scene Work  | Natural History Bldg 2078     |
| 9:00 am-11:30 am         | [A6] | Shakespeare - Original Practice (Secrets of The First Folio)                         | Natural History Bldg 2083     |
| <b>9:30 am-10:30 am</b>  |      | <b>ALICE IN WONDERLAND (Tinley Park H.S.)</b>  | <b>KCPA Studio Theatre</b>    |
| <b>10:30 am-12:30 pm</b> |      | <b>RADIUM GIRLS (Fieldcrest H.S.)</b>  | <b>Lincoln Hall Theater</b>   |
| 10:30 am-11:40 am        | [D1] | Stage Managers are Designers Too!  | Gregory Hall 111              |
| 10:30 am-11:40 am        | [P1] | Devising Theatre for Social Change   | Gregory Hall 113              |
| 10:30 am-11:40 am        | [I9] | Engaging LGBTQ+ Youth Experiences Onstage  | Natural History Bldg 2079     |
| 10:30 am-11:40 am        | [C1] | Creating the Spark: Inspiration Boards   | Illini Union 209              |
| 10:30 am-11:40 am        | [P2] | Start to Finish: Creating a Show   | Illini Union 211              |
| 10:30 am-11:40 am        | [A1] | Upping Your Audition Game  | Illini Union 404              |

**A:** Acting & Auditions • **C:** Costuming/Makeup • **D:** Directing/Stage Management • **I:** Instructors/Teachers  
**M:** Movement/Dance/Combat • **P:** Playwriting • **S:** Musical/Vocal • **T:** Technical Theatre • **V:** Improv/Variety

## Friday, continued

|                          |       |  |                                   |
|--------------------------|-------|--|-----------------------------------|
| 10:30 am-11:40 am        | [A2]  | Ensemble Acting on Stage (There's More to See than Just the Lead!) - <b>CANCELED</b>                   | Illini Union 217                  |
| 10:30 am-11:40 am        | [V1]  | Improv 101: Introduction to Improv Basics  | Illini Union 314A                 |
| 10:30 am-11:40 am        | [T2]  | Scenic Design: Creating the World of the Play  | Illini Union 314B                 |
| 10:30 am-11:40 am        | [I1]  | Consent Based Classrooms   | Illini Union 405                  |
| 10:30 am-11:40 am        | [S1]  | Healthy Belting for Musical Theatre  | KCPA Choral Rehearsal Room        |
| 10:30 am-11:40 am        | [A7]  | All-State 2024 - Join the Adventure!   | KCPA Drama Rehearsal Room         |
| 10:30 am-11:40 am        | [V2]  | Improv: Character and Scene  | KCPA Ensemble B                   |
| 10:30 am-11:40 am        | [M2]  | Ballroom Dance Masterclass   | KCPA Orchestra Rehearsal Rm       |
| 10:30 am-11:40 am        | [M4]  | Freeing The Body Through Movement and Music  | KCPA Studio 2                     |
| 10:30 am-11:40 am        | [A3]  | Creating Character Through Movement  | Levis Center 208                  |
| 10:30 am-11:40 am        | [A4]  | Drugs, Drinking and Rocking That Role  | Levis Center 210                  |
| 10:30 am-11:40 am        | [T5]  | Creating Fluid Worlds: An Introduction to Projection Design with Isadora                               | Natural History Bldg 2020A        |
| 10:30 am-11:40 am        | [A5]  | Improv Scene Work  | Natural History Bldg 2078         |
| <b>11:00 am-12:30 pm</b> |       | <b>THE THEORY OF RELATIVITY (Lincoln-Way East H.S.)</b>  | <b>KCPA Colwell Playhouse</b>     |
| <b>11:00 am-12:30 pm</b> |       | <b>THE BOMB-ITTY OF ERRORS (Downers Grove North H.S.)</b>  | <b>KCPA Foellinger Great Hall</b> |
| <b>11:00 am-12:00 pm</b> |       | <b>ALICE IN WONDERLAND (Tinley Park H.S.)</b>  | <b>KCPA Studio Theatre</b>        |
| 12:00 pm-1:10 pm         | [A9]  | Look Here! Creating Focus on the Stage   | Gregory Hall 111                  |
| 12:00 pm-1:10 pm         | [I5]  | Picking A Master's Program: The Theatre Conservatory At Roosevelt University's MA in Theatre Directing | Gregory Hall 113                  |
| 12:00 pm-1:10 pm         | [I6]  | Working with Student Stage Managers: A Guide for Teachers and Directors                                | Gregory Hall 215                  |
| 12:00 pm-1:10 pm         | [D2]  | Giving Direction: The Fundamentals of Directing  | Gregory Hall 217                  |
| 12:00 pm-1:10 pm         | [M5]  | Musical Theatre Dance - On Your Feet!  | Illini Union 210                  |
| 12:00 pm-1:10 pm         | [T8]  | Scenic Design 101  | Illini Union 211                  |
| 12:00 pm-1:10 pm         | [T9]  | Stage Props 101  | Illini Union 215                  |
| 12:00 pm-1:10 pm         | [P3]  | How to Write a 10-Minute Play  | Illini Union 217                  |
| 12:00 pm-1:10 pm         | [M6]  | Musical Theatre Movement!  | Illini Union 403                  |
| 12:00 pm-1:10 pm         | [M7]  | Introduction to Catfart: The Movement of Low... - <b>CANCELED</b>                                      | Illini Union 405                  |
| 12:00 pm-2:30 pm         | [I14] | Building Your Own Play   | Illini Union 406                  |
| 12:00 pm-2:30 pm         | [T0]  | TECH OLYMPICS ( <i>Pre-registration recommended</i> )  | Illini Union Room ABC             |
| 12:00 pm-2:30 pm         | [T10] | What am I Doing Wrong in the World of Tech?  | KCPA AV Room                      |
| 12:00 pm-1:10 pm         | [C3]  | Underwear is FUN to Wear!  | KCPA Choral Rehearsal Room        |
| 12:00 pm-1:10 pm         | [I4]  | Taking a Show on the Road  | KCPA Drama Rehearsal Room         |
| 12:00 pm-1:10 pm         | [V4]  | Sketch Me If You Can   | KCPA Ensemble B                   |
| 12:00 pm-1:10 pm         | [V3]  | Creating an Original Play Via Improv   | KCPA Orchestra Rehearsal Rm       |
| 12:00 pm-1:10 pm         | [T11] | Pallet Popping Green Theatre   | KCPA Studio 1                     |
| 12:00 pm-1:10 pm         | [A11] | Personalizing your Audition Material   | Levis Center 208                  |

**A:** Acting & Auditions • **C:** Costuming/Makeup • **D:** Directing/Stage Management • **I:** Instructors/Teachers  
**M:** Movement/Dance/Combat • **P:** Playwriting • **S:** Musical/Vocal • **T:** Technical Theatre • **V:** Improv/Variety

Friday, continued

|                        |       |  |                                    |
|------------------------|-------|--|------------------------------------|
| 12:00 pm-1:10 pm       | [A10] | Embracing the Ensemble - <b>CANCELED</b>   | Levis Center 210                   |
| 12:00 pm-1:10 pm       | [S3]  | How Do I Pop/Rock?!  | Natural History Bldg 2020A         |
| 12:00 pm-1:10 pm       | [A12] | Cast Me If You Can!  | Natural History Bldg 2020B         |
| 12:00 pm-1:10 pm       | [A13] | On-Camera And Self-Taping Auditions  | Natural History Bldg 2078          |
| 12:00 pm-1:10 pm       | [T7]  | Present a Winning Tech Portfolio   | Natural History Bldg 2079          |
| 12:00 pm-2:30 pm       | [A6]  | Shakespeare - Original Practice (Secrets of The First Folio)   | Natural History Bldg 2083          |
| <b>1:30 pm-3:00 pm</b> |       | <b>THE BOMB-ITTY OF ERRORS (Downers Grove North H.S.)</b>  | <b>KCPA Foellinger Great Hall</b>  |
| <b>1:30 pm-2:00 pm</b> |       | <b>SORRY, WRONG NUMBER (Keith Country Day School)</b>  | <b>KCPA Studio Theatre</b>         |
| <b>1:30 pm-3:30 pm</b> |       | <b>RADIUM GIRLS (Fieldcrest H.S.)</b>  | <b>Lincoln Hall Theater</b>        |
| 1:30 pm-2:40 pm        | [A9]  | Look Here! Creating Focus on the Stage   | Gregory Hall 111                   |
| 1:30 pm-2:40 pm        | [I5]  | Picking A Master's Program: The Theatre Conservatory At Roosevelt University's MA in Theatre Directing | Gregory Hall 113                   |
| 1:30 pm-2:40 pm        | [I6]  | Working with Student Stage Managers: A Guide for Teachers and Directors                                | Gregory Hall 215                   |
| 1:30 pm-2:40 pm        | [D2]  | Giving Direction: The Fundamentals of Directing  | Gregory Hall 217                   |
| 1:30 pm-2:40 pm        | [M5]  | Musical Theatre Dance - On Your Feet!  | Illini Union 210                   |
| 1:30 pm-2:40 pm        | [T8]  | Scenic Design 101  | Illini Union 211                   |
| 1:30 pm-2:40 pm        | [T9]  | Stage Props 101  | Illini Union 215                   |
| 1:30 pm-2:40 pm        | [P3]  | How to Write a 10-Minute Play  | Illini Union 217                   |
| 1:30 pm-2:40 pm        | [T6]  | Tech- Tools, Techniques, Tips & Tricks for Scenery   | Illini Union 314B                  |
| 1:30 pm-2:40 pm        | [M6]  | Musical Theatre Movement!  | Illini Union 403                   |
| 1:30 pm-2:40 pm        | [M7]  | Introduction to Catfart: The Movement of Low... - <b>CANCELED</b>                                      | Illini Union 405                   |
| 1:30 pm-2:40 pm        | [C3]  | Underwear is FUN to Wear!  | KCPA Choral Rehearsal Room         |
| 1:30 pm-2:40 pm        | [I3]  | Boosting Your Thespian Troupe  | KCPA Drama Rehearsal Room          |
| 1:30 pm-2:40 pm        | [V4]  | Sketch Me If You Can   | KCPA Ensemble B                    |
| 1:30 pm-2:40 pm        | [V3]  | Creating an Original Play Via Improv   | KCPA Orchestra Rehearsal Rm        |
| 1:30 pm-2:40 pm        | [T11] | Pallet Popping Green Theatre   | KCPA Studio 1                      |
| 1:30 pm-2:40 pm        | [A11] | Personalizing your Audition Material   | Levis Center 208                   |
| 1:30 pm-2:40 pm        | [A10] | Embracing the Ensemble - <b>CANCELED</b>   | Levis Center 210                   |
| 1:30 pm-2:40 pm        | [S3]  | How Do I Pop/Rock?!  | Natural History Bldg 2020A         |
| 1:30 pm-2:40 pm        | [A12] | Cast Me If You Can!  | Natural History Bldg 2020B         |
| 1:30 pm-2:40 pm        | [A13] | On-Camera And Self-Taping Auditions  | Natural History Bldg 2078          |
| 1:30 pm-2:40 pm        | [A8]  | The Ins & Outs of Thespy   | Natural History Bldg 2079          |
| <b>2:30 pm-5:00 pm</b> |       | <b>SHREK THE MUSICAL (2023 ALL-STATE PRODUCTION)</b>   | <b>KCPA Tryon Festival Theatre</b> |
| <b>2:30 pm-3:00 pm</b> |       | <b>SORRY, WRONG NUMBER (Keith Country Day School)</b>  | <b>KCPA Studio Theatre</b>         |
| 3:00 pm-5:30 pm        | [P4]  | Playful Theatre: Designing Immersive Adventures  | Gregory Hall 111                   |
| 3:00 pm-4:10 pm        | [I7]  | IHSA Answers for You!  | Gregory Hall 113                   |
| 3:00 pm-4:10 pm        | [A14] | Fun with Open Scenes   | Gregory Hall 215                   |
| 3:00 pm-4:10 pm        | [D3]  | Stage Management Teams: The Power of Partnership   | Gregory Hall 217                   |
| 3:00 pm-4:10 pm        | [C4]  | Costume Designing with Music   | Illini Union 209                   |
| 3:00 pm-4:10 pm        | [V5]  | Constructive Improv  | Illini Union 211                   |

**A:** Acting & Auditions • **C:** Costuming/Makeup • **D:** Directing/Stage Management • **I:** Instructors/Teachers  
**M:** Movement/Dance/Combat • **P:** Playwriting • **S:** Musical/Vocal • **T:** Technical Theatre • **V:** Improv/Variety

Friday, continued

|                        |       |   |                               |
|------------------------|-------|---|-------------------------------|
| 3:00 pm-5:30 pm        | [A20] | Performing Shakespeare - Unrehearsed!   | Illini Union 217              |
| 3:00 pm-4:10 pm        | [T6]  | Tech- Tools, Techniques, Tips & Tricks for Scenery                                | Illini Union 314B             |
| 3:00 pm-5:30 pm        | [M9]  | Provoking Presence  | Illini Union 403              |
| 3:00 pm-4:10 pm        | [I15] | I Teach or Will Teach Theater, What the Heck Do I Do?                             | Illini Union 406              |
| 3:00 pm-5:30 pm        | [T13] | How to Use a Performance Space to Generate Income                                 | KCPA AV Room                  |
| 3:00 pm-5:30 pm        | [C5]  | Mixed Media Costume Design  | KCPA Choral Rehearsal Room    |
| 3:00 pm-4:10 pm        | [T12] | Technical Theatre and Curricular Development                                      | KCPA Drama Rehearsal Room     |
| 3:00 pm-4:10 pm        | [S4]  | 16-32 Bar Cut Vocal/Acting Coaching   | KCPA Ensemble A               |
| 3:00 pm-5:30 pm        | [V6]  | Fiasco: Long Form Improv  | KCPA Ensemble B               |
| 3:00 pm-4:10 pm        | [M8]  | Choreographing to Delight the Director and Capture the Dancer                     | KCPA Studio 1                 |
| 3:00 pm-4:10 pm        | [I8]  | Scene Shop Safety: No Longer a Fairy Tale   | Meet at Fest HQ in KCPA Lobby |
| 3:00 pm-4:10 pm        | [A15] | I Want I Want, I Need I Need: Exploring Dramatic Action in a Physical and Fun Way | Levis Center 208              |
| 3:00 pm-4:10 pm        | [A16] | Shakespeare: Text in Action!  | Natural History Bldg 2020A    |
| 3:00 pm-4:10 pm        | [S5]  | Acting The Song   | Natural History Bldg 2020B    |
| 3:00 pm-4:10 pm        | A18]  | Puppet Manipulation 101   | Natural History Bldg 2079     |
| 3:00 pm-4:10 pm        | [A19] | Theatrical Style: More Real than Realism!   | Natural History Bldg 2083     |
| <b>3:30 pm-6:00 pm</b> |       | <b>CARRIE: THE MUSICAL (Hinsdale South H.S.)</b>                                  | <b>Foellinger Auditorium</b>  |
| <b>3:30 pm-4:00 pm</b> |       | <b>SORRY, WRONG NUMBER (Keith Country Day School)</b>                             | <b>KCPA Studio Theatre</b>    |
| <b>4:00 pm-6:00 pm</b> |       | <b>THE PLAY THAT GOES WRONG: HIGH SCHOOL EDITION (Maine East H.S.)</b>            | <b>KCPA Colwell Playhouse</b> |
| 4:30 pm-5:40 pm        | [I7]  | IHSA Answers for You!   | Gregory Hall 113              |
| 4:30 pm-5:40 pm        | [A14] | Fun with Open Scenes  | Gregory Hall 215              |
| 4:30 pm-5:40 pm        | [D3]  | Stage Management Teams: The Power of Partnership                                  | Gregory Hall 217              |
| 4:30 pm-5:40 pm        | [C4]  | Costume Designing with Music  | Illini Union 209              |
| 4:30 pm-5:40 pm        | [V5]  | Constructive Improv   | Illini Union 211              |
| 4:30 pm-5:40 pm        | [I15] | I Teach or Will Teach Theater, What the Heck Do I Do?                             | Illini Union 406              |
| 4:30 pm-5:40 pm        | [S4]  | 16-32 Bar Cut Vocal/Acting Coaching   | KCPA Ensemble A               |
| 4:30 pm-5:40 pm        | [T12] | Technical Theatre and Curricular Development                                      | KCPA Drama Rehearsal Room     |
| 4:30 pm-5:40 pm        | [M8]  | Choreographing to Delight the Director and Capture the Dancer                     | KCPA Studio 1                 |
| 4:30 pm-5:40 pm        | [I8]  | Scene Shop Safety: No Longer a Fairy Tale   | Meet at Fest HQ in KCPA Lobby |
| 4:30 pm-5:40 pm        | [A15] | I Want I Want, I Need I Need: Exploring Dramatic Action in a Physical and Fun Way | Levis Center 208              |
| 4:30 pm-5:40 pm        | [A16] | Shakespeare: Text in Action!  | Natural History Bldg 2020A    |
| 4:30 pm-5:40 pm        | [S5]  | Acting The Song   | Natural History Bldg 2020B    |
| 4:30 pm-5:40 pm        | [A18] | Puppet Manipulation 101   | Natural History Bldg 2079     |
| 4:30 pm-5:40 pm        | [A19] | Theatrical Style: More Real than Realism!   | Natural History Bldg 2083     |

**A:** Acting & Auditions • **C:** Costuming/Makeup • **D:** Directing/Stage Management • **I:** Instructors/Teachers  
**M:** Movement/Dance/Combat • **P:** Playwriting • **S:** Musical/Vocal • **T:** Technical Theatre • **V:** Improv/Variety



Friday, continued

|                   |   |                                    |
|-------------------|---|------------------------------------|
| 5:30 pm-6:30 pm   | <b>THE WAR OF THE WORLDS: THE 1938 RADIO SCRIPT (Collinsville H.S.)</b> | <b>KCPA Studio Theatre</b>         |
| 6:30 pm-8:30 pm   | <b>BAD SEED (Warren Township H.S.)</b>                                  | <b>Lincoln Hall Theater</b>        |
| 7:00 pm-9:00 pm   | <b>THE PLAY THAT GOES WRONG: HIGH SCHOOL EDITION (Maine East H.S.)</b>  | <b>KCPA Colwell Playhouse</b>      |
| 7:30 pm-10:00 pm  | <b>CARRIE: THE MUSICAL (Hinsdale South H.S.)</b>                        | <b>Foellinger Auditorium</b>       |
| 7:30 pm-10:00 pm  | <b>SHREK THE MUSICAL (2023 ALL-STATE PRODUCTION)</b>                    | <b>KCPA Tryon Festival Theatre</b> |
| 8:00 pm-9:00 pm   | Zoo Improv Performance  | KCPA Foellinger Great Hall         |
| 10:00 pm-11:45 pm | Karaoke   | KCPA Choral Rehearsal Room         |
| 10:00 pm-11:00 pm | Zoo Improv Performance  | KCPA Foellinger Great Hall         |
| 10:00 pm-11:45 pm | Life-Sized Games  | KCPA Studio 2                      |
| 10:00 pm-11:30 pm | Bowling, Billiards, and Video Games                                     | Illini Union, Lower Level          |
| 10:00 pm-11:30 pm | Sponsors' Reception   | Illini Union South Lounge          |

**Saturday, January 14**

|                   |   |   |
|-------------------|---|---|
| 9:00 am-3:00 pm   | Exhibit Hall Open   | KCPA Lobby                                  |
| 9:30 am-12:00 pm  | <b>SPAMALOT (Wauconda H.S.)</b>   | <b>KCPA Colwell Playhouse</b>               |
| 9:30 am-12:00 pm  | <b>SHREK THE MUSICAL (2023 ALL-STATE PRODUCTION)</b>  | <b>KCPA Tryon Festival Theatre</b>          |
| 10:00 am-12:00 pm | <b>PUFFS OR SEVEN INCREASINGLY EVENTFUL YEARS AT A CERTAIN SCHOOL OF MAGIC AND MAGIC (Antioch Community H.S.)</b> | <b>Foellinger Auditorium</b>                |
| 10:00 am-12:00 pm | <b>AS YOU LIKE IT (Lakes Community H.S.)</b>  | <b>KCPA Foellinger Great Hall</b>           |
| 10:00 am-10:30 am | <b>MATILDA (Glenbard East H.S.)</b>   | <b>KCPA Studio Theatre</b>                  |
| 10:00 am-11:10 am | [I10] Welcome to the Jungle: Personalities in Your Classroom, Theatre Program, and Beyond                         | Gregory Hall 111                            |
| 10:00 am-11:10 am | [D6] Making <i>The Play That Goes Wrong</i> Go Right - <b>CANCELED</b>  | Gregory Hall 113                            |
| 10:00 am-11:10 am | [S2] The Authentic Auditioner   | Gregory Hall 215                            |
| 10:00 am-11:10 am | [A22] Jumpstart into Acting   | Illini Union 210                            |
| 10:00 am-11:10 am | [I11] Connected Arts Network—Connecting DEI, SEL, and Standards to Enrich Your Classroom                          | Illini Union 211                            |
| 10:00 am-11:10 am | [T14] Start Designing Fast with Sketchup Free Online  | Illini Union 215                            |
| 10:00 am-11:10 am | [C6] Designing Through the Decades (Costume Design)   | Illini Union 217                            |
| 10:00 am-11:10 am | [A23] Viewpoints 101, The Sixth Sense   | Illini Union 403                            |
| 10:00 am-11:10 am | [T15] The BACKstage Exam: Measuring High School Tech Success  | Illini Union 407                            |
| 10:00 am-11:10 am | [M10] Weaponized Stage Combat: Safety's the Thing   | Illini Union Ballroom (2 <sup>nd</sup> Flr) |
| 10:00 am-11:10 am | [M11] Dancing with Intention: Motivation in Movement  | Illini Union Room A                         |
| 10:00 am-11:10 am | [A24] Wings and Capes and Tails, Oh My!   | Illini Union Room C                         |
| 10:00 am-11:10 am | [A25] The Perks of Getting a BA in Theatre Studies  | ISR Seminar Room 93                         |
| 10:00 am-11:10 am | [C7] Careers in Costumes!   | KCPA Choral Rehearsal Room                  |
| 10:00 am-12:30 pm | [S6] Jump into <i>The Addams Family</i>   | KCPA Ensemble A                             |
| 10:00 am-11:10 am | [T16] Color Theory for the Stage  | KCPA Light Lab                              |
| 10:00 am-11:10 am | [V7] Improv: Fight Your Fear... and Win!  | KCPA Orchestra Rehearsal Rm                 |

**A:** Acting & Auditions • **C:** Costuming/Makeup • **D:** Directing/Stage Management • **I:** Instructors/Teachers  
**M:** Movement/Dance/Combat • **P:** Playwriting • **S:** Musical/Vocal • **T:** Technical Theatre • **V:** Improv/Variety

Saturday, continued

|                          |       |   |   |
|--------------------------|-------|---|---|
| 10:00 am-3:40 pm         | [T17] | Scene Shop Open House   | KCPA Scene Shop                             |
| 10:00 am-11:10 am        | [M12] | Athletic Strength/Conditioning and Musical Theatre Choreography   | KCPA Studio 1                               |
| 10:00 am-11:10 am        | [M13] | Morning Musical Flow - <b>CANCELED</b>  | KCPA Studio 2                               |
| 10:00 am-11:10 am        | [S7]  | Self-Tape Auditions: Acting & Musical Theatre (A Casting Director's Perspective)                                  | Natural History Bldg 2020A                  |
| 10:00 am-11:10 am        | [T18] | Projection Design for Live Performance  | Natural History Bldg 2020B                  |
| 10:00 am-11:10 am        | [A26] | Shakespeare Monologue   | Natural History Bldg 2078                   |
| 10:00 am-12:30 pm        | [A27] | International Thespian Excellence Awards (Thespy)   | Natural History Bldg 2079                   |
| 10:00 am-12:30 pm        | [P5]  | Got an Hour? Write a Play!  | Natural History Bldg 2083                   |
| <b>11:00 am-11:30 am</b> |       | <b>MATILDA (Glenbard East H.S.)</b>   | <b>KCPA Studio Theatre</b>                  |
| <b>11:00 am-1:00 pm</b>  |       | <b>BAD SEED (Warren Township H.S.)</b>  | <b>Lincoln Hall Theater</b>                 |
| 11:30 am-12:40 pm        | [I10] | Welcome to the Jungle: Personalities in Your Classroom, Theatre Program, and Beyond                               | Gregory Hall 111                            |
| 11:30 am-12:40 pm        | [D6]  | Making <i>The Play That Goes Wrong</i> Go Right - <b>CANCELED</b>   | Gregory Hall 113                            |
| 10:00 am-11:10 am        | [S2]  | Dominance and Directing - <b>CANCELED</b>   | Gregory Hall 217                            |
| 11:30 am-12:40 pm        | [A22] | Jumpstart into Acting   | Illini Union 210                            |
| 11:30 am-12:40 pm        | [I11] | Connected Arts Network—Connecting DEI, SEL, and Standards to Enrich Your Classroom                                | Illini Union 211                            |
| 11:30 am-12:40 pm        | [T14] | Start Designing Fast with Sketchup Free Online  | Illini Union 215                            |
| 11:30 am-12:40 pm        | [C6]  | Designing Through the Decades (Costume Design)  | Illini Union 217                            |
| 11:30 am-12:40 pm        | [A23] | Viewpoints 101, The Sixth Sense   | Illini Union 403                            |
| 11:30 am-12:40 pm        | [T15] | The BACKstage Exam: Measuring High School Tech Success  | Illini Union 407                            |
| 11:30 am-12:40 pm        | [M10] | Weaponed Stage Combat: Safety's the Thing   | Illini Union Ballroom (2 <sup>nd</sup> Flr) |
| 11:30 am-12:40 pm        | [M11] | Dancing with Intention: Motivation in Movement  | Illini Union Room A                         |
| 11:30 am-12:40 pm        | [A24] | Wings and Capes and Tails, Oh My!   | Illini Union Room C                         |
| 11:30 am-12:40 pm        | [A25] | The Perks of Getting a BA in Theatre Studies  | ISR Seminar Room 93                         |
| 11:30 am-12:40 pm        | [C7]  | Careers in Costumes!  | KCPA Choral Rehearsal Room                  |
| 11:30 am-2:00 pm         | [T19] | The Art of Lighting the Stage   | KCPA Light Lab                              |
| 11:30 am-12:40 pm        | [V7]  | Improv: Fight Your Fear... and Win!   | KCPA Orchestra Rehearsal Rm                 |
| 11:30 am-12:40 pm        | [M12] | Athletic Strength/Conditioning and Musical Theatre Choreography   | KCPA Studio 1                               |
| 11:30 am-12:40 pm        | [M14] | Space Walk  | KCPA Studio 2                               |
| 11:30 am-12:40 pm        | [S7]  | Self-Tape Auditions: Acting & Musical Theatre (A Casting Director's Perspective)                                  | Natural History Bldg 2020A                  |
| 11:30 am-12:40 pm        | [T18] | Projection Design for Live Performance  | Natural History Bldg 2020B                  |
| 11:30 am-12:40 pm        | [A26] | Shakespeare Monologue   | Natural History Bldg 2078                   |
| <b>12:30 pm-3:00 pm</b>  |       | <b>SPAMALOT (Wauconda H.S.)</b>   | <b>KCPA Colwell Playhouse</b>               |
| <b>12:30 pm-2:30 pm</b>  |       | <b>AS YOU LIKE IT (Lakes Community H.S.)</b>  | <b>KCPA Foellinger Great Hall</b>           |
| <b>1:00 pm-3:00 pm</b>   |       | <b>PUFFS OR SEVEN INCREASINGLY EVENTFUL YEARS AT A CERTAIN SCHOOL OF MAGIC AND MAGIC (Antioch Community H.S.)</b> | <b>Foellinger Auditorium</b>                |

**A:** Acting & Auditions • **C:** Costuming/Makeup • **D:** Directing/Stage Management • **I:** Instructors/Teachers  
**M:** Movement/Dance/Combat • **P:** Playwriting • **S:** Musical/Vocal • **T:** Technical Theatre • **V:** Improv/Variety

## Saturday, continued

|                        |       |  |                                    |
|------------------------|-------|--|------------------------------------|
| 1:00 pm-2:10 pm        | [I12] | Debuting a World Premiere with Teatro Leyden                                   | Gregory Hall 111                   |
| 1:00 pm-2:10 pm        | [D5]  | Tick Tock Time's Up: Time Management Techniques for your Terrifying To-Do List | Gregory Hall 217                   |
| 1:00 pm-2:10 pm        | [A28] | Jump Rope Acting   | Illini Union 209                   |
| 1:00 pm-2:10 pm        | [A29] | The Art of the Self-Tape: Nail That Audition!                                  | Illini Union 211                   |
| 1:00 pm-2:10 pm        | [C8]  | Create a Neck Ruff   | Illini Union 215                   |
| 1:00 pm-2:10 pm        | [T20] | Simple Machines-Problem Solvers  | Illini Union 217                   |
| 1:00 pm-2:10 pm        | [T21] | Getting the Job: Resume Creation for Theater                                   | Illini Union 407                   |
| 1:00 pm-3:30 pm        | [M16] | Dance for Musical Theatre  | Illini Union Ballroom (2nd Flr)    |
| 1:00 pm-2:10 pm        | [A30] | Finding the Animal in You and Me   | Illini Union Room A                |
| 1:00 pm-2:10 pm        | [A31] | Improvising Inside a Script!   | Illini Union Room C                |
| 1:00 pm-3:30 pm        | [C9]  | Foamsmithing: Introduction to the Basics                                       | KCPA Choral Rehearsal Room         |
| 1:00 pm-2:10 pm        | [M15] | The Storytelling Power of Music  | KCPA Ensemble A                    |
| 1:00 pm-2:10 pm        | [V8]  | Respect, And: Make-em-ups and Taking Up Space                                  | KCPA Orchestra Rehearsal Rm        |
| 1:00 pm-2:10 pm        | [A32] | An Actor's Viewpoints - <b>TENTATIVE</b>                                       | Natural History Bldg 2020A         |
| 1:00 pm-2:10 pm        | [T22] | Hands on Engineering   | Natural History Bldg 2020B         |
| 1:00 pm-3:30 pm        | [A33] | MonoBlogs!: Creating an Original Monologue                                     | Natural History Bldg 2078          |
| 1:00 pm-3:30 pm        | [P6]  | Devising: Hansel and Gretal  | Natural History Bldg 2083          |
| <b>2:00 pm-4:30 pm</b> |       | <b>SHREK THE MUSICAL (2023 ALL-STATE PRODUCTION)</b>                           | <b>KCPA Tryon Festival Theatre</b> |
| 2:30 pm-3:40 pm        | [I12] | Debuting a World Premiere with Teatro Leyden                                   | Gregory Hall 111                   |
| 2:30 pm-3:40 pm        | [D5]  | Tick Tock Time's Up: Time Management Techniques for your Terrifying To-Do List | Gregory Hall 217                   |
| 2:30 pm-3:40 pm        | [A28] | Jump Rope Acting   | Illini Union 209                   |
| 2:30 pm-3:40 pm        | [A29] | The Art of the Self-Tape: Nail That Audition!                                  | Illini Union 211                   |
| 2:30 pm-3:40 pm        | [C8]  | Create a Neck Ruff   | Illini Union 215                   |
| 2:30 pm-3:40 pm        | [T20] | Simple Machines-Problem Solvers  | Illini Union 217                   |
| 2:30 pm-3:40 pm        | [I13] | So You Want To Be A Theatre Teacher  | Illini Union 403                   |
| 2:30 pm-3:40 pm        | [T21] | Getting the Job: Resume Creation for Theater                                   | Illini Union 407                   |
| 2:30 pm-3:40 pm        | [A30] | Finding the Animal in You and Me   | Illini Union Room A                |
| 2:30 pm-3:40 pm        | [A31] | Improvising Inside a Script!   | Illini Union Room C                |
| 2:30 pm-3:40 pm        | [M15] | The Storytelling Power of Music  | KCPA Ensemble A                    |
| 2:30 pm-3:40 pm        | [T16] | Color Theory for the Stage   | KCPA Light Lab                     |
| 2:30 pm-3:40 pm        | [V8]  | Respect, And: Make-em-ups and Taking Up Space                                  | KCPA Orchestra Rehearsal Rm        |
| 2:30 pm-3:40 pm        | [A32] | An Actor's Viewpoints - <b>TENTATIVE</b>                                       | Natural History Bldg 2020A         |
| 2:30 pm-3:40 pm        | [T22] | Hands on Engineering   | Natural History Bldg 2020B         |

**A:** Acting & Auditions • **C:** Costuming/Makeup • **D:** Directing/Stage Management • **I:** Instructors/Teachers  
**M:** Movement/Dance/Combat • **P:** Playwriting • **S:** Musical/Vocal • **T:** Technical Theatre • **V:** Improv/Variety

# Thursday Opening Ceremony & Performance

6:00 pm-7:30 pm

8:30 pm-10:00 pm

KCPA Foellinger Great Hall

## Festival Welcome, Award Presentation, and Introductions

**Ryan Lambert**, 2023 Festival Executive Director

**Judy Klingner**, 2021-22 Festival Executive Director

**Valleri Robinson**, Professor and Head, Department of Theatre, University of Illinois Urbana-Champaign

Award for Extraordinary Contributions to the Festival:

**Carmel DeStefano**, Reavis High School (retired)

**Dennis Anastasopoulos**, Reavis High School

Administrator Support Award Recipient:

**Mary McCarthy**, Victor J. Andrew High School

## 2023 Illinois High School Theatre Festival Executive Committee



Leah Marlene

## Opening Performance: Leah Marlene

Leah Marlene is a songwriter, artist, and producer with a deeply rooted desire to create art unlike anything you have heard before. With a unique, engaging voice and a songwriting style that combines elements of folk, rock, pop, soul, funk, jazz and more, she cannot be put into a box.

Leah grew up in a house full of music and guitars as her father, Derry Grehan, is a songwriter and lead guitarist with the Canadian band, Honeymoon Suite. He passed along his knowledge and passion for writing and performing. Leah began singing and writing her own songs at a very young age and never looked back! She has been performing professionally since the age of ten and releasing music since she was thirteen.

After graduating high school, Leah spent two years studying songwriting at Belmont University in Nashville. She then returned back to the Midwest to produce her latest album, "Many Colors."

Now twenty-one years old, Leah most recently came off an incredible run on Season 20 of *American Idol*, where she released her latest original single, "Flowers" and placed second runner up of the season!

Leah is a lover of people and her greatest hope is that her music may meet you exactly where you are at and help you feel whatever it is you need to feel in a given moment.

## Award Winners



### Carmel DeStefano

"Carm" was born and raised in Niagara Falls, NY and moved to Chicago after graduating from SUNY College at Buffalo to attend the Goodman School of Drama. She fell into teaching theatre at the high school level by doing a favor for one of her professors and stayed with it for over thirty years, first at the Academy of the Sacred Heart and later at Reavis High School. During her early years as the Head Drama Coach at Reavis, she was able to expand the drama students' theatrical experiences through a variety of productions, competitions, theatre festivals, workshops, professional performances, and leadership training. Although drama was only an extra-curricular, Reavis students did it all. While teaching, her involvement with the ITA was primarily as a committee member for the IHSTF where she served in many capacities, including promotions, auditions, workshops, as All-State Director, and as Executive Director of Festival 2016. After retiring from teaching, Carm has served on the ITA Board of Directors as Second Vice-president, President-elect, and President.



### Dennis Anastasopoulos

Dennis graduated from Saint Xavier University with a bachelor’s degree in Mathematics and went on to earn a master’s degree in Education from Olivet Nazarene University as well as in Theatre Directing from Roosevelt University. He recently concluded his 19th year of teaching and has spent the last 17 years of his career at Reavis High School in Burbank IL. There, he served as the technical director for the first 10 years followed by Head Theatre Coach the last 7 years, working on a number of productions. In addition to his role as treasurer, Dennis has served the IHSTF and the ITA as All-State Liaison, Director of Technology (3 years), and Box Office Manager (2 years). In 2016, Dennis Anastasopoulos had the extreme honor of directing the All-State production of *Rent*.



### Mary McCarthy

The start of Mary McCarthy’s life in the theater can be credited to her Freshman English teacher and the Leading Player. Minutes after entering the Lake Central High School auditorium at the behest of her teacher, she was in a front-row seat for a rehearsal of *Pippin*. The Leading Player said there was “magic to do,” and she was hooked for life. Professionally, Mary served as the Technical Director at Amos Alonzo Stagg for nine years. She earned a master’s degree in directing from Roosevelt University in 1997. After moving into administration at Victor J. Andrew High School, she facilitated the transition of the theater program to a new auditorium, added theater staff, and expanded the program to include a second full-length musical each year. She assisted in the development of a student-written, improv production, *Two Chairs and a Table*, and helped the group take the production to the Illinois High School Theatre Festival for the first time in the school’s history. She directed 17 musicals over the course of 12 years and assisted with numerous other productions as a producer and costumer. When the opportunity arose to repurpose an underused applied tech classroom, she created a new black box theater space to support both theatrical and musical productions. She led a district-wide effort to develop elective theater classes which, after a pandemic delay, began this year. When not working, Mary contributes to the artistic life of her community as a director and costumer for the Hyde Park Community Players and a costumer for the Hyde Park School of Dance. Mary is grateful for everyone she has worked with in the theater and for the students of Stagg and Andrew who really make the magic happen. She couldn’t have done it all without the support of her husband, Peter, and daughter, Sarah. Special thanks to Sheila Sullivan for the award nomination and for her unwavering support for Andrew Theatre.

## College Auditions and Interviews



### Performance Auditions and Portfolio Interviews

All students registered for college/university performance auditions or portfolio interview are required to attend a short meeting in their respective audition/presentation spaces *30 minutes before their scheduled audition/interview time*. Students were informed of their audition/interview times in December. Please check the **Festival website** (<https://illinoistheatrefest.org>) and Festival app for the audition/interview schedule.

### Friday

#### 8:00 am-5:00 pm

ISR Seminar Room 94  
(Lower Level)

#### Performance Auditions

For junior and senior high school students who pre-registered to audition for performance programs at 37 different colleges and universities. Please note: Auditionees who are singing and performing a monologue will sing first and perform their monologue second.

#### 8:00 am-1:30 pm

ISR Seminar Room 89  
(Lower Level)

#### Technical Portfolio Interviews

For junior and senior high school students who preregistered to present their tech/directing/BA portfolios to theatre reps from 28 different colleges and universities.



# Friday Evening Activities

**8:00-9:00 pm**

**10:00-11:00 pm**

KCPA Foellinger Great Hall

## **Zoo Improv Performance**

Zoo Improv is a not-for-profit organization founded in 2005 and comprised of a diverse group of improvisers. It is organized for artistic and educational purposes, more specifically to explore and experiment with various forms of improvisational theater through study, rehearsal, workshop, and performance; to maintain an open environment of participation by all members; to encourage an active interest in the art form in the community at large; with a focus on maximizing growth and artistic merit.

**10:00-11:45 pm**

KCPA Choral Rehearsal Room

## **Karaoke**

Come together with students from many other schools for a night of musical karaoke. Get ready to sing anything your heart desires! We will look up karaoke tracks to accompany your song.

**10:00-11:45 pm**

KCPA Studio 2

## **Life-Sized Games**

Have you ever wanted to play a board game but didn't want to sit down? Here is your chance! Join us for a night of oversized board games. Play a giant-sized game of chess or checkers, build a large Jenga tower, and more!

**10:00-11:30 pm**

Illini Union Rec Room  
(Lower Level)

## **Bowling, Billiards, and Video Games**

Just like it sounds . . . Come bowl and play billiards and video games in the Illini Union's Rec Room! There is an additional cost for these activities. Festival name badges must be worn at all times to participate.

**10:00-11:30 pm**

Illini Union South Lounge  
(Main Level)

## **Sponsors' Reception**

The University of Illinois Urbana-Champaign Department of Theatre and the Illinois Theatre Association will host a reception with hors d'oeuvres and beverages. All teachers, sponsors, exhibitors, and workshop leaders are invited to share refreshments and network with peers and members of the Illinois Theatre Association.





# Production Descriptions

**Thurs. 7:30 pm-10:00 pm**  
**Fri. 2:30 pm-5:00 pm**  
**Fri. 7:30 pm-10:00 pm**  
**Sat. 9:30 am-12:00 pm**  
**Sat. 2:00 pm-4:30 pm**  
KCPA Tryon Festival Theatre

**SHREK THE MUSICAL**  
**ALL-STATE PRODUCTION**  
**Music by Jeanine Tesori**  
**Book by David Lindsay-Abaire**  
**Michelle DePasquale Bayer, Director**  
**Katherine Apperson-Skobel and Tom Skobel, Producers**

"Once upon a time, there was a little ogre named Shrek..." And thus begins the tale of an unlikely hero who finds himself on a life-changing journey alongside a wisecracking Donkey and a feisty princess who resists her rescue. Throw in a short-tempered bad guy, a cookie with an attitude and over a dozen other fairy tale misfits, and you've got the kind of mess that calls for a real hero. Luckily, there's one on hand... and his name is Shrek.

**Friday**  
**9:00 am-11:30 am**  
Foellinger Auditorium

**THE ADDAMS FAMILY**  
by Lippa, Marshall and Elice  
**Saint Ignatius College Prep**  
**Kevin Bellie, Director**

*The Addams Family*, a comical feast that embraces the wackiness in every family, features an original story... and it's every father's nightmare: Wednesday Addams, the ultimate princess of darkness, has grown up and fallen in love with a sweet, smart young man from a respectable family- a man her parents have never met. And if that wasn't upsetting enough, Wednesday confides in her father and begs him not to tell her mother. Now, Gomez Addams must do something he's never done before- keep a secret from his beloved wife, Morticia. Everything will change for the whole family on the fateful night they host a dinner for Wednesday's "normal" boyfriend and his parents.

**Friday**  
**9:00 am-10:30 am**  
**11:00 am-12:30 pm**  
KCPA Colwell Playhouse

**THE THEORY OF RELATIVITY**  
Music and Lyrics by Neil Bartram and Book by Brian Hill  
**Lincoln-Way East High School**  
**Patrick Spreadbury & Ann McMann-Kotze, Directors**

This musical from Drama Desk Award nominees Neil Bartram and Brian Hill (*The Story of My Life*), is a joyous and moving look about our surprisingly interconnected lives. Whether you're allergic to cats, in love for the first or tenth time, a child of divorce, a germaphobe or simply a unique individual, audience members and actors alike are sure to find themselves in this fresh new musical. Through a seemingly unrelated collection of songs, scenes and monologues, *The Theory of Relativity* introduces a compelling array of characters experiencing the joys and heartbreaks, the liaisons and losses, the inevitability and the wonder of human connection.

**Friday**  
**9:30 am-10:30 am**  
**11:00 am-12:00 pm**  
KCPA Studio Theatre

**ALICE IN WONDERLAND**  
by Brainerd Dufield (Lewis Carroll)  
**Tinley Park High School**  
**Kathleen O'Connor, Director**

*Alice in Wonderland* is a whimsical, fun journey through Alice's dreams. She encounters kind and selfish characters just as we do in our current lives. She is discovering who she is and developing her voice, as she learns to stand up for herself in the confusing world in which she finds herself. This story is a classic as it withstands the test of time. Every generation brings with it new interpretations which develop from our personal perspectives and life experiences.

## Production Descriptions, continued

**Friday**  
**10:30 am-12:30 pm**  
**1:30 pm-3:30 pm**  
Lincoln Hall Theater

**RADIUM GIRLS**  
by D.W. Gregory  
**Fieldcrest High School**  
**Garilyn Wells, Director**

*Radium Girls* is a fictionalized play based on real events, set in Orange, New York but it could have taken place in Ottawa, Illinois. Dial painters in Orange led a lawsuit against the U.S. Radium Corporation to cover medical bills caused by using the radium paint. Five women who worked in a dial painting plant in Ottawa, led their own lawsuit with the Illinois Industrial Commission. The Illinois lawsuit, settled in 1932, resulted in new occupational labor laws. Workers had training and protective equipment, but radium paint was used until the 1970's. Victims and villains are hard to separate. Dial painters suffered horrible deaths but owners and inventors were not immune from radium poisoning. Profit drove the decisions at the U.S Radium Corporation, instead of scientific research. Even as the companies discovered the effects of radium, they relied on the loyalty and silence of their workers. Money remained more important than the health of workers until protections became law.

**Friday**  
**11:00 am-12:30 pm**  
**1:30 pm-3:00 pm**  
KCPA Foellinger Great Hall

**THE BOMB-ITTY OF ERRORS**  
by Jordan Allen-Dutton, Jason Catalano, Gregory J. Qaiyum, Jeffrey Qaiyum & Erik Weiner  
**Downers Grove North High School**  
**Ariel Mozes, Director**

*The Bomb-Itty of Errors* is an adaptation of Shakespeare's *Comedy of Errors*. It tells the comical story of two sets of twins separated at birth, searching for their missing link. We follow these brothers as they rap and rhyme through the streets of Ephesus, encountering all sorts of bizarre characters, baffling circumstances, and maybe even some romance along the way. You won't want to miss the sick beats, ridiculous humor, and electric energy in this show. This bodacious update of a classic is a fun celebration and parody of the original work combined with fresh, 90s rap and hip hop. Bombitty will make even the biggest Shakespearean haters into iambic beat lovers. Welcome to the BOMB-ITTY!

**Friday**  
**4:00 pm-6:00 pm**  
**7:00 pm-9:00 pm**  
KCPA Colwell Playhouse

**THE PLAY THAT GOES WRONG: HIGH SCHOOL EDITION**  
by Henry Lewis, Jonathan Sayer & Henry Shields  
**Maine East High School**  
**Karen Hall, Director**

Welcome to opening night of the Cornley University Drama Society's newest production, *The Murder at Haversham Manor*, where things are quickly going from bad to utterly disastrous. This 1920s whodunit has everything you never wanted in a show—an unconscious leading lady, a corpse that can't play dead, and actors who trip over everything (including their lines). Nevertheless, the accident-prone thespians battle against all odds to make it through to their final curtain call, with hilarious consequences!

**Friday**  
**1:30 pm-2:00 pm**  
**2:30 pm-3:00 pm**  
**3:30 pm-4:00 pm**  
KCPA Studio Theatre

**SORRY, WRONG NUMBER**  
by Lucille Fletcher  
**Keith Country Day School**  
**Erin Philpott, Director**

A mystery thriller, the tale of a neurotic invalid, whose only contact with the outside world is her phone. She accidentally intercepts a phone call between two men plotting a murder for that evening. Her frantic efforts to enlist the help of telephone operators, the police, and a hospital, but getting nowhere causes her more terror as time passes and she begins to learn the truth. Will she save a life?

## Production Descriptions, continued

**Friday**  
**3:30 pm-6:00 pm**  
**7:30 pm-10:00 pm**  
Foellinger Auditorium

### **CARRIE: THE MUSICAL**

Based on a novel by Stephen King and book by Lawrence D. Cohen  
Music by Michael Gore and lyrics by Dean Pitchford

**Hinsdale South High School**  
**Danny Yuska, Director**

Carrie White is a teenage outcast who longs to fit in. At school, she's bullied by the popular crowd, and virtually invisible to everyone else. At home, she's dominated by her loving, but cruelly controlling mother. What none of them know is that Carrie's just discovered she's got a special power, and if pushed too far, she's not afraid to use it.

**Friday**  
**5:30 pm-6:30 pm**  
KCPA Studio Theatre

### **THE WAR OF THE WORLDS: THE 1938 RADIO SCRIPT**

based on the novel by H.G. Wells  
by Howard E. Koch

**Collinsville High School**  
**Matthew & Sierra Horst, Directors**

Broadcast from New York's Mercury Theatre on Halloween night in 1938, this infamous radio play had many terrified listeners convinced that an actual alien invasion of Earth was taking place.

**Friday**  
**6:30 pm-8:30 pm**  
**Saturday**  
**11:00 am-1:00 pm**  
Lincoln Hall Theater

### **BAD SEED**

by Maxwell Anderson

**Warren Township High School**  
Janice Zimmerman, Director

Our show is focused on the seemingly perfect daughter Rhoda Penmark, who is able to charm her way into getting anything she wants. Everything, except a penmanship medal that has been awarded to Rhoda's classmate, Claude Daigle. During a school outing near the shore, Claude disappears and is soon found drowned near a pier. Christine, Rhoda's mother, begins to think that Rhoda had something to do with the boy's death when she finds Claude's penmanship medal hidden in Rhoda's room. Christine slowly comes to believe that Rhoda was behind other sudden deaths surrounding the family.

**Saturday**  
**9:30 am-12:00 pm**  
**12:30 pm-3:00 pm**  
KCPA Colwell Playhouse

### **SPAMALOT**

by Eric Idle and John DuPrez

**Wauconda High School**  
**Scott Metzger, Director**  
**Jack Holt, Music Director**

Join King Arthur and his Knights as they search for the Holy Grail. Along the way they encounter a variety of characters who attempt to thwart them at every chance, but in the end, they find the grail in themselves and in all of us. Lovingly ripped off from Monty Python and the Holy Grail, this show takes you through all the wit, fart jokes, explosions and coconut halves you expect to see with a few unexpected surprises!

**Saturday**  
**10:00 am-12:00 pm**  
**1:00 pm-3:00 pm**  
Foellinger Auditorium

### **PUFFS OR SEVEN INCREASINGLY EVENTFUL YEARS AT A CERTAIN SCHOOL OF MAGIC AND MAGIC**

by Matt Cox

**Antioch Community High School**  
**Wanda Teddy, Director**

Taking place concurrently with the beloved chronicles of Harry Potter (while also being the definition of a parody), we follow the events at a Certain School of Female and Male Magic in the disregarded house of the Puffs while Potter and his gang of friends are up to their adventures. As the Puffs struggle to be recognized, we follow Wayne, Megan, and Oliver and their increasingly eventful years at the school. From sports events, deaths, trolls, to Russians who breakdance, this play is full of emotional ups and downs. This group of loser Puffs learn why being a Puff is so special, how they are just as important as everybody else, and how everyone is the hero in their own story.

## Production Descriptions, continued

### Saturday

10:00 am-12:00 pm

12:30 pm-2:30 pm

KCPA Foellinger Great Hall

### **AS YOU LIKE IT**

by William Shakespeare

**Lakes Community High School**

**Daniel Esquivel, Director**

Shakespeare's pastoral comedy follows the bold and clever heroine Rosalind as she is exiled from the court. Dragging her cousin Celia along, she disguises herself as Ganymede to begin her new life. She drags them both into a tangled web of switched identities and chaos when they run into the dashing Orlando. Rosalind promptly falls in love with him, but her plans are threatened by a pair of evil brothers and evil dukes trying to keep the lovers apart. This production highlights the queer, comical cast of characters who are in search of the confidence to be who they are and love who they love.

### Saturday

10:00 am-10:30 am

11:00 am-11:30 am

KCPA Studio Theatre

### **MATILDA**

by Roald Dahl and small excerpts from Dennis Kelly and Tim Minchin

**Glenbard East High School**

**Micki Marin-Bunting, Director**

Glenbard East High School's Inaugural Traveling Children's Theatre Troupe is proud to present the 40-minute production of *Matilda* that has been adapted from Roald Dahl's beloved book and short excerpts from the musical book by Dennis Kelly and lyrics by Tim Minchin. The story is about the brilliant Matilda, an extraordinary young girl trying to find where she fits in the world, how to use her special talents, and learn how to stand up for what is right. This production traveled to several of our sending elementary schools performing for over 1,000 young people in our district with the hopes of inspiring future theatre goers and potential actors and creators for our after school program.

**Students, we want your feedback!**  
Share your thoughts about this year's Festival by visiting  
<https://illinoistheatrefest.org> to complete the Festival survey.



# Workshop Descriptions

Find out about updates on workshop cancellations or changes on the Festival app. Also, be sure to follow us on Instagram (@ihstf) or on Facebook (@ Illinois High School Theatre Festival).

## Friday

|  |   |
|--|---|
| <p><b>9:00 am-10:10 am</b><br/><b>10:30 am-11:40 am</b><br/>Gregory Hall 111</p> <p>[D1]</p> | <p><b>Stage Managers are Designers Too!</b><br/><b>Amber Dewey Schultz, Univ. of Illinois Urbana-Champaign</b></p> <p>If you as a Stage Manager or ASM have ever designed a piece of paperwork or figured out a system of communication backstage, you are a designer! Learn the basics of human-centered design to amplify your design skills by better understanding the needs of actors, designers, the director, and crew while also letting go of the perfectionism mindset.</p>   |
| <p><b>9:00 am-10:10 am</b><br/><b>10:30 am-11:40 am</b><br/>Gregory Hall 113</p> <p>[P1]</p> | <p><b>Devising Theatre for Social Change</b><br/><b>Gibson Cima &amp; Tyler Page, Northern Illinois Univ.</b></p> <p>This session focuses on several practical approaches to creating theatre collectively to address social issues of concern. Based on the Theatre of the Oppressed theories of Augusto Boal and the documentary theatre of Anna Deavere Smith, the workshop will help students develop highly marketable skills such as critical thinking, creativity, and collaboration.</p>  |
| <p><b>9:00 am-10:10 am</b><br/><b>10:30 am-11:40 am</b><br/>Illini Union 209</p> <p>[C1]</p> | <p><b>Creating the Spark: Inspiration Boards</b><br/><b>Danielle Silfies &amp; Jane Pivovarnik, Southern Illinois University, Carbondale</b></p> <p>We want to explore the creation of both digital and physical inspiration boards. Our workshop is geared to finding a main theme or idea of a project and finding a way to translate that idea into inspiration board to share with directors and other co-collaborators.</p>  |
| <p><b>9:00 am-10:10 am</b><br/><b>10:30 am-11:40 am</b><br/>Illini Union 404</p> <p>[A1]</p> | <p><b>Upping Your Audition Game</b><br/><b>Lorelei Wernecke &amp; Jimmy Chrismon, Illinois State Univ.</b></p> <p>Auditioning is hard! From finding material to adding your personal flair, it's probably one of the hardest and crucial parts of being a performer. In this workshop you'll learn more about finding repertoire, how to prepare quickly and efficiently, and potentially be individually coached on how to bring your best into the audition room every time.</p>  |
| <p><b>9:00 am-11:30 am</b><br/>Illini Union 215</p> <p>[T1]</p>                              | <p><b>Colors and Your Emotional Link</b><br/><b>Reiko Huffman, Univ. of Illinois Urbana-Champaign</b></p> <p>Students will get the opportunity to understand emotion and its link to design by participating in a basic lesson about the color wheel. Students will get to actively create a wheel that they can take home; but then have the opportunity to think like a designer and create an image based on an emotion that they will have to link to a specific color. Students will gain an understanding in a fundamental design principle, an intro lesson to color theory, and a basic understanding of transforming text into visual communication.</p> |
| <p><b>9:00 am-10:10 am</b><br/><b>10:30 am-11:40 am</b><br/>Illini Union 217</p> <p>[A2]</p> | <p><b>Ensemble Acting on Stage (There's More to See than Just the Lead!) - <del>CANCELED</del></b><br/><b>Cody Rogers, Rowe Middle School</b></p> <p>There's more to see than just the lead. Every actor on stage has an important role to play when it comes to telling the story, even if they don't speak any lines. As an ensemble, we work together to create the environment of the story we are telling. In this workshop, we will be working on how to create fully developed characters in their physicalization, connections to other ensemble members, and how they work together to create the environment they are in on stage.</p>                  |

**A:** Acting & Auditions • **C:** Costuming/Makeup • **D:** Directing/Stage Management • **I:** Instructors/Teachers  
**M:** Movement/Dance/Combat • **P:** Playwriting • **S:** Musical/Vocal • **T:** Technical Theatre • **V:** Improv/Variety



## Friday Morning Workshop Descriptions, continued

|   |  |
|---|--|
| <p><b>9:00 am-10:10 am</b><br/><b>10:30 am-11:40 am</b><br/>Illini Union 314A</p> <p>[V1]</p>   | <p><b>Improv 101: Introduction to Improv Basics</b><br/><b>Patrick Deane, Lockport Township H.S.</b></p> <p>Whether you're a seasoned improviser or never even tried, this is the workshop for you. We'll explore what makes a good comedy scene and what are the keys to never letting down your improv scene partner! Come ready to move and have fun.</p>   |
| <p><b>9:00 am-10:10 am</b><br/><b>10:30 am-11:40 am</b><br/>Illini Union 314B</p> <p>[T2]</p>   | <p><b>Scenic Design: Creating the World of the Play</b><br/><b>Ken Frykholm, Lockport Township H.S.</b></p> <p>It's challenging to create an environment that both services the needs of the play and invites the audience into your creative vision. We will look at various elements such as scale, color, direction, vertical and horizontal space, levels and walls through production shots and drawings. Couple these basics with your imagination and there really are no limits.</p>   |
| <p><b>9:00 am-11:30 am</b><br/>Illini Union 407</p> <p>[M1]</p>   | <p><b>Slaps, Punches, and Falls, (Oh My!): Stage Combat Toolkit for Drama Teachers</b><br/><b>Lily Blouin, Fighting Measure</b></p> <p>In this hands-on workshop, theatre and drama teachers will learn how to safely perform common unarmed combat moves including slaps, chokes, punches, and falls. Working with Certified Stage Combat Instructor Lily Blouin, participants will walk away with a better understanding of the basic principles of stage combat, techniques to keep students safe when performing violence onstage, and explore common mistakes.</p>  |
| <p><b>9:00 am-10:10 am</b><br/><b>10:30 am-11:40 am</b><br/>Illini Union 405</p> <p>[I1]</p>  | <p><b>Consent Based Classrooms</b><br/><b>Jessica Steinrock, Intimacy Directors and Coordinators</b></p> <p>This workshop provides practical tools and vocabulary that instructors can use to engage with high school students regarding applied consent and working with intimate content. We will focus on the foundations of consent and communication, and address the unique challenges and power structures that are found in the high school environment.</p>   |
| <p><b>9:00 am-11:30 am</b><br/><b>12:00 pm-2:30 pm</b><br/>Illini Union Room ABC</p> <p><i>Pre-registration recommended</i></p> <p>[T0]</p> | <p><b>TECH OLYMPICS</b></p> <p>Calling all techies! It is finally time to bring back the Tech Olympics! Register to test your technical skills and see how you measure up to the standards of excellence.</p> <p>The following events will be offered:</p> <ul style="list-style-type: none"> <li>• Costume Change–Solo (Costume)</li> <li>• Hang, Focus, and Strike Lighting Instruments–Team (Lighting)</li> <li>• Strike and Set Up Props–Team (Props)</li> <li>• Tape a Ground Plan–Team (Stage Management)</li> <li>• Leg a Platform–Team (Set Building)</li> <li>• Knot Tying–Solo (Rigging)</li> </ul> <p>The top three competitors will be announced for each event, as well as the top three teams overall.</p> |
| <p><b>9:00 am-11:30 am</b><br/>KCPA AV Room</p> <p>[T3]</p>   | <p><b>Principles of Sound Design in Theatre and Performing Arts</b><br/><b>Richard Scholwin, Univ. of Illinois Urbana-Champaign</b></p> <p>An encompassing overview on what it takes/means to be a sound designer in today's technology filled world of theatre and performing arts venues.</p>  |
| <p><b>9:00 am-10:10 am</b><br/><b>10:30 am-11:40 am</b><br/>KCPA Choral Rehearsal Room</p> <p>[S1]</p>                                      | <p><b>Healthy Belting for Musical Theatre</b><br/><b>Sarah Wigley, Univ. of Illinois Urbana-Champaign</b></p> <p>What IS a "belt" voice in musical theatre and how do we know if we are using it healthily? Come explore the basics of belting with this interactive workshop and discover tactics and tips for more powerful, energized, healthy singing in musical theatre.</p>  |

**A:** Acting & Auditions • **C:** Costuming/Makeup • **D:** Directing/Stage Management • **I:** Instructors/Teachers  
**M:** Movement/Dance/Combat • **P:** Playwriting • **S:** Musical/Vocal • **T:** Technical Theatre • **V:** Improv/Variety

## Friday Morning Workshop Descriptions, continued

|   |  |
|---|--|
| <p><b>9:00 am-11:30 am</b><br/>KCPA Costume Shop</p> <p>[C2]</p>  | <p><b>Costume Gallery</b><br/><b>Rose Kaczmarowski &amp; Andrea Bouck, Univ. of Illinois Urbana-Champaign</b><br/>Visit the Krannert Center Costume Shop to witness a working shop in action. A variety of realized costumes will be on display while designers and staff work to costume upcoming resident productions. Feel free to talk with the staff and students present when you visit!</p>   |
| <p><b>9:00 am-10:10 am</b><br/><b>10:30 am-11:40 am</b><br/>KCPA Drama Rehearsal Room</p> <p>[A7]</p>     | <p><b>All-State 2024—Join the Adventure!</b><br/><b>Nathaniel Haywood, David Morrison, &amp; Jessi Lim, Downers Grove South H.S.</b><br/>Interested in rising to new challenges and participating in next year's Festival All-State production? Come meet the production staff of All-State 2024, where we will discuss the show, characters, and scenic and production elements. Learn about the application process, auditions, portfolio interviews, and what we expect from a member of the All-State cast, crew or pit! Join us for this initial look into a unique All-State experience. It's sure to be unlike any other—come join the fun!</p>   |
| <p><b>9:00 am-10:10 am</b><br/><b>10:30 am-11:40 am</b><br/>KCPA Ensemble B</p> <p>[V2]</p>               | <p><b>Improv: Character and Scene</b><br/><b>Mikel Matthews, Rantoul Township H.S.</b><br/>This workshop will focus on long form improvisational basics that transfer well to scripted material. Strong character and scene choices will be developed.</p>   |
| <p><b>9:00 am-10:10 am</b><br/><b>10:30 am-11:40 am</b><br/>KCPA Orchestra Rehearsal Room</p> <p>[M2]</p> | <p><b>Ballroom Dance Masterclass</b><br/><b>Stephanie Svarz &amp; Jon Stricker, Rolling Meadows H.S.</b><br/>Swing, waltz, and cha cha your way through this fast-paced ballroom dance masterclass. Learn partnering skills and foundational technique to excel in auditions, musical theatre, and social settings. No experience necessary, come in movement clothes!</p>   |
| <p><b>9:00 am-5:40 pm</b><br/>KCPA Scene Shop</p> <p>[T4]</p>   | <p><b>Scene Shop Open House</b><br/><b>Ryan Schultz, Tatsuya Ito, Bobby Reynolds, &amp; Liam Romano, Univ. of Illinois Urbana-Champaign</b><br/>Come stop by the KCPA Scene Shop! We are having an open house throughout the day. Have you ever been interested to see some advanced equipment and practices we use in Scenic Technology? We will have a number of stations set up for hands-on experience.</p>  |
| <p><b>9:00 am-11:30 am</b><br/>KCPA Studio 1</p> <p>[I2]</p>  | <p><b>Evoke, Provoke, Disrupt: Verbatim Performance in Your Classroom</b><br/><b>Britnee Kenyon, Deerfield H.S.</b><br/>Verbatim performance is the precise portrayal of an actual person using their exact speech and gestural patterns. Learn how to use arts-based research to guide your students towards critical engagement with political, cultural, and historical figures and events in new and unexpected ways. In performance, students will build empathy as they step into someone else's shoes in the most accurate sense of the phrase. In investigative research, students will learn how to disrupt systems of oppression and connect with their community on a deeper level.</p> |
| <p><b>9:00 am-10:10 am</b><br/><b>(&amp; Sat: 10:00 am-11:10 am)</b><br/>KCPA Studio 2</p> <p>[M3]</p>    | <p><b>Morning Musical Flow - <del>CANCELED</del></b><br/><b>Natalie Wooden, Belvidere Theatre Company</b><br/>Start Theatre Festival off right with an energizing wake up class to get your blood pumping! We'll sing, dance and strengthen our performing skills all while having fun and building confidence! Not only that, we'll jam to Broadway's Baddest hits and sweat together! <b>REQUIRED:</b> Closed toed shoes / sneakers and moveable clothing.</p>   |

**A:** Acting & Auditions • **C:** Costuming/Makeup • **D:** Directing/Stage Management • **I:** Instructors/Teachers  
**M:** Movement/Dance/Combat • **P:** Playwriting • **S:** Musical/Vocal • **T:** Technical Theatre • **V:** Improv/Variety

## Friday Morning Workshop Descriptions, continued

|  |   |
|--|---|
| <p><b>9:00 am-10:10 am</b><br/><b>10:30 am-11:40 am</b><br/>Levis Center 208</p> <p>[A3]</p>           | <p><b>Creating Character Through Movement</b><br/><b>Adam Miller, Warren Township H.S.</b></p> <p>This workshop will focus on creating unique and distinct characters using movement as our foundation. Using Laban Movement Analysis, and maybe a little contract improv, we'll use our bodies to explore how our physicality can help define our characters and tell our stories.</p>   |
| <p><b>9:00 am-10:10 am</b><br/><b>10:30 am-11:40 am</b><br/>Levis Center 210</p> <p>[A4]</p>           | <p><b>Drugs, Drinking and Rocking That Role</b><br/><b>Susan Patrick Steinfeldt, Souther Illinois Univ., Carbondale</b></p> <p>Stage and Screen of require characters to be under the influence. The performer will be guided in this workshop the technique to a believable drunk and a short introduction into drug impediments.</p>  |
| <p><b>9:00 am-10:10 am</b><br/><b>10:30 am-11:40 am</b><br/>Natural History Bldg 2020A</p> <p>[T5]</p> | <p><b>Creating Fluid Worlds: An Introduction to Projection Design with Isadora</b><br/><b>Brad Carlson, Truman State Univ.</b></p> <p>Come explore some of the ways the software program Isadora can be used to create dynamic interactive projected environments. This workshop will also look at incorporating live video and interfacing with Qlab to create complex designs on a budget.</p>  |
| <p><b>10:00 am-11:10 am</b><br/><b>11:30 am-12:40 pm</b><br/>Gregory Hall 215</p> <p>[S2]</p>          | <p><b>The Authentic Auditioner</b><br/><b>Mitzi Smith, North Central College</b></p> <p>Want to be your most authentic self in auditions? This interactive workshop will focus on emerging equitable practices in musical theatre auditions. Students will learn skills from trusted pedagogies so they can represent themselves confidently and characterize stories with depth and energy. Taught by former Broadway Casting Director, Mitzi Smith.</p>   |
| <p><b>9:00 am-10:10 am</b><br/><b>10:30 am-11:40 am</b><br/>Natural History Bldg 2078</p> <p>[A5]</p>  | <p><b>Improv Scene Work</b><br/><b>Denise Stout &amp; Loridon Krug, Chicago Actor's Studio</b></p> <p>Create Your Own Drama.</p>  |
| <p><b>9:00 am-11:30 am</b><br/><b>12:00 pm-2:30 pm</b><br/>Natural History Bldg 2083</p> <p>[A6]</p>   | <p><b>Shakespeare—Original Practice (Secrets of The First Folio)</b><br/><b>Adam Armstrong, Josh Armstrong, Katie Armstrong, Carrie Florczyk, Christy Furlan, &amp; Isaac Armstrong, Northern Illinois First Folio Theatre Ensemble</b></p> <p>How were the works of Shakespeare first performed? Why is The First Folio so important? Come learn the answers and more. Participants will learn and experience how to read, act, and block using the First Folio Method.</p>  |
| <p><b>1:30 pm-2:40 pm</b><br/>KCPA Drama Rehearsal Room</p> <p>[I3]</p>                                | <p><b>Boosting Your Thespian Troupe</b><br/><b>LaDonna Wilson, Champaign Central H.S.</b></p> <p>Want to do more with your Thespian troupe than just put on plays? Come here some ideas (and share ideas) to help invigorate your program. Strong Thespian troupes build even stronger ensemble work in your productions!</p>   |
| <p><b>1:30 pm-2:40 pm</b><br/>Natural History Bldg 2079</p> <p>[A8]</p>                                | <p><b>The Ins &amp; Outs of Thespys</b><br/><b>Carmel DeStefano, Reavis HS (retired)</b></p> <p>Get acquainted with the many opportunities provided by The International Thespian Society to show your talent! Become aware of the different categories of Performance and Technical Design Individual Events. Learn the requirements as well as "hidden secrets" on how to create a dynamic presentation. This workshop covers the following categories: acting, costuming, stage management, musical, playwriting, &amp; technical theatre.</p> |

**A:** Acting & Auditions • **C:** Costuming/Makeup • **D:** Directing/Stage Management • **I:** Instructors/Teachers  
**M:** Movement/Dance/Combat • **P:** Playwriting • **S:** Musical/Vocal • **T:** Technical Theatre • **V:** Improv/Variety

## Friday Afternoon Workshop Descriptions, continued

|  |  |
|--|--|
| <p><b>1:30 pm-2:40 pm</b><br/> <b>3:00 pm-4:10 pm</b><br/>                 Illini Union 314B</p> <p>[T6]</p> | <p><b>Tech- Tools, Techniques, Tips &amp; Tricks for Scenery</b><br/> <b>Joe Pietrie &amp; Ken Frykholm, St. Charles North H.S.</b></p> <p>This workshop will look at:<br/>                 Essential tools that can save you time and are easy to find and use. How can you reimagine and reuse, what to strike and what to save for the long haul?<br/>                 How to make that Perfect Circle from 24 inches to 36 feet. Different ways to work with foam. Scenic painting tips and tricks. And talk about or work out aspects of a certain show you have or may be dealing with in your space. We want to open the discussion for you to bring your own tips and tricks to share.</p> |
| <p><b>10:30 am-11:40 am</b><br/>                 Illini Union 211</p> <p>[P2]</p>                            | <p><b>Start to Finish: Creating a Show</b><br/> <b>Sheila Furey Sullivan, Chris Budnick, Dylan Young, Linda Thamm, Karoline Corning, Bella Pelini, &amp; Matt Rickey, Victor J. Andrew H.S.</b></p> <p>A student-led, immersive workshop about the creation of a show from its drafting to its performance. Led by writers, directors, producers and stage managers of a recent fall play, this workshop is perfect for anyone interested in finding out more about building their own production.</p>   |
| <p><b>10:30 am-11:40 am</b><br/>                 KCPA Studio 2</p> <p>[M4]</p>                               | <p><b>Freeing The Body Through Movement and Music</b><br/> <b>Dilan Gursoy &amp; Jimmy Chrismon, Illinois State Univ.</b></p> <p>This workshop leads participants through a series of movement exercises that help free the mind, the voice and the body. Inspired by Arthur Lessac's NRGs, we will explore the different ways our bodies can express potency, radiancy, and buoyancy with the greatest tool for authentic movement - music.</p>   |
| <p><b>12:00 pm-1:10 pm</b><br/>                 KCPA Drama Rehearsal Room</p> <p>[I4]</p>                    | <p><b>Taking a Show on the Road</b><br/> <b>LaDonna Wilson, Champaign Central H.S.</b></p> <p>Ever wanted to present a show at IHSTF? or even the International Thespian Festival? Come learn about what it takes to travel with a show and share what you have learned taking a show on the road.</p>   |
| <p><b>12:00 pm-1:10 pm</b><br/>                 Natural History Bldg 2079</p> <p>[T7]</p>                    | <p><b>Present a Winning Tech Portfolio</b><br/> <b>Carmel DeStefano, Reavis HS (retired)</b></p> <p>Learn how to create and present a portfolio that spotlights the "behind the scenes" talents needed to create a powerful production. Find your area of expertise and let it shine! Bring along your portfolio and receive a valuable oral critique!</p>   |
| <p><b>12:00 pm-1:10 pm</b><br/> <b>1:30 pm-2:40 pm</b><br/>                 Gregory Hall 111</p> <p>[A9]</p> | <p><b>Look Here! Creating Focus on the Stage</b><br/> <b>Christine Heckman, Burlington Central H.S.</b></p> <p>Knowing how to create focus onstage helps actors and directors lead the audience through the story and bring the script to life. This workshop will engage actors and directors in skills to show character relationships and bring the onstage environment to life.</p>  |
| <p><b>12:00 pm-1:10 pm</b><br/> <b>1:30 pm-2:40 pm</b><br/>                 Gregory Hall 113</p> <p>[I5]</p> | <p><b>Picking A Master's Program: The Theatre Conservatory At Roosevelt University's MA in Theatre Directing</b><br/> <b>Kristen Mackie &amp; Fast Track Theatre Alumni &amp; Current Students, Chicago College of Performing Arts at Roosevelt Univ.</b></p> <p>The Theatre Conservatory at Roosevelt University offers a Fast Track MA degree in Theatre Directing to serve the needs of highly motivated theatre educators. Come hear Fast Track Theatre Alumni and current Fast Track Theatre students discuss what makes the SUMMER ONLY program so special and how it has impacted their work as a director.</p>   |

**A:** Acting & Auditions • **C:** Costuming/Makeup • **D:** Directing/Stage Management • **I:** Instructors/Teachers  
**M:** Movement/Dance/Combat • **P:** Playwriting • **S:** Musical/Vocal • **T:** Technical Theatre • **V:** Improv/Variety

## Friday Afternoon Workshop Descriptions, continued

|  |  |
|--|--|
| <p><b>12:00 pm-1:10 pm</b><br/> <b>1:30 pm-2:40 pm</b><br/> Gregory Hall 215</p> <p>[I6]</p> | <p><b>Working with Student Stage Managers: A Guide for Teachers and Directors</b><br/> <b>Terri Ciofalo, Univ. of Illinois Urbana-Champaign</b></p> <p>Build effective relationships, reasonable expectations, and a supportive environment to help your stage managers—and your productions—thrive. We'll talk about how to identify student stage managers, paperwork and other tools to help the process, and tips for building healthy production relationships.</p> |
| <p><b>12:00 pm-1:10 pm</b><br/> <b>1:30 pm-2:40 pm</b><br/> Gregory Hall 217</p> <p>[D2]</p> | <p><b>Giving Direction: The Fundamentals of Directing</b><br/> <b>Kyle A. Thomas, Missouri State Univ.</b></p> <p>Directing is an art. It is not only about leadership and collaboration, but about the individual artist's approach to storytelling for the theatre. This workshop will examine three key elements for a director to consider when planning a production.</p>   |
| <p><b>12:00 pm-1:10 pm</b><br/> <b>1:30 pm-2:40 pm</b><br/> Illini Union 210</p> <p>[M5]</p> | <p><b>Musical Theatre Dance—On Your Feet!</b><br/> <b>Laney Rodriguez, Univ. of Illinois Urbana-Champaign</b></p> <p>Come put your salsa skills to the test and learn some choreography to music from On Your Feet! The hit musical featuring some Cuban-fusion by Gloria Estefan and the Miami Sound Machine! You are not gonna want to miss this one!</p>  |
| <p><b>12:00 pm-1:10 pm</b><br/> <b>1:30 pm-2:40 pm</b><br/> Illini Union 211</p> <p>[T8]</p> | <p><b>Scenic Design 101</b><br/> <b>Abigail Simaytis, Farmington Central H.S.</b></p> <p>Welcome stage design beginners to a wonderful workshop of basics in scenic design. Learn how to draw perspective, set your stage and achieve a 3-dimensional look all with a pencil and ruler.</p>  |
| <p><b>12:00 pm-1:10 pm</b><br/> <b>1:30 pm-2:40 pm</b><br/> Illini Union 215</p> <p>[T9]</p> | <p><b>Stage Props 101</b><br/> <b>Christopher Gadowski, Eastern Illinois Univ.</b></p> <p>Come learn about the basics of building, buying, borrowing, or renting props for your shows needs.</p>   |
| <p><b>12:00 pm-1:10 pm</b><br/> <b>1:30 pm-2:40 pm</b><br/> Illini Union 217</p> <p>[P3]</p> | <p><b>How to Write a 10-Minute Play</b><br/> <b>Fr. Dominic Garramone, Saint Bede Academy</b></p> <p>Did you know that the ITA sponsors a 10 Minute Play Festival in the spring? This workshop will demonstrate how you and your friends can create a 10 minute play for the Festival or for your own school. This unique collaborative method uses post-it notes to create a play from scratch, one idea at a time. Share YOUR ideas!</p>                               |
| <p><b>12:00 pm-1:10 pm</b><br/> <b>1:30 pm-2:40 pm</b><br/> Illini Union 404</p> <p>[M6]</p> | <p><b>Musical Theatre Movement!</b><br/> <b>Sophie Reidt &amp; Jimmy Chrismon, Illinois State University</b></p> <p>This workshop is for dancers of any level! Come learn a fun, upbeat and technical dance combination to one of Broadway's biggest hits! Learn about choreography styles and tips/tricks to ace your next dance call. All are welcome!</p>   |
| <p><b>12:00 pm-1:10 pm</b><br/> <b>1:30 pm-2:40 pm</b><br/> Illini Union 405</p> <p>[M7]</p> | <p><b>Introduction to Catfart: The Movement of Low Comedy - <del>CANCELED</del></b><br/> <b>Chris Guyotte, Univ. of Illinois Laboratory H.S.</b></p> <p>Students in this class will learn basic movements used in low comedy. The session will culminate in short scenes enjoyment of the group. Participants should be in comfortable clothing and have a willingness to enjoy the silly. It's a lot of fun with endless applications in theatre performance.</p>       |
| <p><b>12:00 pm-2:30 pm</b><br/> Illini Union 406</p> <p>[I14]</p>                            | <p><b>Building Your Own Play</b><br/> <b>Andrew Rosenblat, Curie Metropolitan H.S.</b></p> <p>Learn how to take ideas and turn them into theatrical works. From stimulus, to script, to production. In this workshop students will write, direct, and perform original pieces created at the workshop. It's fun, it's fast, and it will be a blast.</p>  |

**A:** Acting & Auditions • **C:** Costuming/Makeup • **D:** Directing/Stage Management • **I:** Instructors/Teachers  
**M:** Movement/Dance/Combat • **P:** Playwriting • **S:** Musical/Vocal • **T:** Technical Theatre • **V:** Improv/Variety



## Friday Afternoon Workshop Descriptions, continued

|   |   |
|---|---|
| <p><b>12:00 pm-2:30 pm</b><br/>KCPA AV Room</p> <p>[T10]</p>  | <p><b>What am I Doing Wrong in the World of Tech?</b><br/><b>Marcel Graham, Lake Zurich H.S.</b></p> <p>This workshop is designed to bring you up to speed on what you may have missed during COVID. We will be discussing lighting, sound, and set construction. Wait, did I mention sound? Sound is one of the most misunderstood aspects of theatre and while this isn't a sound class, we do end up covering it extensively. Have your questions ready.</p>   |
| <p><b>12:00 pm-1:10 pm</b><br/><b>1:30 pm-2:40 pm</b><br/>KCPA Studio 1</p> <p>[T11]</p>                | <p><b>Pallet Popping Green Theatre</b><br/><b>Dan Schmidt, Western Illinois Univ.</b></p> <p>As budgets tighten for theatre, embracing green stagecraft techniques can allow you to build your scenery while keeping costs low. Technical Director Dan Schmidt demonstrates how to build and use a pallet popper tool to efficiently turn discarded pallets into usable theatre scenery.</p>  |
| <p><b>12:00 pm-1:10 pm</b><br/><b>1:30 pm-2:40 pm</b><br/>KCPA Choral Rehearsal Room</p> <p>[C3]</p>    | <p><b>Underwear is FUN to Wear!</b><br/><b>Rose Kaczmarowski, Univ. of Illinois Urbana-Champaign</b></p> <p>A presentation and discussion of why under structures or foundation garments are important. There will be examples of historical undergarments and attendees will have the opportunity to try-on under structures including corsets, hoop skirts, and other sundries. We will also discuss and show construction techniques, both traditional and budget substitutions.</p>   |
| <p><b>12:00 pm-1:10 pm</b><br/><b>1:30 pm-2:40 pm</b><br/>KCPA Orchestra Rehearsal Room</p> <p>[V3]</p> | <p><b>Creating an Original Play Via Improv</b><br/><b>Donna Stone (retired)</b></p> <p>Participants, given a scenario, will collaborate with others to create scenes using a variety of drama techniques.</p>   |
| <p><b>12:00 pm-1:10 pm</b><br/><b>1:30 pm-2:40 pm</b><br/>KCPA Ensemble B</p> <p>[V4]</p>               | <p><b>Sketch Me If You Can</b><br/><b>Eric Curtis, Acting Matters</b></p> <p>Sketch comedy is fast-paced and fun. Come join us for a sketch comedy writing and performing intensive! Participants will roll up their sleeves and create several group sketches and will discover why some sketches succeed while others fail.</p>   |
| <p><b>12:00 pm-1:10 pm</b><br/><b>1:30 pm-2:40 pm</b><br/>Levis Center 210</p> <p>[A10]</p>             | <p><b>Embracing the Ensemble - <del>CANCELED</del></b><br/><b>Natalie Wooden, Belvidere Theatre Company</b></p> <p>Ready to craft and blend talents together? In this workshop, students will develop their form to display strong representations that they can sing, dance and act! We'll explore how to build team work, character expression, dialogue, singing and stage presence to take the ensemble to the next level.</p>  |
| <p><b>12:00 pm-1:10 pm</b><br/><b>1:30 pm-2:40 pm</b><br/>Levis Center 208</p> <p>[A11]</p>             | <p><b>Personalizing your Audition Material</b><br/><b>Jessie Craig, The New York Conservatory for Dramatic Arts</b></p> <p>Whether it's upcoming auditions for theatre school, meeting agents or trying to break into the business through open castings, we want to help you personalize your work and let your unique personality shine through. Join us to learn audition techniques and how to best prepare. We'll focus on identifying the important given circumstances of your scene, what does your character want to achieve, and who are you speaking to. Come prepared with a monologue, or work from a cold read if you'd like to be coached.</p> |

**A:** Acting & Auditions • **C:** Costuming/Makeup • **D:** Directing/Stage Management • **I:** Instructors/Teachers  
**M:** Movement/Dance/Combat • **P:** Playwriting • **S:** Musical/Vocal • **T:** Technical Theatre • **V:** Improv/Variety

## Friday Afternoon Workshop Descriptions, continued

|   |   |
|---|---|
| <p><b>12:00 pm-1:10 pm</b><br/> <b>1:30 pm-2:40 pm</b><br/>         Natural History Bldg 2020A</p> <p>[S3]</p>  | <p><b>How Do I Pop/Rock?!</b><br/> <b>Matthew Hougland, Carthage College</b></p> <p>Answers to this question and more will be given during this workshop where participants will PARTY with their best 1-minute Pop/Rock song cut (Hint: It's anything that's ever been on the radio). Bring your music in the key that suits you best; pianist will be provided. ROCK ON!</p>  |
| <p><b>12:00 pm-1:10 pm</b><br/> <b>1:30 pm-2:40 pm</b><br/>         Natural History Bldg 2020B</p> <p>[A12]</p> | <p><b>Cast Me If You Can!</b><br/> <b>Jaclyn Loewenstein, Class Act-Champaign</b></p> <p>What is your Dream Role? How do directors make casting choices? Where do you "fit"? Where do you WANT to fit? In this workshop, we'll explore how gender identity and physical appearance can affect casting—and discover ways you can encourage non-traditional casting, expand your acting range, and learn to audition with confidence!</p>   |
| <p><b>12:00 pm-1:10 pm</b><br/> <b>1:30 pm-2:40 pm</b><br/>         Natural History Bldg 2078</p> <p>[A13]</p>  | <p><b>On-Camera And Self-Taping Auditions</b><br/> <b>Jonathan Frank &amp; Edward Dennis Fogell, Chicago Actor's Studio</b></p> <p>Learn how to master the craft of auditioning for the camera, including techniques like cold-reading a script, slating, self-taping, and creating a unique performance.</p>   |
| <p><b>3:00 pm-4:10 pm</b><br/> <b>4:30 pm-5:40 pm</b><br/>         Gregory Hall 113</p> <p>[I7]</p>             | <p><b>IHSA ANSWERS FOR YOU!</b><br/> <b>Mark Begovich, West Chicago Community HS, Judy Klingner, William Fremd HS (retired), &amp; Carmel DeStefano, Reavis HS (retired)</b></p> <p>The IHSA has NEW opportunities for students and schools! Find out about amazing events and activities that students love. You will leave the workshop with tips, techniques, and tricks to master all the IHSA Drama events: Contest Play, Group Interpretation, Musical Theatre, and Short Film.</p> |
| <p><b>3:00 pm-4:10 pm</b><br/> <b>4:30 pm-5:40 pm</b><br/>         Gregory Hall 215</p> <p>[A14]</p>            | <p><b>Fun with Open Scenes</b><br/> <b>Wendy Taylor, Belvidere North H.S.</b></p> <p>Open scenes can be interpreted in many ways, with different characters, locations, motivations, and genres. We will discuss how actors can use their voice and movement to demonstrate relationships and stories. Pairs will be randomly assigned and actors will get the chance to work with people from other schools.</p>   |
| <p><b>3:00 pm-4:10 pm</b><br/> <b>4:30 pm-5:40 pm</b><br/>         Gregory Hall 217</p> <p>[D3]</p>             | <p><b>Stage Management Teams: The Power of Partnership</b><br/> <b>Maria Miguens, Univ. of Illinois Urbana-Champaign</b></p> <p>Stage Managers don't have to work alone! In this workshop we'll talk about how stage managers and assistant stage managers can work together for a fun and successful production experience. We'll cover tips for good teamwork, paperwork for different jobs, and tools for collaboration.</p>   |
| <p><b>3:00 pm-4:10 pm</b><br/> <b>4:30 pm-5:40 pm</b><br/>         Illini Union 209</p> <p>[C4]</p>             | <p><b>Costume Designing with Music</b><br/> <b>Rebel Mickelson, Western Illinois Univ.</b></p> <p>What better way to start your costume design journey than to learn to design to music? We will explore how music can inspire as well as how an image can guide design. You will render costumes or costume pieces, based on what you hear, see and how that translates into your design.</p>  |
| <p><b>3:00 pm-4:10 pm</b><br/> <b>4:30 pm-5:40 pm</b><br/>         Illini Union 211</p> <p>[V5]</p>             | <p><b>Constructive Improv</b><br/> <b>Spencer Ferguson, Illinois State Univ.</b></p> <p>We will be using improv to develop an individual's ability to trust the choices of their fellow scene partners in a scene to confidently craft a scene that has both conflict and comedy.</p>   |

**A:** Acting & Auditions • **C:** Costuming/Makeup • **D:** Directing/Stage Management • **I:** Instructors/Teachers  
**M:** Movement/Dance/Combat • **P:** Playwriting • **S:** Musical/Vocal • **T:** Technical Theatre • **V:** Improv/Variety

## Friday Afternoon Workshop Descriptions, continued

|  |   |
|--|---|
| <p><b>3:00 pm-4:10 pm</b><br/><b>4:30 pm-5:40 pm</b><br/>KCPA Ensemble A</p> <p>[S4]</p>               | <p><b>16-32 Bar Cut Vocal/Acting Coaching</b><br/><b>Stacy Cunningham, Leyden H.S., &amp; LaDonna Wilson, Champaign Central HS</b><br/>Participants should arrive with a 16-32 bar cut of musical theater song. Participants will be invited to sing their cut and receive feedback from a vocal coach &amp; an acting coach. We will touch on marking cuts in music, communication with the accompanist, slating, song choice and we will give individual feedback on your performance. We look forward to hearing YOU sing!</p>   |
| <p><b>3:00 pm-4:10 pm</b><br/><b>4:30 pm-5:40 pm</b><br/>KCPA Drama Rehearsal Room</p> <p>[T12]</p>    | <p><b>Technical Theatre and Curricular Development</b><br/><b>Dana Taylor, Dana W. Taylor Consulting, LLC</b><br/>The workshop will focus on clear and logical steps to organize your technical theatre instruction. From tool basics to topics and instructional sequences, the presenter will share resources, methodologies, and tools for defining and refining your curriculum.</p>  |
| <p><b>3:00 pm-4:10 pm</b><br/><b>4:30 pm-5:40 pm</b><br/>KCPA Studio 1</p> <p>[M8]</p>                 | <p><b>Choreographing to Delight the Director and Capture the Dancer</b><br/><b>Matthew Williams, Southern Illinois Univ., Carbondale</b><br/>Taught by Broadway Choreographer and Professor of Theater and Dance at SIU Carbondale, Matthew Williams, this workshop is designed for the emerging choreographer of theater. It is a masterclass in techniques to create dynamic movement that both satisfies the directorial vision AND the keep the dancer engaged. This workshop will ignite the creative impulse, organize the movement, and steer the dance toward the spine of the scene.</p> |
| <p><b>3:00 pm-4:10 pm</b><br/><b>4:30 pm-5:40 pm</b><br/>Levis Center 208</p> <p>[A15]</p>             | <p><b>I Want I Want, I Need I Need: Exploring Dramatic Action in a Physical and Fun Way</b><br/><b>Elizabeth Parks, Univ. of Wisconsin-Stevens Point</b><br/>The heart of the actors work rest in pursuing their objective and using tactics and intentions to do so. Through game-play and structured exercises we will explore ways to physically explore these things in any given play.</p>   |
| <p><b>3:00 pm-4:10 pm</b><br/><b>4:30 pm-5:40 pm</b><br/>Meet at Fest HQ in KCPA Lobby</p> <p>[I8]</p> | <p><b>Scene Shop Safety: No Longer a Fairy Tale</b><br/><b>Jaclyn Aldridge &amp; Joel Danowitz (owner), Grit Automation, Inc.</b><br/>A safe and functional scene shop is an important part of any high school theatre department. Tour the Krannert Center for the Performing Arts; the first scene shop to operate with GRIT Automation technology which allows tool-level access control. See how to safely manage a shop with student users and give their teachers peace of mind.</p>  |
| <p><b>3:00 pm-4:10 pm</b><br/><b>4:30 pm-5:40 pm</b><br/>Natural History Bldg 2020A</p> <p>[A16]</p>   | <p><b>Shakespeare: Text in Action!</b><br/><b>Vincent Carlson, Univ. of Illinois Urbana-Champaign</b><br/>Shakespeare's plays work best out loud and in the body. Participants will be led through an active workshop that unlocks Shakespeare's text: clues, conventions, and techniques for acting. They will be able to uncover the meaning behind the phrases and given the opportunity to put what they are learning into action in their body. Scene and monologues will be explored. No preparation or prior experience needed.</p>  |
| <p><b>3:00 pm-4:10 pm</b><br/><b>4:30 pm-5:40 pm</b><br/>Natural History Bldg 2020B</p> <p>[S5]</p>    | <p><b>Acting The Song</b><br/><b>Deborah Hill, Ball State Univ.</b><br/>Are you ready to take a song or audition cut to the next level? Bring your song or cut to Acting The Song and take a deep dive into the story you want to tell. Please bring accompaniment tracks. Bluetooth speaker will be provided.</p>  |
| <p><b>9:00 am-10:10 am</b><br/><b>10:30 am-11:40 am</b><br/>Natural History Bldg 2079</p> <p>[I9]</p>  | <p><b>Engaging LGBTQ+ Youth Experiences Onstage</b><br/><b>Andy Waldron, Ball State Univ.</b><br/>This session will examine ways to present LGBTQ+ identities and stories onstage, discuss methods of integrating the content into the curriculum, and will share resources for finding queer youth plays.</p>  |

**A:** Acting & Auditions • **C:** Costuming/Makeup • **D:** Directing/Stage Management • **I:** Instructors/Teachers  
**M:** Movement/Dance/Combat • **P:** Playwriting • **S:** Musical/Vocal • **T:** Technical Theatre • **V:** Improv/Variety

## Friday Afternoon Workshop Descriptions, continued

|   |  |
|---|--|
| <p><b>3:00 pm-4:10 pm</b><br/> <b>4:30 pm-5:40 pm</b><br/>         Natural History Bldg 2079</p> <p>[A18]</p> | <p><b>Puppet Manipulation 101</b><br/> <b>Andy Waldron, Ball State Univ.</b></p> <p>Join us for a hands-on workshop exploring ways to bring to life a variety of one-person and multi-person puppets. Be ready to work together and activate scenes in fun and new ways.</p>   |
| <p><b>3:00 pm-4:10 pm</b><br/> <b>4:30 pm-5:40 pm</b><br/>         Natural History Bldg 2083</p> <p>[A19]</p> | <p><b>Theatrical Style: More Real than Realism!</b><br/> <b>Tim Mooney, Timothy Mooney Repertory Theatre</b></p> <p>Tim Mooney shares exercises and games from his book, <i>Acting at the Speed of Life: Conquering Theatrical Style</i>, connecting Shakespeare to Moliere to Jerry Springer, in a more-or-less straight line, using scenes from <i>Hamlet</i>, <i>The Misanthrope</i> and <i>The Bourgeois Gentleman</i>. Your asides will never be the same!</p>  |
| <p><b>3:00 pm-5:30 pm</b><br/>         Gregory Hall 111</p> <p>[P4]</p>                                       | <p><b>Playful Theatre: Designing Immersive Adventures</b><br/> <b>Amber Dewey Schultz, Univ. of Illinois Urbana-Champaign</b></p> <p>A branch of immersive theatre, playful theatre incorporates game elements into performance. In this practical workshop, learn how to combine LARP, board game mechanics, and theatrical elements to create thrilling adventures for today's experience-driven audience.</p>   |
| <p><b>3:00 pm-5:30 pm</b><br/>         Illini Union 217</p> <p>[A20]</p>                                      | <p><b>Performing Shakespeare—Unrehearsed!</b><br/> <b>Lily Blouin, Fighting Measure</b></p> <p>Guided by Bill Kincaid's work of the same name, this interactive workshop will explore a different approach to producing and performing Shakespeare. Using the tools and techniques of unrehearsed practitioners, participants will work through famous Shakespeare scenes and discover a fun new way to tackle the bard.</p>   |
| <p><b>3:00 pm-5:30 pm</b><br/>         Illini Union 404</p> <p>[M9]</p>                                       | <p><b>Provoking Presence</b><br/> <b>Brennan Roach, Jones College Prep, NHSI (cherubs)</b></p> <p>This workshop teaches and uses the vocabulary of the viewpoints as a catalyst for ensemble growth, bringing presence to the moment, adding layers of possibility to movement on the stage. Participants will look at strengths of this practice as both an ensemble building tool as well as a means of generating a shared movement vocabulary for creating dynamic movement quickly as a cast.</p>   |
| <p><b>3:00 pm-4:10 pm</b><br/> <b>4:30 pm-5:40 pm</b><br/>         Illini Union 406</p> <p>[I15]</p>          | <p><b>I Teach or Will Teach Theater, What the Heck Do I Do?</b><br/> <b>Andrew Rosenblat, Curie Metropolitan H.S.</b></p> <p>Come learn and take with you ACTUAL lessons, scripts, unit plans, assessments and anything else theatre arts related. We will cover some lessons, the how to and answer anything else you got!</p>  |
| <p><b>3:00 pm-5:30 pm</b><br/>         KCPA AV Room</p> <p>[T13]</p>  | <p><b>How to Use a Performance Space to Generate Income</b><br/> <b>Marcel Graham, Lake Zurich H.S.</b></p> <p>Pre-pandemic the PAC at Lake Zurich High School was booked for 100% of rentable dates every year and has a staff of only 1 full time adult, 1 part-time adult, 5 students, and can generate \$130,000.00 a year in rental income. We generate \$130,000.00 a year in rental income. How do we handle the workload? What equipment do we have to offer? What does our application look like? How can I convince my administration that this is worth looking into? Join us for the discussion.</p> |
| <p><b>3:00 pm-5:30 pm</b><br/>         KCPA Choral Rehearsal Room</p> <p>[C5]</p>                             | <p><b>Mixed Media Costume Design</b><br/> <b>Rose Kaczmarowski &amp; Hannah Haverkamp, Univ. of Illinois Urbana-Champaign</b></p> <p>From a brief scenario, you will be guided through the costume design process. Conceptualize, choose a palette, brainstorm, and then develop a character while considering tropes, archetypes, and subversion. Using fabric swatches and other media, actively create a mixed media rendering, of one or two characters within the scenario.</p>   |

**A:** Acting & Auditions • **C:** Costuming/Makeup • **D:** Directing/Stage Management • **I:** Instructors/Teachers  
**M:** Movement/Dance/Combat • **P:** Playwriting • **S:** Musical/Vocal • **T:** Technical Theatre • **V:** Improv/Variety

## Friday Afternoon Workshop Descriptions, continued

|   |  |
|---|--|
| <p><b>3:00 pm-5:30 pm</b><br/>KCPA Ensemble B</p> <p>[V6]</p> | <p><b>Fiasco: Long Form Improv</b><br/><b>Mikel Matthews, Rantoul Township H.S.</b></p> <p>The Fiasco is a long form adapted from an RPG about people with “Powerful Ambition and Poor Impulse Control” by Jason Morningstar. It’s an extended tag out that’s created via random items off a specific playset. It’s Coen Brothers: The Movie Improv.</p> |
|---|--|

## Saturday

|  |  |
|--|--|
| <p><b>10:00 am-11:10 am</b><br/><b>11:30 am-12:40 pm</b><br/>Gregory Hall 111</p> <p>[I10]</p> | <p><b>Welcome to the Jungle: Personalities in Your Classroom, Theatre Program, and Beyond</b><br/><b>Wesley Skym, South Middle School</b></p> <p>A workshop for students AND teachers/instructors dedicated to better understanding your personality, as well as working to understand the personalities of others that we may work with. We will take a special personality quiz, work together to create posters, and discuss how personality affects ensemble and group work. Teachers: bring a few students with you!</p>  |
| <p><b>10:00 am-11:10 am</b><br/><b>11:30 am-12:40 pm</b><br/>Gregory Hall 113</p> <p>[D6]</p>  | <p><b>Making <i>The Play That Goes Wrong</i> Go Right - CANCELED</b><br/><b>Karen Hall, Jessica Mitilineos, &amp; Briana Niven, Maine East H.S.</b></p> <p>Come learn how we brought the new <i>The Play That Goes Wrong: High School Edition</i> to the stage! This amazing farce might seem intimidating with all of the technical elements and stage combat elements AND helping your actors with all of the play within the play comedy. We can share how we made it work! There was a lot of hard work but we can help you with your technical and acting questions.</p>  |
| <p><b>10:00 am-11:10 am</b><br/><b>11:30 am-12:40 pm</b><br/>Gregory Hall 217</p> <p>[D4]</p>  | <p><b>Dominance and Directing - CANCELED</b><br/><b>Chris Guyotte, Univ. of Illinois Laboratory H.S.</b></p> <p>In every interaction, there is a dominant person. In this workshop participants will explore how characters can assert dominance through position, action, or intention. We will discuss how triangulation makes for interesting stage pictures. Further we will explore how costume choices offer clues to a character’s dominance or submissiveness. These techniques can help directors create stage pictures that augment the script and support character choices. This class is great for directors, actors and designers.</p>   |
| <p><b>10:00 am-11:10 am</b><br/><b>11:30 am-12:40 pm</b><br/>Illini Union 210</p> <p>[A22]</p> | <p><b>Jumpstart into Acting</b><br/><b>Sam Harvey, AMDA College of the Performing Arts</b></p> <p>In this workshop, Sam Harvey will walk students through the importance of a physical and vocal warm up to prepare the actor for the days work. Once warmed up, we will explore the basics of acting through provided scenes. All students will have an opportunity to discuss and analyze the scene as a class. Several students will even have an opportunity to demonstrate the scene as we all work together to create the circumstances and world of the scene. The goal of this workshop is to create a safe environment for new actors to explore the basics of acting emphasizing moment-to-moment truthfulness, and preparing the actor for scene study.</p> |

**A:** Acting & Auditions • **C:** Costuming/Makeup • **D:** Directing/Stage Management • **I:** Instructors/Teachers  
**M:** Movement/Dance/Combat • **P:** Playwriting • **S:** Musical/Vocal • **T:** Technical Theatre • **V:** Improv/Variety



## Saturday Morning Workshop Descriptions, continued

|  |   |
|--|---|
| <p><b>10:00 am-11:10 am</b><br/><b>11:30 am-12:40 pm</b><br/>Illini Union 211</p> <p>[I11]</p>                           | <p><b>Connected Arts Network—Connecting DEI, SEL, and Standards to Enrich Your Classroom</b><br/><b>Joselyn Ludtke &amp; Elizabeth Bowman, Connected Arts Network (CAN) Grant &amp; EdTA</b><br/>Join members of the EdTA Connected Arts Network (CAN) to explore the connections between Social-Emotional Learning (SEL), Diversity, Equity, and Inclusion (DEI), and the 2014 National Theatre Core Arts Standards. In this active workshop, we will utilize a Professional Learning Community (PLC) to dialogue with one another, reflect on teaching practice, and consider new approaches to serve students in the classroom. Additionally, you will learn how to become a part of this innovative national project!</p> |
| <p><b>10:00 am-11:10 am</b><br/><b>11:30 am-12:40 pm</b><br/>Illini Union 215</p> <p>[T14]</p>                           | <p><b>Start Designing Fast with Sketchup Free Online</b><br/><b>Martin McClendon, Carthage College</b><br/>Unlock the power of Sketchup, the easy-to-learn software that will make designing and drafting plans so much easier. Participants will start by measuring and designing the workshop room to see just how easy it is! Bring a charged laptop with you.</p>   |
| <p><b>10:00 am-11:10 am</b><br/><b>11:30 am-12:40 pm</b><br/>Illini Union 217</p> <p>[C6]</p>                            | <p><b>Designing Through the Decades (Costume Design)</b><br/><b>Ellie Paulsen &amp; Jimmy Chrismon, Illinois State Univ.</b><br/>In Designing Through the Decades, you will learn how to design costumes for specific time periods! Approaching new design concepts in order to give life to classic/beloved characters.</p>  |
| <p><b>10:00 am-11:10 am</b><br/><b>11:30 am-12:40 pm</b><br/>Illini Union 403</p> <p>[A23]</p>                           | <p><b>Viewpoints 101, The Sixth Sense</b><br/><b>Lisa Wipperling, Western Illinois Univ.</b><br/>This introduction to the Viewpoints will explore spacial and relational awareness, using participant interactions and dialogue based on their experiences within the room. The hope is to build more participant awareness in order to apply this sensitivity to scene work and show processes moving forward.</p>   |
| <p><b>10:00 am-11:10 am</b><br/><b>11:30 am-12:40 pm</b><br/>Illini Union 407</p> <p>[T15]</p>                           | <p><b>The BACKstage Exam: Measuring High School Tech Success</b><br/><b>Dana Taylor, Dana W. Taylor Consulting, LLC</b><br/>Developed by USITT and EdTA, The BACKstage Exam is a comprehensive examination designed for high school technical theatre students. Covering eight disciplines, the test is designed to measure a student's technical understanding and work readiness. The exam not only measures student understanding but also provides guidance for curriculum content.</p>   |
| <p><b>10:00 am-11:10 am</b><br/><b>11:30 am-12:40 pm</b><br/>Illini Union Ballroom (2<sup>nd</sup> Flr)</p> <p>[M10]</p> | <p><b>Weaponed Stage Combat: Safety's the Thing</b><br/><b>Tim Frawley, Forte Stage Combat, Inc.</b><br/>The safe and theatrically realistic use of swords, daggers, and knives will be demonstrated. Particular focus will be placed on the use of "found" weapons.</p>  |
| <p><b>10:00 am-11:10 am</b><br/><b>11:30 am-12:40 pm</b><br/>Illini Union Room A</p> <p>[M11]</p>                        | <p><b>Dancing with Intention: Motivation in Movement</b><br/><b>Amy Lyn McDonald, Elmhurst Univ.</b><br/>Do you fancy yourself a dancer who acts or an actor who dances? "What is my motivation?" is not a question to be answered only by actors! Learn how to successfully synthesize these skills and become a more expressive and potent dancer! All skill levels welcome! Let those bodies emote!</p>  |

**A:** Acting & Auditions • **C:** Costuming/Makeup • **D:** Directing/Stage Management • **I:** Instructors/Teachers  
**M:** Movement/Dance/Combat • **P:** Playwriting • **S:** Musical/Vocal • **T:** Technical Theatre • **V:** Improv/Variety

## Saturday Morning Workshop Descriptions, continued

|  |   |
|--|---|
| <p><b>10:00 am-11:10 am</b><br/><b>11:30 am-12:40 pm</b><br/>Illini Union Room C</p> <p>[A24]</p>          | <p><b>Wings and Capes and Tails, Oh My!</b><br/><b>Bethany Mangum-Oles &amp; Julia Escobedo-Prieto, Northern Illinois Univ.</b></p> <p>This session is all about confidence and energy! Students will learn how to build some brief physical language for walking into an audition and/or interview to show their best (and most protected) selves. This session is useful for those looking for a way to be more present, centered, and sure of themselves when entering a situation where nerves may be high.</p>                                 |
| <p><b>10:00 am-11:10 am</b><br/><b>11:30 am-12:40 pm</b><br/>ISR Seminar Room 93</p> <p>[A25]</p>          | <p><b>The Perks of Getting a BA in Theatre Studies</b><br/><b>Gibson Cima, Northern Illinois Univ.</b></p> <p>We'll discuss the pros and cons of the liberal arts education offered by a Bachelor of Arts in Theatre Studies degree.</p>  |
| <p><b>10:00 am-11:10 am</b><br/><b>11:30 am-12:40 pm</b><br/>KCPA Choral Rehearsal Room</p> <p>[C7]</p>    | <p><b>Careers in Costumes!</b><br/><b>Rose Kaczmarowski, Univ. of Illinois Urbana-Champaign</b></p> <p>What jobs can you get with an undergraduate degree in costumes? Come to this session to find out! Do you like designing? Do you like making things? Do you like the energy of live performance? Let's talk about how you can take your energy and love of costume to the next level and make a living.</p>   |
| <p><b>10:00 am-12:30 pm</b><br/>KCPA Ensemble A</p> <p>[S6]</p>  | <p><b>Jump into <i>The Addams Family</i></b><br/><b>Maggie Marlin-Hess &amp; Matthew Vala, Illinois State Univ.</b></p> <p>Learn the music, choreography, and staging for "When You're an Addams" with Dr. Matthew Vala and Maggie Marlin-Hess. Bring your energy and your mysterious and spooky ancestor acting choices. We'll put it all together for a workshop performance practicing effective and successful rehearsal and performance techniques.</p>  |
| <p><b>10:00 am-11:10 am</b><br/><b>2:30 pm-3:40 pm</b><br/>KCPA Light Lab</p> <p>[T16]</p>                 | <p><b>Color Theory for the Stage</b><br/><b>Robert Perry, Univ. of Illinois Urbana-Champaign</b></p> <p>This is a visual workshop discussing ideas behind color theory with demonstrations using a full scale lighting lab with live subjects and various scenic fabrics.</p>   |
| <p><b>10:00 am-11:10 am</b><br/><b>11:30 am-12:40 pm</b><br/>KCPA Orchestra Rehearsal Room</p> <p>[V7]</p> | <p><b>Improv: Fight Your Fear... and Win!</b><br/><b>George Cederquist, North Park Univ.   School of Music, Art, and Theatre</b></p> <p>Discover five keys to bold improvisation and how they can be used across the performing arts. Each scheduled session tackles a different aspect of improv, so be sure to sign up for multiple sessions. Have fun! Learn stuff! Fight evil! Eat kale!</p>  |
| <p><b>10:00 am-3:40 pm</b><br/>KCPA Scene Shop</p> <p>[T17]</p>  | <p><b>Scene Shop Open House</b><br/><b>Ryan Schultz, Tatsuya Ito, Bobby Reynolds, &amp; Liam Romano, Univ. of Illinois Urbana-Champaign</b></p> <p>Come stop by the KCPA Scene Shop! We are having an open house throughout the day. Have you ever been interested to see some advanced equipment and practices we use in Scenic Technology? We will have a number of stations set up for hands-on experience.</p>  |
| <p><b>10:00 am-11:10 am</b><br/><b>11:30 am-12:40 pm</b><br/>KCPA Studio 1</p> <p>[M12]</p>                | <p><b>Athletic Strength/Conditioning and Musical Theatre Choreography</b><br/><b>Larry Cox, Jr., Eastern Illinois Univ.</b></p> <p>The workshop will be a high-level, physical strength and conditioning training that will enhance the musical theatre body. It will focus on developing the performer's strength, stamina, perseverance, and performance levels. The class will teach full-body warm-up skills followed by strengthening areas of the body needed to support the dancer demands and ending with musical theatre choreography.</p> |

**A:** Acting & Auditions • **C:** Costuming/Makeup • **D:** Directing/Stage Management • **I:** Instructors/Teachers  
**M:** Movement/Dance/Combat • **P:** Playwriting • **S:** Musical/Vocal • **T:** Technical Theatre • **V:** Improv/Variety

## Saturday Morning Workshop Descriptions, continued

|  |   |
|--|---|
| <p><b>10:00 am-11:10 am</b><br/><b>(&amp; Fri: 9:00 am-10:10 am)</b><br/>KCPA Studio 2</p> <p>[M13]</p>  | <p><b>Morning Musical Flow - <i>CANCELED</i></b><br/><b>Natalie Wooden, Belvidere Theatre Company</b><br/>Start Theatre Festival off right with an energizing wake up class to get your blood pumping! We'll sing, dance and strengthen our performing skills all while having fun and building confidence! Not only that, we'll jam to Broadway's Baddest hits and sweat together!<br/>REQUIRED: Closed toed shoes/sneakers and moveable clothing.</p>   |
| <p><b>10:00 am-11:10 am</b><br/><b>11:30 am-12:40 pm</b><br/>Natural History Bldg 2020A</p> <p>[S7]</p>  | <p><b>Self-Tape Auditions: Acting &amp; Musical Theatre (A Casting Director's Perspective)</b><br/><b>Joey Zangardi-Dixon, New York Film Academy College of Visual and Performing Arts</b><br/>This Performance Workshop will focus on Self-Tapes of Musical Theatre Songs and Contemporary Monologues from an "Audition/Casting" perspective. – Auditions are different now! Recording an audition can be overwhelming, different from auditioning in person, and will present new sets of challenges for even the most experienced performer. Whether auditioning for a College or a Professional Role, the ability to produce a strong Audition Self-Tape is an essential skill.<br/>Having worked in casting, as an agent, and hosting countless auditions, my goal is to provide you with the essential tools to a successful self-recorded audition while showing off your voice, your acting-chops, and your ability to tell a compelling story to make a lasting impression.<br/>** I am looking for volunteers—please bring contemporary monologues and musical theatre songs with backing tracks to perform. **</p> |
| <p><b>10:00 am-11:10 am</b><br/><b>11:30 am-12:40 pm</b><br/>Natural History Bldg 2020B</p> <p>[T18]</p> | <p><b>Projection Design for Live Performance</b><br/><b>John Boesche, Univ. of Illinois Urbana-Champaign</b><br/>Learn the aesthetics and techniques of projection design for theatre and dance. We will explore basic techniques of crafting digital images and use them to produce striking virtual scenery and special effects on stage. The presentation is centered around the use of affordable software for show control of digital images.</p>  |
| <p><b>10:00 am-11:10 am</b><br/><b>11:30 am-12:40 pm</b><br/>Natural History Bldg 2078</p> <p>[A26]</p>  | <p><b>Shakespeare Monologue</b><br/><b>Bart Williams, Southeast Missouri State Univ.</b><br/>Acquire techniques to learn a Shakespeare monologue.</p>   |
| <p><b>10:00 am-12:30 pm</b><br/>Natural History Bldg 2079</p> <p>[A27]</p>                               | <p><b>International Thespian Excellence Awards (Thespys)</b><br/><b>Carmel DeStefano, Reavis HS (retired)</b><br/>Present your performance or tech presentation for formal adjudication. This session will act as the prerequisite for the Thespys adjudication at the International Thespian Festival this June at the University of Indiana. Preregistration required to present. Observers welcomed. Categories: acting, costume, stage management, musical, playwriting, set, lights, and/or sound design, technical theatre</p>  |
| <p><b>10:00 am-12:30 pm</b><br/>Natural History Bldg 2083</p> <p>[P5]</p>                                | <p><b>Got an Hour? Write a Play!</b><br/><b>Diana Grisanti, Ball State Univ.</b><br/>In this workshop, we'll explore some tips and tricks for writing a short play. We'll brainstorm, then we'll write, then we'll perform each other's work out loud. "What if I've never written anything before?" That's okay! "What if I've already written 1000 plays?" That's okay too! Playwriting is iterative. The more you do it, the better you get. Let's practice together!</p>  |

**A:** Acting & Auditions • **C:** Costuming/Makeup • **D:** Directing/Stage Management • **I:** Instructors/Teachers  
**M:** Movement/Dance/Combat • **P:** Playwriting • **S:** Musical/Vocal • **T:** Technical Theatre • **V:** Improv/Variety

## Saturday Morning Workshop Descriptions, continued

|  |   |
|--|---|
| <p><b>11:30 am-2:00 pm</b><br/>KCPA Light Lab</p> <p>[T19]</p>                             | <p><b>The Art of Lighting the Stage</b><br/><b>Robert Perry, Univ. of Illinois Urbana-Champaign</b></p> <p>Using a 6:1 scale mini light lab where we will explore the many ways to light a stage, including lessons in intensity, color theory, distribution, cueing, dramaturgy, and script analysis. Workshop attendees will be able to create their own looks based on scenarios discussed within the session using the EOS Nomad software.</p>  |
| <p><b>11:30 am-12:40 pm</b><br/>KCPA Studio 2</p> <p>[M14]</p>                             | <p><b>Space Walk</b><br/><b>JP Lockwood &amp; Jimmy Chrismon, Illinois State Univ.</b></p> <p>A participatory workshop for actors who want to explore the way that their emotions, characters, and situations can believably affect the way they walk and ll the space around them on stage. This workshop involves walking around the space for long periods of time.</p>  |
| <p><b>1:00 pm-2:10 pm</b><br/><b>2:30 pm-3:40 pm</b><br/>Gregory Hall 111</p> <p>[I12]</p> | <p><b>Debuting a World Premiere with Teatro Leyden</b><br/><b>Frank Bavone, Leyden H.S.</b></p> <p>This workshop will cover the unique experience of a high school theater company producing a world premiere. A rare opportunity for anyone in theatre especially high school students, Teatro Leyden was uniquely and intimately involved with the creation of a world premiere, workshoping , reading , providing invaluable insight and feedback gaining an experience very few ever get.</p>   |
| <p><b>1:00 pm-2:10 pm</b><br/><b>2:30 pm-3:40 pm</b><br/>Gregory Hall 217</p> <p>[D5]</p>  | <p><b>Tick Tock Time's Up: Time Management Techniques for your Terrifying To-Do List</b><br/><b>Cynthia Kocher, Univ. of Illinois Urbana-Champaign</b></p> <p>Working in theatre can be stressful with long hours and a never-ending to-do list! How do you balance it all? Learn some easy time management strategies to help you successfully get through your day. This workshop is for anyone who wants to improve their time management skills.</p>  |
| <p><b>1:00 pm-2:10 pm</b><br/><b>2:30 pm-3:40 pm</b><br/>Illini Union 209</p> <p>[A28]</p> | <p><b>Jump Rope Acting</b><br/><b>Todd Quick, Monmouth College</b></p> <p>Actors explore the many lessons found in a simple playground activity—jumping over a rope. Through a series of increasingly complex exercises, actors will grapple with fundamental truths of the stage while getting a great physical warm-up! This is a physical workshop, so please be dressed to move.</p>  |
| <p><b>1:00 pm-2:10 pm</b><br/><b>2:30 pm-3:40 pm</b><br/>Illini Union 211</p> <p>[A29]</p> | <p><b>The Art of the Self-Tape: Nail That Audition!</b><br/><b>Mark Cabus, Ball State Univ.</b></p> <p>More and more, casting directors and agents—not to mention colleges and universities—are asking actors to tape themselves rather than meeting in person. Unfortunately, while there are industry standards, few are skilled in those guidelines. As a professional actor of both stage and screen, I teach these methods to my students and am prepared to share them with yours using language and techniques accessible to all skill levels.</p> |
| <p><b>1:00 pm-2:10 pm</b><br/><b>2:30 pm-3:40 pm</b><br/>Illini Union 215</p> <p>[C8]</p>  | <p><b>Create a Neck Ruff</b><br/><b>Anthony Sirk, Purdue Univ.</b></p> <p>Join me as I teach students how to create an Elizabethan Era neck ruff.</p>   |

**A:** Acting & Auditions • **C:** Costuming/Makeup • **D:** Directing/Stage Management • **I:** Instructors/Teachers  
**M:** Movement/Dance/Combat • **P:** Playwriting • **S:** Musical/Vocal • **T:** Technical Theatre • **V:** Improv/Variety

## Saturday Afternoon Workshop Descriptions, continued

|   |  |
|---|--|
| <p><b>1:00 pm-2:10 pm</b><br/><b>2:30 pm-3:40 pm</b><br/>Illini Union 217</p> <p>[T20]</p>    | <p><b>Simple Machines-Problem Solvers</b><br/><b>Richard Arnold, Jr. &amp; Mikayla Miracle, College of DuPage</b></p> <p>Simple machines can be used to solve scenic dilemmas. "How can I move that piano downstage?" "How can I get from one scene to another quickly?" "How do I get that actor down easily?" These and other questions can be answered with the use of simple machines. This workshop is a hands-on introduction to what simple machines are, how they work and how they can be problem solvers.</p>  |
| <p><b>2:30 pm-3:40 pm</b><br/>Illini Union 403</p> <p>[I13]</p>                               | <p><b>So You Want To Be A Theatre Teacher</b><br/><b>Jimmy Chrismon, Illinois State Univ.</b></p> <p>A panel discussion with current theatre education majors and theatre education professor from Illinois State University discuss what it takes to be a theatre teacher. This is geared towards high school students considering theatre education as a major and career path. Come prepared with your questions as this is an interactive discussion!</p>  |
| <p><b>1:00 pm-2:10 pm</b><br/><b>2:30 pm-3:40 pm</b><br/>Illini Union 407</p> <p>[T21]</p>    | <p><b>Getting the Job: Resume Creation for Theater</b><br/><b>Daniel Hall, Southern Illinois Univ., Carbondale</b></p> <p>Your resume is one of the most powerful documents you can create as a professional. It's a chance to get your accomplishments and experience all in one place, tailored to any position you may be applying for.</p>   |
| <p><b>1:00 pm-3:30 pm</b><br/>Illini Union Ballroom (2nd Flr)</p> <p>[M16]</p>                | <p><b>Dance for Musical Theatre</b><br/><b>Sarita Smith-Childs &amp; Antonio Houston, Northern Illinois Univ.</b></p> <p>Come learn a musical theatre dance choreography! We will be using basic jazz and contemporary skills to create art through dance!</p>   |
| <p><b>1:00 pm-2:10 pm</b><br/><b>2:30 pm-3:40 pm</b><br/>Illini Union Room A</p> <p>[A30]</p> | <p><b>Finding the Animal in You and Me</b><br/><b>Bebe Marzano, Illinois State Univ.</b></p> <p>Humans aren't too distant from animals. In fact, who's to say humans aren't animals themselves? In this workshop, actors explore the world of animals and learn to connect their behaviors to characters, adding another layer to building characters. This will include lots of movement and an electronic device (i.e. your cell phone) is requested.</p>  |
| <p><b>1:00 pm-2:10 pm</b><br/><b>2:30 pm-3:40 pm</b><br/>Illini Union Room C</p> <p>[A31]</p> | <p><b>Improvising Inside a Script!</b><br/><b>Annie Calhoun, Lewis Univ.</b></p> <p>Have you taken improv classes? Have you done scripted material? Ever wonder how to combine the two and how they influence one another? Professor Calhoun is an expert at using Spolin's Improv Exercises to breathe life into scripted material so that it is more playful, dynamic and present! In addition to Lewis University, she has worked and taught in Los Angeles and done this work alongside well known actors and improvisors—including cast members from Saturday Night Live.</p> |
| <p><b>1:00 pm-3:30 pm</b><br/>KCPA Choral Rehearsal Room</p> <p>[C9]</p>                      | <p><b>Foamsmithing: Introduction to the Basics</b><br/><b>Rose Kaczmarowski, Viana Manova, &amp; Sarah Havens, Univ. of Illinois Urbana-Champaign</b></p> <p>This workshop is focused on introducing people to EVA foam and explaining its uses in cosplay and costuming in general. The session will begin with a short presentation about how to use EVA foam and then participants will be able to try foamsmithing on their own.</p>   |

**A:** Acting & Auditions • **C:** Costuming/Makeup • **D:** Directing/Stage Management • **I:** Instructors/Teachers  
**M:** Movement/Dance/Combat • **P:** Playwriting • **S:** Musical/Vocal • **T:** Technical Theatre • **V:** Improv/Variety



## Saturday Afternoon Workshop Descriptions, continued

|  |  |
|--|--|
| <p><b>1:00 pm-2:10 pm</b><br/> <b>2:30 pm-3:40 pm</b><br/>                     KCPA Ensemble A</p> <p>[M15]</p>              | <p><b>The Storytelling Power of Music</b><br/> <b>Parker Daugherty, Illinois State Univ.</b></p> <p>For this workshop, students will learn about the performance applications of music and how it can help to influence their portrayal of a character. This workshop will also empower those who take part in it to make bolder and clearer movement choices onstage.</p>   |
| <p><b>1:00 pm-2:10 pm</b><br/> <b>2:30 pm-3:40 pm</b><br/>                     KCPA Orchestra Rehearsal Room</p> <p>[V8]</p> | <p><b>Respect, And: Make-em-ups and Taking Up Space</b><br/> <b>Sissy Anne Quaranta, Univ. of Illinois Urbana-Champaign</b></p> <p>Is the point of Improv just to be funny? Do you always have to say "Yes, and" to your scene partner? What actually IS the point of Improv? Through discussion and exercises, lets explore what it means to be a "good" Improvisor.</p>  |
| <p><b>1:00 pm-2:10 pm</b><br/> <b>2:30 pm-3:40 pm</b><br/>                     Natural History Bldg 2020A</p> <p>[A32]</p>   | <p><b>An Actor's Viewpoints - <i>TENTATIVE</i></b><br/> <b>Jimmy Chrismon, Illinois State Univ.</b></p> <p>Acting has a lot to do with movement &amp; perspective, so this workshop will lead participants through Anne Bogart and others' theories of physical viewpoints, and help them isolate their senses to see the room they're sitting in differently, and to notice things they wouldn't have before.</p> |
| <p><b>1:00 pm-2:10 pm</b><br/> <b>2:30 pm-3:40 pm</b><br/>                     Natural History Bldg 2020B</p> <p>[T22]</p>   | <p><b>Hands on Engineering</b><br/> <b>Vincent Lobello, Purdue Univ.</b></p> <p>How do you react to a structural challenge? Build a paper model of Rapunzel's Tower and then compete to see who's tower can stand up to the out-of-control wind effect! Learn about ways engineering is relevant in technical theatre and the possible jobs it can prepare you for.</p>  |
| <p><b>1:00 pm-3:30 pm</b><br/>                     Natural History Bldg 2078</p> <p>[A33]</p>                                | <p><b>MonoBlogs!: Creating an Original Monologue</b><br/> <b>Adam Lewis, Western Illinois Univ.</b></p> <p>So, you can't find a good monologue, huh? How about writing one! This workshop will help you get the ideas rolling. MonoBlogs is an original monologue workshop that will help you create your own, or at least get you started on a good first draft. Budding playwrights and actors welcome!</p>      |
| <p><b>1:00 pm-3:30 pm</b><br/>                     Natural History Bldg 2083</p> <p>[P6]</p>                                 | <p><b>Devising: Hansel and Gretel</b><br/> <b>Leoni Reilly, Univ. of Illinois Urbana-Champaign</b></p> <p>We will be working with movement and playwriting tactics to devise an original work. We will be taking the story of Hansel and Gretel and applying the influence of your favorite artists to make a work of your own in groups of 3-5.</p>   |

**A:** Acting & Auditions • **C:** Costuming/Makeup • **D:** Directing/Stage Management • **I:** Instructors/Teachers  
**M:** Movement/Dance/Combat • **P:** Playwriting • **S:** Musical/Vocal • **T:** Technical Theatre • **V:** Improv/Variety

# Profiles of Schools Presenting Productions

**Antioch Community High School** • *PUFFS OR SEVEN INCREASINGLY EVENTFUL YEARS AT A CERTAIN SCHOOL OF MAGIC AND MAGIC* • The Sequoit Theatre Department is one teacher with a tech director. We have offer four levels of acting courses and two levels of Stagecraft. We put on three performances a year.

**Collinsville High School** • *THE WAR OF THE WORLDS: THE 1938 RADIO SCRIPT* • Collinsville High School is a four-year public high school with approximately 2,000 students enrolled. It is part of the Collinsville Community Unit School District 10 which covers 57 square miles and serves students from Collinsville, Caseyville and Maryville, as well as portions of Glen Carbon, Fairmont City, and Granite City.

**Downers Grove North High School** • *THE BOMB-ITTY OF ERRORS* • DGN Theatre is composed of several factions. We have our curricular classes, extra-curricular productions, drama club, and our Thespian Honors Society. DGN offers three levels of acting courses and two levels of technical theatre. Our production season features five shows throughout the year, and students collaborate with other departments to stage concerts, a variety show, and an Orchesis dance production. Drama club manages all of our social events, workshops, and field trips and organize activities for all of our students. Students gain points towards their Thespian membership and rank by participating in our classes, drama club events, and productions. The skills learned in theatre support each student in their growth and future.

**Fieldcrest High School** • *RADIUM GIRLS* • Fieldcrest High School with 270 students, is a consolidated district located in central Illinois. Located on I39 in Minonk, the school was formed when several small towns came together in 1992. The FHS Drama Department performs a fall play, spring musical and summer drama camp. Theater classes along with dual credit art and music classes are available. Anywhere from 25 to 60 students participate in the productions throughout the year.

**Glenbard East High School** • *MATILDA* • Glenbard East High School has approximately 2255 students. It is located in the west suburbs of Chicago and is in the village of Lombard. The theatre program's Artistic Director is Andy Bero. The program produces 3 main stage productions each year with 6 showcases scheduled for this year and a film festival.

**Hinsdale South High School** • *CARRIE: THE MUSICAL* • Hinsdale South High School is located outside of Chicago in the southwest suburbs of Darien, IL. Our high school has a student body of approximately 1,400 students. The theatre department produces a fall musical and participates in the IHSA Competitive Drama season in the spring. In addition, the Hinsdale South Theatre

program produces a school-wide Variety Show and an annual Improv Show. Hinsdale South is Troupe #878 of the International Thespian Society and has inducted thousands of students in its history.

**Keith Country Day School** • *SORRY, WRONG NUMBER* • Keith Country Day is a small, independent, college-preparatory school housing K-12 students that dedicates itself to preparing children for lives of meaning and purpose. Our Theatre Department for Upper School 9-12 offers both performance and technical classes, 3-5 performance opportunities a year, as well as enrichment field trips to professional and amateur shows in the region.

**Lakes Community High School** • *AS YOU LIKE IT* • Lakes Community High School is a school of just under 1,300 students in Northern Illinois. Eagle Theatre is made up of over 100 student designers, actors, technicians, and production leaders. We produce four main stage productions a year: a fall play, a winter musical and two student produced festivals where students do everything from writing to directing to producing to designing. LCHS offers five different theatre classes: Beginning Theatre, Studio Theatre, Studio Theatre Advanced, Stagecraft, and Stagecraft Advanced. Between the curricular classes and after school productions, our thespians can create a theatre experience that can meet their schedules and interests.

**Lincoln-Way East High School** • *THE THEORY OF RELATIVITY* • Lincoln-Way East High School is located in Frankfort, IL and is the home of the Griffins. There are about 2,700 students at LW East. Our theatre program produces two plays and two musicals annually, and provides year-round extra-curricular opportunities for actors, technicians, and musicians.

**Maine East High School** • *THE PLAY THAT GOES WRONG: HIGH SCHOOL EDITION* • Maine East HS is located in Park Ridge, IL a suburb of Chicago. The school has an enrollment of 1800 students and an extremely diverse population. Our students speak over 60 languages in their homes. The Drama Department produces 3 Mainstage and 2 Studio productions each year. There is a 4-year acting curriculum and a repeatable technical theatre course. Currently we have over 100 students participating in our cast, crew, and pit.

**Saint Ignatius College Prep** • *THE ADDAMS FAMILY* • The Saint Ignatius College Prep Harlequins have been in existence for over a century. Each year, the group presents a musical, a play, a series of Student-Directed One Acts and a 24 Hour Plays event. The group prides itself on building empathy and exposing the world to diverse humanistic themes through theatre.

**Tinley Park High School** • *ALICE IN WONDERLAND* • Our school is definitely an athletic-driven facility. We do not have our own stage; we share our theater with our TPHS

## Profiles of Schools Presenting Productions, continued

community for meetings as well as classes; in the spring we share with athletics as our spring musical is in the gym. Yet we have such talented groups of students and community support for what they are able to accomplish. Our administration is supportive of the Drama Club and would pay for additional costs we may incur in order to perform at the Illinois State High School Theater Festival.

**Warren Township High School • *BAD SEED* •** Warren Township High School is a four-year high school with an enrollment of 3900 students. Our Theatre Department is comprised of over 100 students who are engaged in the crew and cast as well as our drama club. Every year, students produce five shows: Fall Main Stage, Dinner Theatre, Short Film, Spring Musical, and the Children's Show. Additionally, our students participate in Shakespeare

Slam annually. Finally, juniors and seniors have the opportunity to audition for our comedy/improv troupe, Giggles n' Bits. Two directors (plus a music director for musical) lead this program in collaboration with a drama council (student leadership). Our drama club holds monthly meetings in conjunction with service opportunities and field trips.

**Wauconda High School • *SPAMALOT* •** The WHS Theatre Dept. produces 1 full length show and 1 full length musical each year. Additionally, the program is part of the Comedy Sportz High School League. Spamalot features the work of over 100 students in cast crew in pit. All students who auditioned or were interested in being part of the show were allowed with no cuts.

## Workshops Recommended for Teachers and Sponsors

All workshops are valuable and available to teachers and students. However, the following workshops may be especially relevant to teachers.

### Friday

| <b>8:00 am-5:00 pm</b>                | <b>Hospitality Room for Teachers/Sponsors</b>  | <b>KCPA Krannert Room</b>        |
|---------------------------------------|--|----------------------------------|
| 9:00 am-10:10 am<br>10:30 am-11:40 am | Consent Based Classrooms (J. Steinrock)  | Illini Union 405                 |
| 9:00 am-11:40 am                      | Evoke, Provoke, Disrupt: Verbatim Performance in Your Classroom (B. Kenyon)  | KCPA Studio 1                    |
| 12:00 pm-1:10 pm<br>1:30 pm-2:40 pm   | Picking A Master's Program: The Theatre Conservatory at Roosevelt University's MA in Theatre Directing (K. Mackie) | Gregory Hall 113                 |
| 12:00 pm-1:10 pm<br>1:30 pm-2:40 pm   | Working with Student Stage Managers: A Guide for Teachers and Directors (T. Ciofalo)                               | Gregory Hall 215                 |
| 12:00 pm-2:30 pm                      | Building Your Own Play (A. Rosenblat)  | Illini Union 406                 |
| 12:00 pm-1:10 pm                      | Taking a Show on the Road (L. Wilson)  | KCPA Drama Rehearsal Room        |
| 1:30 pm-2:40 pm                       | Boosting Your Thespian Troupe (L. Wilson)  | KCPA Drama Rehearsal Room        |
| 3:00 pm-4:10 pm<br>4:30 pm-5:40 pm    | IHSA Answers for you! (M. Begovich)  | Gregory Hall 113                 |
| 3:00 pm-4:10 pm<br>4:30 pm-5:40 pm    | I Teach or Will Teach Theater, What the Heck Do I Do? (A. Rosenblat)   | Illini Union 406                 |
| 3:00 pm-4:10 pm<br>4:30 pm-5:40 pm    | Technical Theatre and Curricular Development (D. Taylor)   | KCPA Drama Rehearsal Room        |
| 9:00 am-10:10 am<br>10:30 am-11:40 am | Engaging LGBTQ+ Youth Experiences Onstage (A. Waldron)   | Natural History Bldg 2079        |
| <b>10:00 pm-11:30 pm</b>              | <b>Sponsors' Reception</b>   | <b>Illini Union South Lounge</b> |

## Saturday

|  |   |                    |
|--|---|--------------------|
| <b>9:00 am-5:00 pm</b>                 | <b>Hospitality Room for Teachers/Sponsors</b>   | KCPA Krannert Room |
| 10:00 am-11:10 am<br>11:30 am-12:40 pm | Welcome to the Jungle: Personalities in Your Classroom, Theatre Program, and Beyond (W. Skym)   | Gregory Hall 111   |
| 10:00 am-11:10 am<br>11:30 am-12:40 pm | Connected Arts Network- Connecting DEI, SEL, and Standards to Enrich Your Classroom (J. Ludtke) | Illini Union 211   |
| 1:00 pm-2:10 pm<br>2:30 pm-3:40 pm     | Debuting a World Premiere with Teatro Leyden (F. Bavone)  | Gregory Hall 111   |
| 1:00 pm-2:10 pm<br>2:30 pm-3:40 pm     | Consent Based Classrooms (J. Steinrock)   | Illini Union 403   |

## Hospitality Room

### Sponsored by On the Stage

In addition to the recommended workshops, come to the Hospitality Room in the Krannert Room on Lobby Level 5. It is a great place to grab some refreshments, network, and charge your device. Also, please attend the Sponsors' Reception Friday evening, 10:00-11:30 pm in the Illini Union South Lounge (Main Level).



### Roundtables in the Hospitality Room (Krannert Room)

Join us for one or more "roundtable" discussions.

## Friday

### New Sponsors Meet and Greet

#### 10:00 am-11:00 am

Welcoming all new theatre fest sponsors and chaperones to a meet and greet! Come down to gather some tips and tricks on all things festival, building a strong network of connected theatre teachers and ways to branch out and build your theatre teacher expertise.

This roundtable will be focused on making connections of support for our newest members, future planning for joining a committee, bringing a show, & College Auditions.

### Lending and Sharing Production Materials

#### 11:30 am-12:30 pm

Ever find yourself in need of that one set item? Maybe it's the wicker wheelchair, or perhaps it's the dentist chair for Little Shop? Or what about that ONE prop that takes up prime real estate in your storage that you just can't let yourself get rid of? For this roundtable, we'll be introducing the idea of a state-wide theatre resource database. Find out which schools near you have that dog house for Snoopy, or the SECOND piano for Little Women. Be a part of helping us build this database of shared resources!

### Best Lesson Plan Share

#### 3:00 pm-4:00 pm

Do you find yourself uninspired in the cold winter months? As theatre teachers we know what it's like to find yourself scrambling for new ideas. Join us for a chance to collaborate with other theatre educators on the best (and worst) lesson plan resources, different ways to tackle common problems, and your go-to tips and tricks for the drama classroom!

## Saturday

### So You've Got a Kid in All-State...

#### 10:00 am-11:00 am

If you've ever dreamed of watching your kid walk up onstage to receive a Tony Award®, seeing them perform at All-State is the next best thing! Come down to chat with other proud theatre teachers about how best to prepare your students (and yourself) for next year's all-state auditions. Covering bases like monetary funds, travel commitments, where to find information, and even how to ask administration for sponsorship and support, this roundtable discussion will have it all!

## CPDU Information

CPDU forms will be available at the ITA registration table throughout the duration of the Festival. For further information on CPDUs, please contact:

Carmel DeStefano, President  
Illinois Theatre Association  
4055 W. Peterson Ave., Suite 105  
Chicago, IL 60646  
Phone: 773-804-8975  
Email: info@illinoistheatre.org

# Acknowledgments

We wish to acknowledge the following people and organizations for their contributions to the 2023 Illinois High School Theatre Festival. Without their generosity and hard work, the Festival would not be possible.

## **The Aldridge Family**

**Allan Kimball**

**All-State Company of *Shrek the Musical***

**All-State Interns**

**All-State Parents and Guardians**

**The Bayer Family**

**Champaign Centennial High School**

**Drama Department**

**Champaign Centennial High School**

**Football**

**Champaign Central High School**

**Drama Department**

**Champaign County CVB**

Jayne DeLuce

Mike Koon

**Champaign Park District**

**Coal City High School**

**Downers Grove South High School**

**Eastland Suites Urbana**

**Farmington Central School**

**District 265**

Dr. Zac Chatterton, Superintendent

Mr. Jeff Otto, Activities Director

Mr. Dennis McMillin, Principal

FCFS Theatre Department, Music

Boosters, Athletic Boosters,

Harvest Team

**Hoffman Estates High School**

**Illinois Arts Council**

**Illinois State Board of Education**

**Illinois State University**

Terri Goss Kinzy, President

Jimmy Chrismon, Asst. Prof. of

Theatre Teacher Education,

School of Theatre and Dance

**Illinois Thespian Society**

**Illinois Theatre Association, 2022-**

**2023 Board of Directors**

Carmel DeStefano, President

Dennis Anastasopoulos, Treasurer

& All-State Liaison

**Jennifer Heim Photography**

**Joe Ruffolo, West Leyden Student**

**Activities Director**

**Joe Serio**

**Judy Klingner**

## **Krannert Center for the Performing Arts**

Lisa Lillig

Lou Williams

Seth Wheeler

Ryan Schultz

Mike Ross, Director

## **Leyden 212 Transportation**

**Department**

## **Oak Park and River Forest High School District 200**

Dr. Gregory Johnson,

Superintendent

Mr. Christopher Scholtens,

Technical Director

OPRFHS Theatre Department

## **On The Stage**

**Paul Dombrowski**

**Protolight**

**Rhonda Paxton and Marci Fletcher**

**Small Town Theatrical**

**Steve McQueen and Larry Williams**

**Tracy Nunnally**

## **University of Illinois**

**Urbana-Champaign**

Robert Jones, Chancellor

William Bernhard, Vice Chancellor  
for Academic Affairs and Provost  
Designate

Kevin Hamilton, Dean of College  
of Fine & Applied Arts

Valleri Robinson, Head,  
Department of Theatre

J.W. Morrissette, Associate Head,  
Department of Theatre

## **Urbana High School Drama Department**

**USITT**

**Upstaging**

**Vertigo**

**Vic Pillola**

- Adult Supporters who volunteered to assist with the All-State Production.
- College student volunteers who served as monitors, ushers, house managers, and in other capacities, who have given their time and efforts to help this Festival run smoothly.

- All of our friends and families for their support
- And anyone else who we might have missed who assisted with the Festival after this program was prepared.

Thank you for your years of service and support!

*–The participants of the Illinois High School Theatre Festival*

## **Extraordinary Contributions to the Festival**

The Illinois High School Theatre Festival created the Extraordinary Contributions to the Festival Award to honor individuals who have given significant and consistent support to the Festival throughout the years through their time, effort, skills, and resources. This year's award honors:

**Carmel DeStefano**

**Reavis High School (retired)**

**Dennis Anastasopoulos**

**Reavis High School**

## **Administrator Support Award**

The Illinois High School Theatre Festival Administrator Support Award was established to honor those academic leaders who have bolstered our programs and recognize the inherent values and qualities the arts possess. This year's award honors:

**Mary McCarthy**

**Victor J. Andrew High School**

## **Legacy Award**

The Legacy Award is given to a supporter of the Festival who has left a lasting impact throughout their career. This is the first year this award has been given.

**Suzanne Aldridge**

**Champaign Centennial High School (retired)**





# Illinois Theatre Association's Corporate Sponsors



*Thank you for your valuable contributions!*

# Outside of Ordinary

**When thousands of  
thespians showcase  
their tremendous  
talent on our stages.**

We're thrilled to welcome you to  
our Outside of Ordinary community.

Thank you for sharing your talent with us.

visit **champaign** county





UNIVERSITY OF ILLINOIS AT URBANA-CHAMPAIGN  
**ILLINOIS** THEATRE



**JOIN US FOR YOUR BFA AND  
MAKE THEATRE THAT MATTERS!**

We offer a BFA in Acting, Arts and Entertainment Technology, Costume Design and Technology, Lighting Design and Technology, Scenic Design, Scenic Technology, Sound Design and Technology, Stage Management, and Theatre Studies (Playwriting, Directing, and Dramaturgy).

Our alumni are working as company managers and theatre managers, theme park designers, Broadway stage managers, comic writers and illustrators, professional designers, educators, playwrights and screenwriters, and actors on stage and in film and television.



**College of Fine &  
Applied Arts**

UNIVERSITY OF ILLINOIS URBANA-CHAMPAIGN

[theatre@illinois.edu](mailto:theatre@illinois.edu)  
217.244.6189



## **PURSUE YOUR PASSION** at Carthage College.



Carthage College is the perfect place for you to embrace, enhance, and develop your talents. Whether you prefer to perform on stage or to stretch your creative muscles "behind the scenes," our award-winning theatre program can teach you the skills you need to reach your full potential!

**14 Awards from the Kennedy Center American College Theatre Festival since 2015**

### **FEBRUARY 2023 AUDITION DATES**

Saturday, Feb. 11, 2023

Friday, Feb. 17, 2023 (virtual only)

Saturday, Feb. 18, 2023

Saturday, Feb. 25, 2023

### **CARTHAGE.EDU/THEATRE**

Majors in:

Theatre • Theatre Performance • Theatre Education (K-12)  
Costume Design • Scenic Design • Stage Management  
Music Theatre Emphasis • Directing Emphasis  
Theatre Minor • Music Theatre Minor  
Dance Minor • Costume Design Minor



**CARTHAGE**  
COLLEGE



# Department of Theatre and Dance

*Surround yourself with people  
who recognize and develop your talent.*



*Hair 2018*

**Personalized Undergraduate  
Theatre Training with**

**Emphasis in:**

- Acting
- Directing
- Musical Theatre
- Costume Design
- Makeup Design
- Scenic Design
- Lighting Design
- Sound Design
- Technical Direction
- Stage Management
- Arts Administration
- General Theatre Studies
- Dance (Minor)



**Experience:**

- An Undergraduate Theatre Program that is Focused on You the Student/Artist
- A Close Working Relationship with Faculty who Care
- Gaining Theatrical Skills and Building Your Portfolio with Hands-on Assignments on Three Productions each Semester
- Respect as an Artist and Creator
- The Opportunity to Connect and Work with Theatre Professionals from Around the World





**NORTHERN MICHIGAN UNIVERSITY**  
SCHOOL OF MUSIC, THEATRE, & DANCE

STUDY  
*Theatre & Dance*  
at  
NORTHERN MICHIGAN  
UNIVERSITY





*Degree Programs:*

THEATRE & ENTERTAINMENT ARTS  
**ACTING DANCE**  
THEATRE TECHNOLOGY & DESIGN  
MUSICAL THEATRE



For information on Auditions & Scholarships,  
please visit our website by scanning the QR code.

 NMU Theatre and Dance

 @nmu.theatre.and.dance

 nmugd@nmu.edu

Website: <https://nmu.edu/theatreanddance/>



# Illinois State University

CREATE  
YOUR  
LEGACY



For more information



SCHOOL OF  
**THEATRE AND DANCE**  
*Illinois State University*





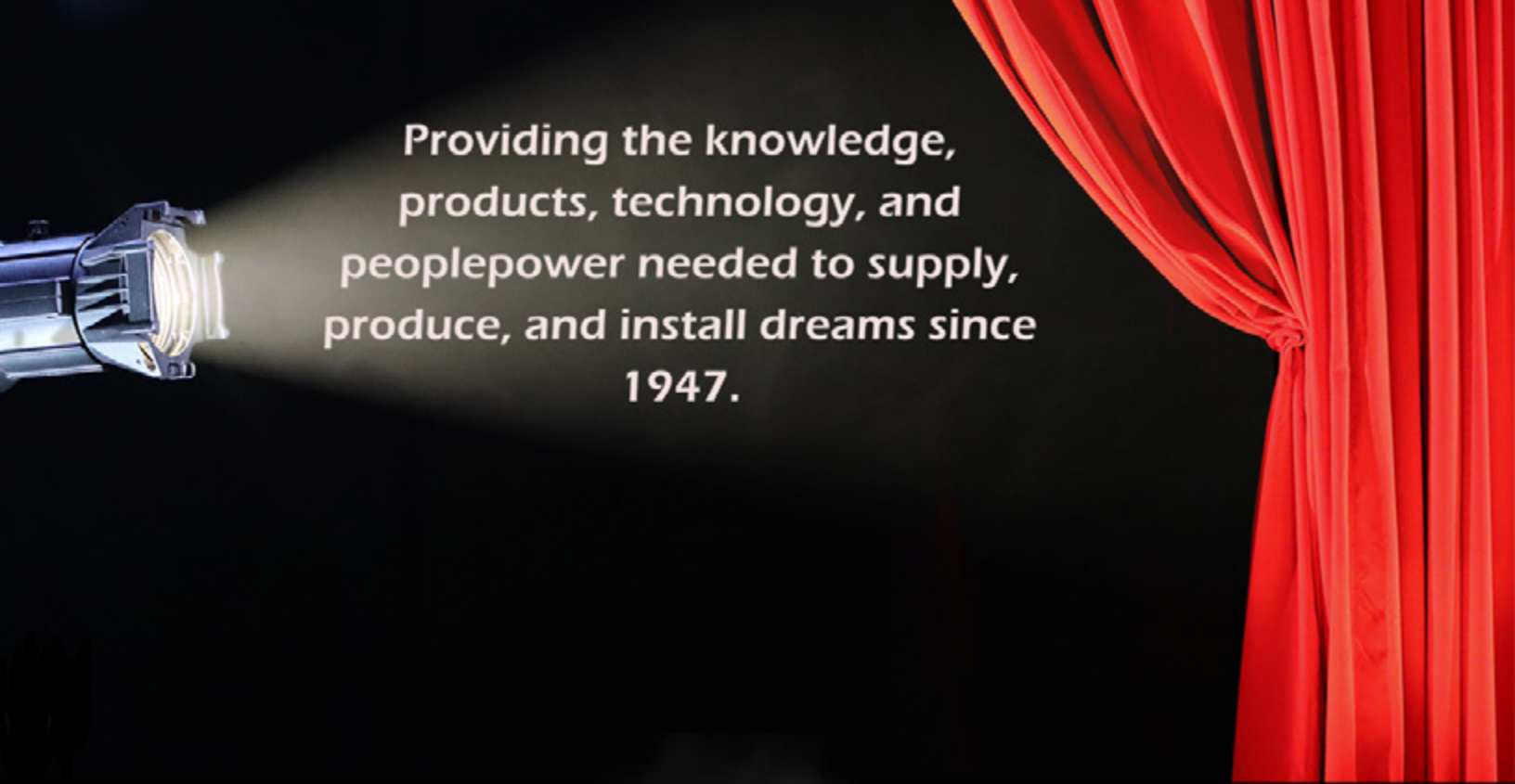

Providing the knowledge,  
products, technology, and  
peoplepower needed to supply,  
produce, and install dreams since  
1947.



# GRAND STAGE

*Creative Tools for Creative People*





## **Spectacular Flying Effects Since 1991**

Vertigo provides spectacular performer flying effects from manual to fully automated for your theatrical production.

[getvertigo.com](http://getvertigo.com)

**vertigo** 





# Protolight

Your complete theatre  
technology partner!



[www.protolight.com](http://www.protolight.com)  
[sales@protolight.com](mailto:sales@protolight.com)  
847.859.5000



# THE NEW YORK CONSERVATORY FOR DRAMATIC ARTS



LEARN MORE



**NEW MEDIA**



**FILM & TV**



**MUSICAL  
THEATRE**

Turn your dreams into a professional career.

Scholarships and Financial Aid Available!

Start our training programs in September, January or June.

Summer Intensive Programs every June or July start.

[www.nycda.edu](http://www.nycda.edu)



**IOWA**

**WHY IOWA?**

**400+**

ARTS PERFORMANCES AVAILABLE EACH YEAR TO STUDENTS FOR \$5 OR LESS

**#4**

BEST COLLEGE TOWN  
American Institute for Economic Research

**100+**

RESTAURANTS, CAFÉS, MUSIC VENUES, THEATERS, AND STREET FESTIVALS

**112%**

IOWA CITY RECEIVED A PERFECT SCORE FROM THE HUMAN RIGHTS CAMPAIGN – PLUS EXTRA POINTS! – FOR LGBTQ+ EQUALITY.

**DEPARTMENT OF THEATRE ARTS**

MFA in Acting, Design, Directing, Dramaturgy, Playwriting, or Stage Management

BA in Theatre Arts

→ [THEATRE.UIOWA.EDU](http://THEATRE.UIOWA.EDU)



CONNECT WITH US on social media @uiowatheatre

Join our award winning program!

[wiu.edu/theatre](http://wiu.edu/theatre)

[TL-Killian@wiu.edu](mailto:TL-Killian@wiu.edu)



**Western Illinois University**  
*Department of Theatre & Dance*





THE  
UNIVERSITY  
OF ILLINOIS  
AT CHICAGO

# /THEATRE&MUSIC



BFA Acting  
BA Theatre & Performance  
BA Theatre Design,  
Production & Technology

You have big plans.  
we'll help make them real.

Visit us: [theatreandmusic.uic.edu](http://theatreandmusic.uic.edu)  
312.996.3991

## PARKLAND COLLEGE THEATRE ARTS

PURSUE YOUR PASSION • FIND YOUR TALENT • START YOUR CAREER



A.A. in Theatre Arts

A.A.S. in Theatre Arts: Entertainment Technology

Certificate in Theatre Arts: Entertainment Technology

[parkland.edu/theatrearts](http://parkland.edu/theatrearts)  
217/351-2392



## Make Theatre Make a Difference



COLLEGE OF CREATIVE ARTS  
Department of Theatre

### DEGREE PROGRAMS

*Bachelor of Arts in Theatre*

### AREAS OF STUDY

Acting  
Directing  
Musical Theatre  
Stage, Costume, Lighting,  
and Sound Design  
Technology  
Stage Management  
Theatre for Social Change

### MINORS

Arts Management  
Dance  
Music Theatre  
Theatre Arts

### CO-MAJORS

Fashion  
Arts Management  
Art Therapy



# LYRIC THEATRE @ ILLINOIS SCHOOL OF MUSIC

Comprehensive training for the singing actor.

*Flexibility, Creativity, Wellness*

BMA in Lyric Theatre  
 BM in Voice  
 MM and DMA in Performance and Literature

music.illinois.edu | musicadmissions@illinois.edu



**I** College of Fine & Applied Arts  
UNIVERSITY OF ILLINOIS URBANA-CHAMPAIGN

## Powerhouse Theater Training Program at Vassar College



June 22-July 30, 2023  
[vassar.edu/powerhouse/training-program](http://vassar.edu/powerhouse/training-program)

## UW-Stevens Point 2023 THEATRE AUDITIONS



**DISCOVER YOUR PURPOSE**

BFA Acting, BFA Musical Theatre, BFA Theatre Design and Technology, BA Drama

**FEBRUARY 17, 2023**  
**MARCH 4, 2023**

Visit <https://app.getacceptd.com/uwsp> to complete your artistic application today!  
 Materials are due one week prior to audition date.

 Department of Theatre & Dance  
 School of Performing Arts  
 University of Wisconsin-Stevens Point





AGES  
3 + UP

# THEATER MUSIC DANCE

- 50+ classes
- 12:1 student-teacher ratio
- Scholarships available

SPRING ENROLLMENT BEGINS NOV. 7TH



PARAMOUNT  
SCHOOL OF THE ARTS



SCAN TO  
LEARN MORE!

paramountschool.com // 20 South Stolp Avenue, Downtown Aurora // 630.896.6810



## Discover an all-in-one technology platform built for performing arts

- ✓ Ticketing and Box Office Tools
- ✓ Marketing and Promotions
- ✓ Fundraising
- ✓ Merchandise
- ✓ And more!

Lorem ipsum

Learn more at [onthestage.com](http://onthestage.com)









# Plan Your Festival Schedule

Use the form below to help plan out your schedule.

Name \_\_\_\_\_ School \_\_\_\_\_

| Friday   | Event Time          | Event                    | Location |
|----------|---------------------|--------------------------|----------|
|          | 9:00 am             |                          |          |
|          | 10:30 am            |                          |          |
|          | 12:00 pm            |                          |          |
|          | 1:30 pm             |                          |          |
|          | 3:00 pm             |                          |          |
|          | 4:00-5:00 pm        | <i>exhibit expo hour</i> |          |
|          | 4:30 pm             |                          |          |
|          | Early Evening       | <i>dinner</i>            |          |
|          | Evening Performance |                          |          |
|          | 10:00 pm            |                          |          |
| Saturday | Event Time          | Event                    | Location |
|          | 10:00 am            |                          |          |
|          | 11:30 am            |                          |          |
|          | 1:00 pm             |                          |          |
|          | 2:30 pm             |                          |          |

The All-State Production of **SHREK THE MUSICAL** is being performed on Thursday 7:30 pm, Friday 2:30 pm and 7:30 pm, and Saturday 9:30 am and 2:00 pm. Please note the performance to which your school has been assigned.

# Illini Union Maps

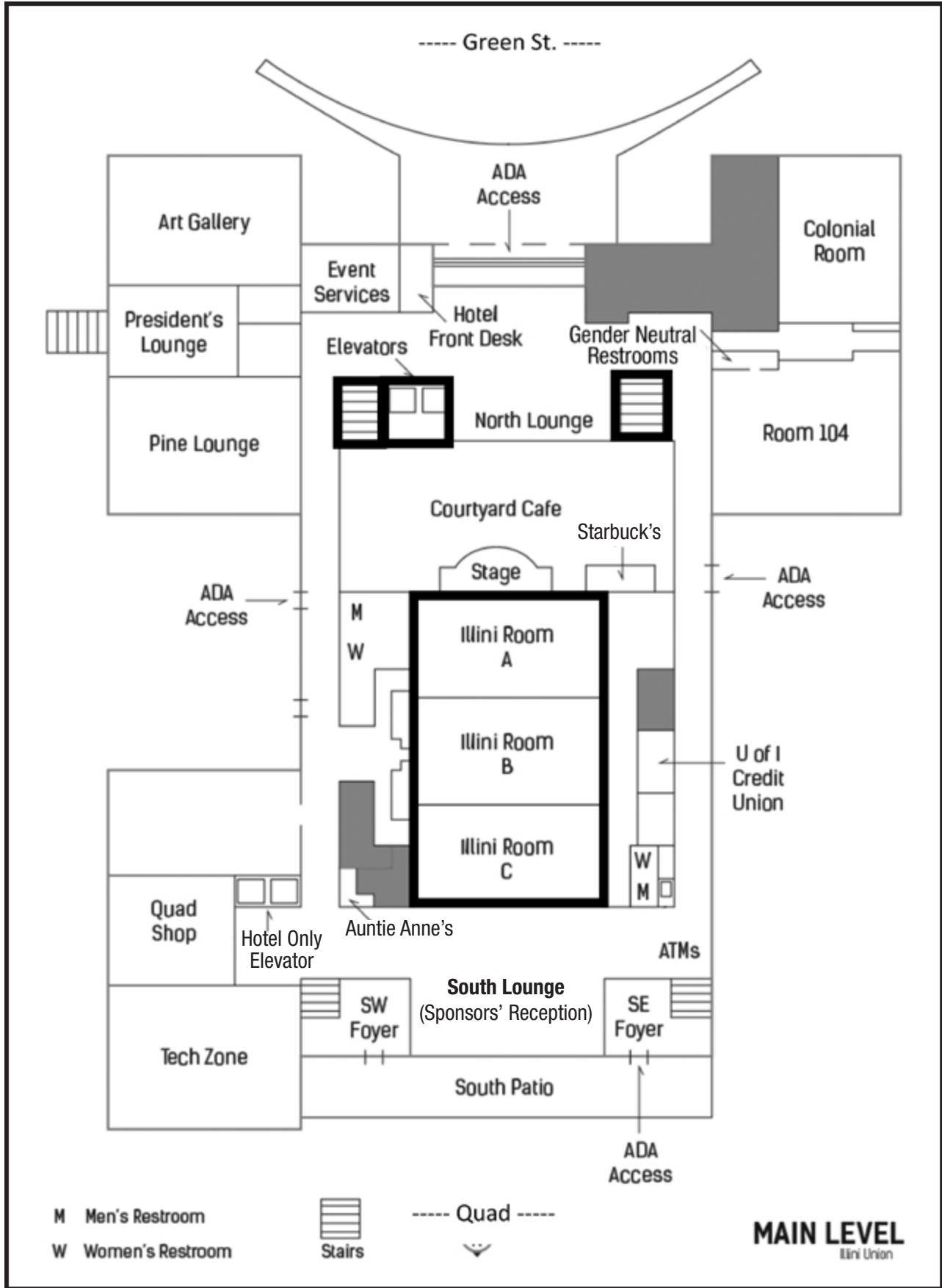

Use the north (Green St. side) stairs and elevators to access Floors 2-4.  
 The north & south ends of the Illini Union are not connected on Floors 2-4.

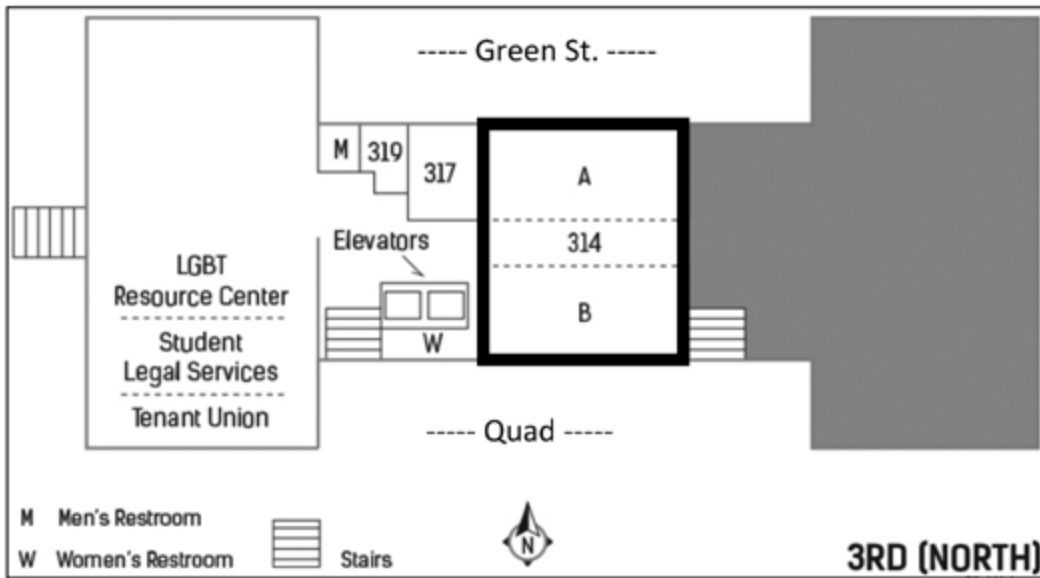
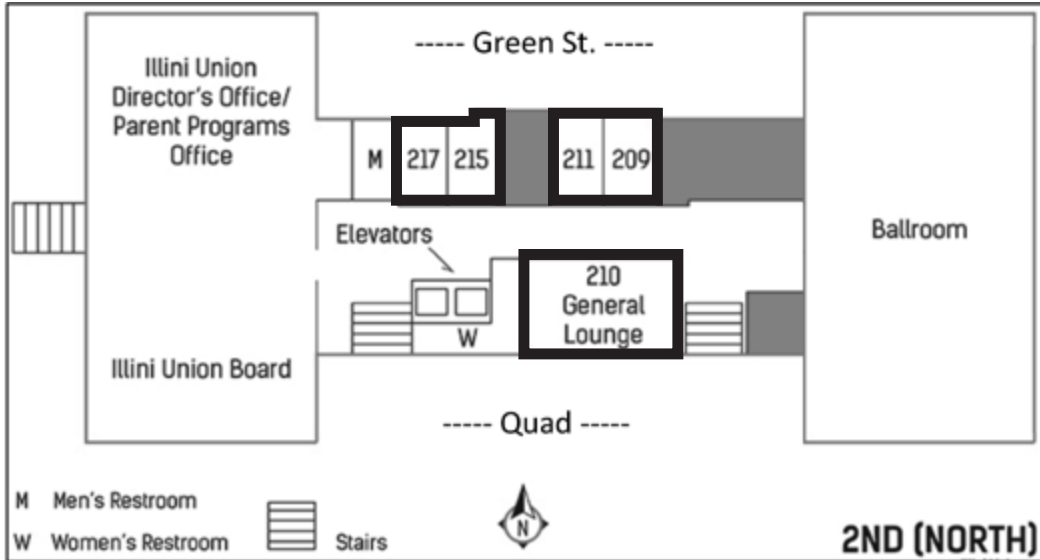



# Krannert Center for the Performing Arts Maps

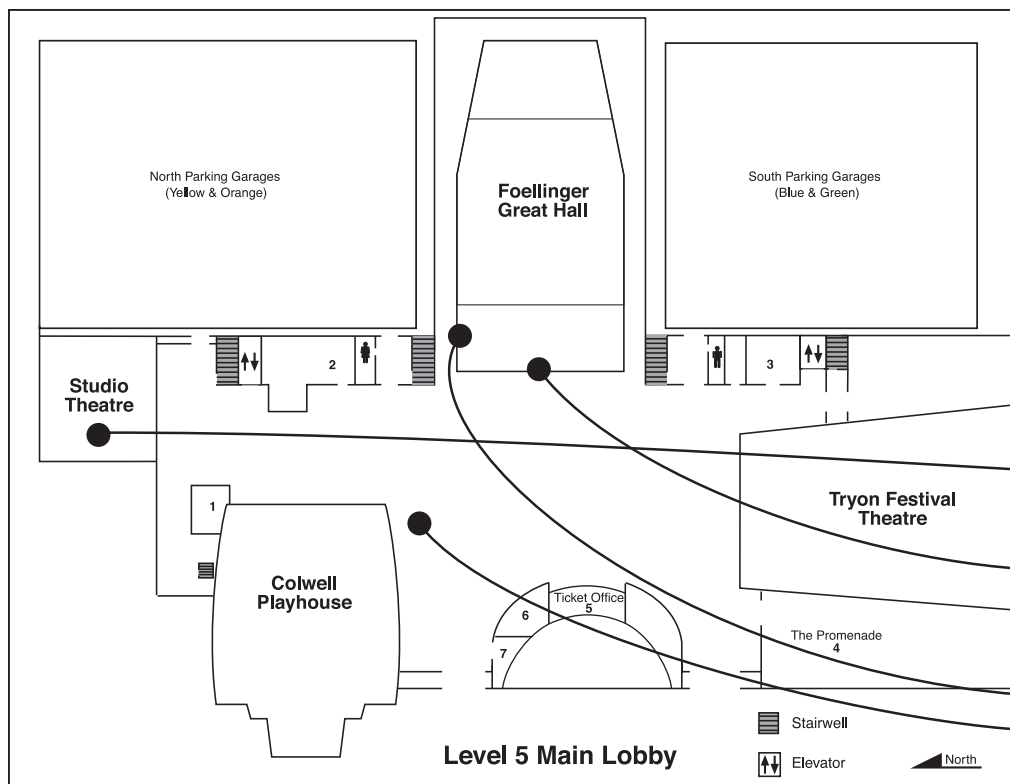

## Level 5—Main Lobby

1. Intermezzo Café
2. Director's Office Suite
- 3. Krannert Room**
4. The Promenade Gift Shop
5. Ticket Office
6. Patron Services Office
7. Coat Check, **First Aid**

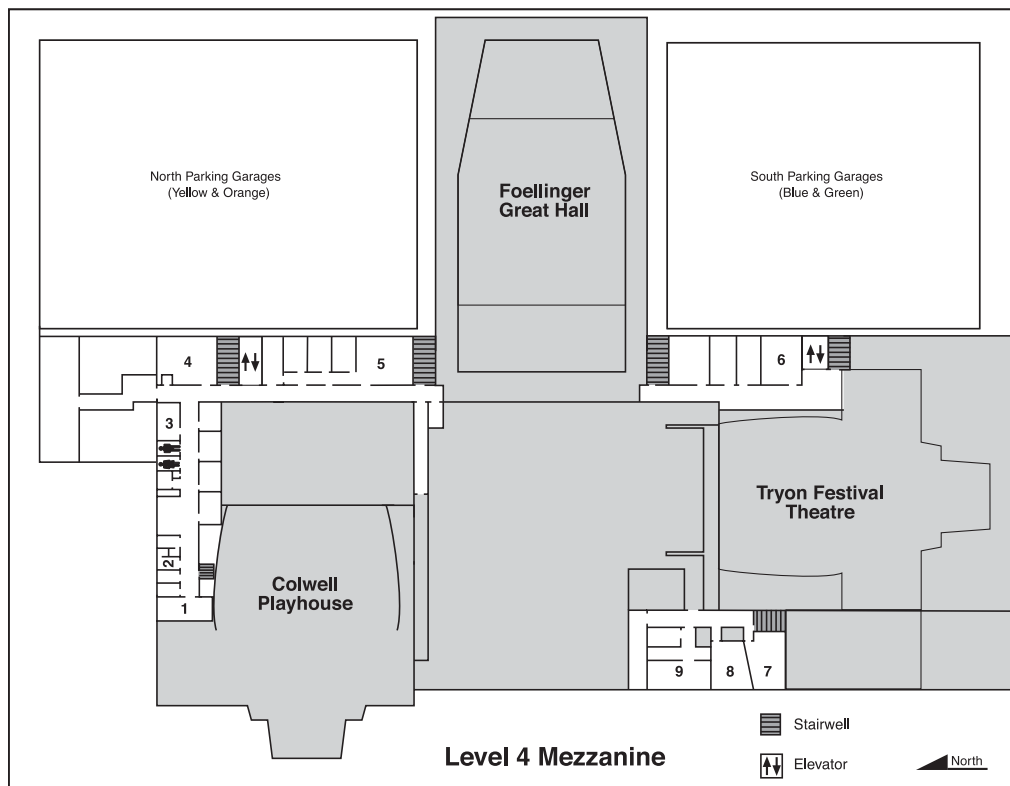
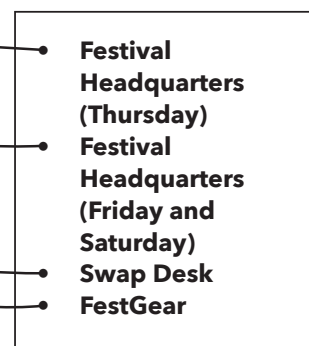

## Level 4—Mezzanine

- 1. Design Studio**
- 3. CAD Lab**
- 4. Drafting Studio**
5. Theatre Department Offices
- 7. Ensemble A**
- 8. Ensemble B**

**Gender neutral restrooms are located in all elevator vestibules and on Level 4 down the hall from the Theatre Dept. Offices.**

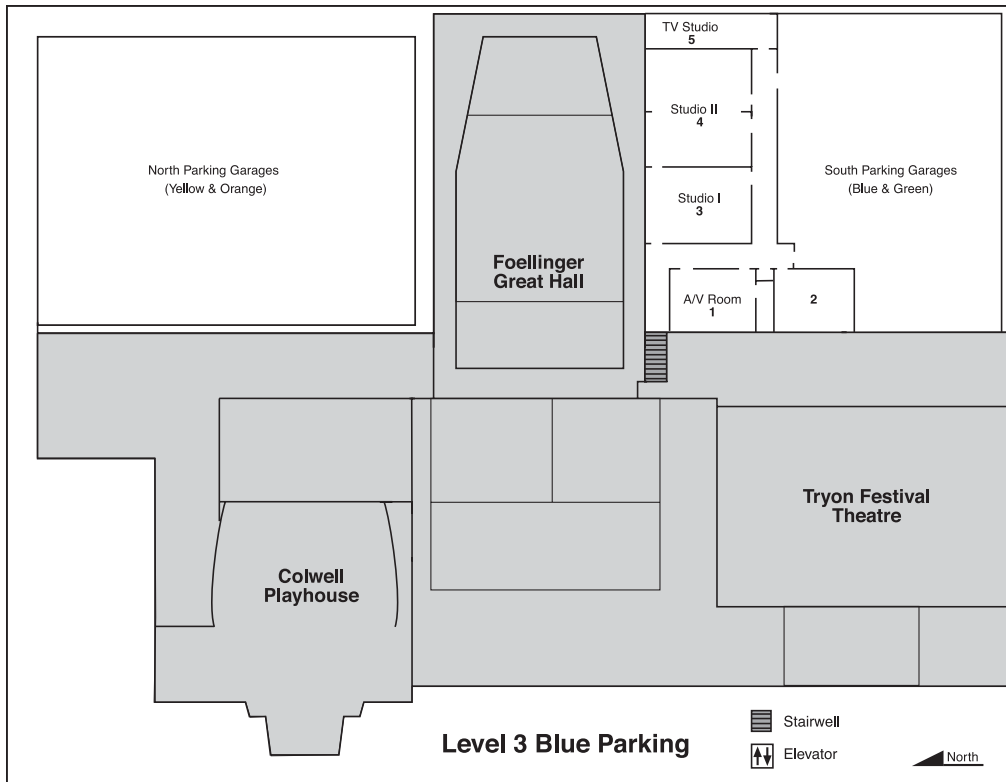

## Level 3–Blue Parking Garage

1. **A/V Room**
3. **Studio 1**
4. **Studio 2**
5. Room 3-607 (aka Media Design Lab/TV Studio)

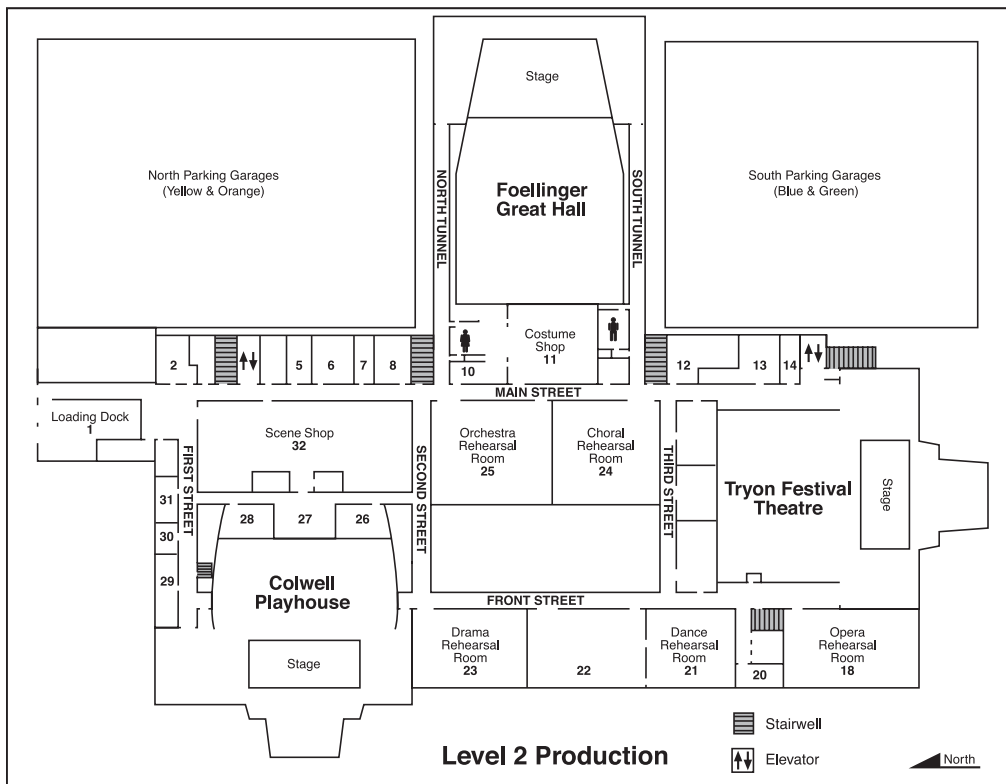

## Level 2–Production

1. **Loading Dock**
6. **Prop Shop**
7. Upholstery Shop
8. Production Office
11. **Costume Shop**
12. Audio Office
13. Events Office
14. Lighting Office
18. **Opera Rehearsal Room**
21. **Dance Rehearsal Room**
23. **Drama Rehearsal Room**
24. **Choral Rehearsal Room**
25. **Orchestra Rehearsal Room**
26. Playhouse Men's Dressing Room
27. Playhouse Green Room
28. Playhouse Women's Dressing Room
29. **Studio Men's Dressing Room**
31. **Studio Women's Dressing Room**
32. **Scene Shop**

Please join us for the  
**48th Annual Illinois High School Theatre Festival**  
January 11-13, 2024 at Illinois State University.

We Shine Brighter  
**TOGETHER**

**Hector J. Hernandez, Jr.**, IHSTF Executive Director  
Larsen Middle School  
hectorhernandez@u-46.org

---

*Announcing the 2024 All-State Production*



**Nathaniel Haywood**, Director, Downers Grove South High School  
**Jessica Lim**, Producer, Wheaton North High School  
**David Morrison**, Producer, Bolingbrook High School

**For more information,**  
please attend one of the **2024 All-State workshops:**  
**Friday 9:00 am-10:10 am & 10:30 am-11:40 am**  
in the KCPA Drama Rehearsal Room.

## Commonly Used Acronyms

- IHSTF:** Illinois High School Theatre Festival  
**ITA:** Illinois Theatre Association  
**KCPA:** Krannert Center for the Performing Arts  
**FGH:** Foellinger Great Hall (in KCPA)  
**TFT:** Tryon Festival Theatre  
**CPH:** Colwell Playhouse  
**STH:** Studio Theatre  
**NHB:** Natural History Building  
**CPDU:** Continuing Professional Development Unit  
**UIUC:** University of Illinois Urbana-Champaign  
**C-U:** Champaign-Urbana  
**ISU:** Illinois State University

## Category Codes

- A:** Acting & Auditions  
**C:** Costuming/Makeup  
**D:** Directing/Stage Management  
**I:** Instructors/Teachers  
**M:** Movement/Dance/Combat  
**P:** Playwriting  
**S:** Musical/Vocal  
**T:** Technical Theatre  
**V:** Improv/Variety



## We Have Our Own App!

Go to the Apple App Store or Google Play Store and search for "Illinois High School Theatre Festival" to download the app today.



Don't forget to complete the online survey at <https://illinoistheatrefest.org>

## Find the Festival on:



[instagram.com/ihstf](https://www.instagram.com/ihstf)



[facebook.com/  
IllinoisHighSchoolTheatreFestival](https://www.facebook.com/IllinoisHighSchoolTheatreFestival)

